

6328 Gaius equipment cabinet

The white moisture resistant frame, made of 16 mm melamine, ensures longevity in active use. The door is made of high-pressure laminate with additional grey accent strips along the edges to promote spatial recognition. The orientation of the door is changeable. The cabinet can be customized to include a lock hole, suitable for an Abloy- or cabinet lock. Such modification requires identification of preferred door orientation with order.

The Gaius utility cabinet (6328) consists of

- one high door with grey accent strips
- three shelves

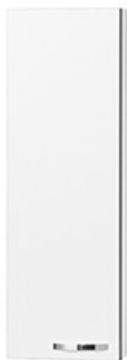

Product Information

Width	300 mm	Color	white
Length	-	Rail color	-
Height	900 mm	Material	-
Depth	135 mm	Handedness	both

6328

GAIUS - TARVIKEKAAPPI
KORKEA OVI
oikea/vasenkätinen



ylhäältä



vaakaleikkaus



pystyleikkaus

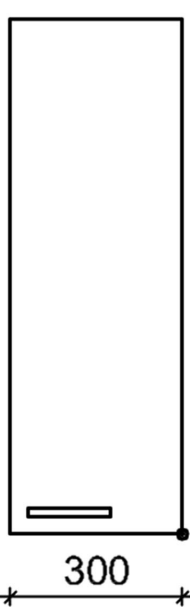

edestä

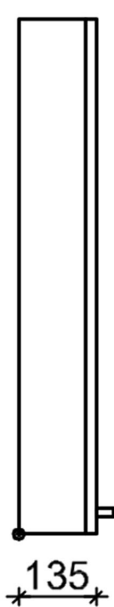

vasen pääty

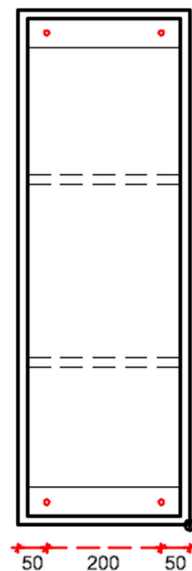
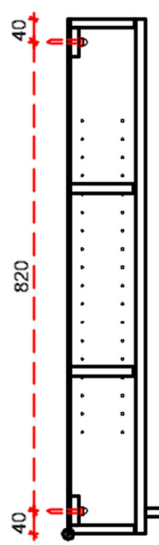

edestä
ilman ovia

