



Installation interfaces

ROPOX KITCHEN PRODUCTS

KORPINEN

Contents

- CONTENTS 2
- ROPOX DIAGONAL 3
- ROPOX VERTI ELECTRIC 4
- ROPOX VERTI-INSIDE 6
- ROPOX BRACKETS 8
- ROPOX BRACKETS 9
- ROPOX FLEXIBASIC 10
- ROPOX FLEXIBASIC 11
- ROPOX FLEXIMANUAL 12
- ROPOX FLEXIMANUAL 13
- ROPOX FLEXIELECTRIC 14
- ROPOX FLEXIELECTRIC 15
- ROPOX FLEXICORNER 16



The dimension sketches are intended as a guidance only. For final dimensioned drawing, always refer to plan drawing of the specific product. This document is used for planning of building projects.

Ropox Diagonal

Cabinet width 40-180 cm (30-40904 to 30-40918)

 **Assumptions for schematic diagram:**
Cabinet height = **704 mm** – (for other cabinet heights the dimension sketch will be changed accordingly)

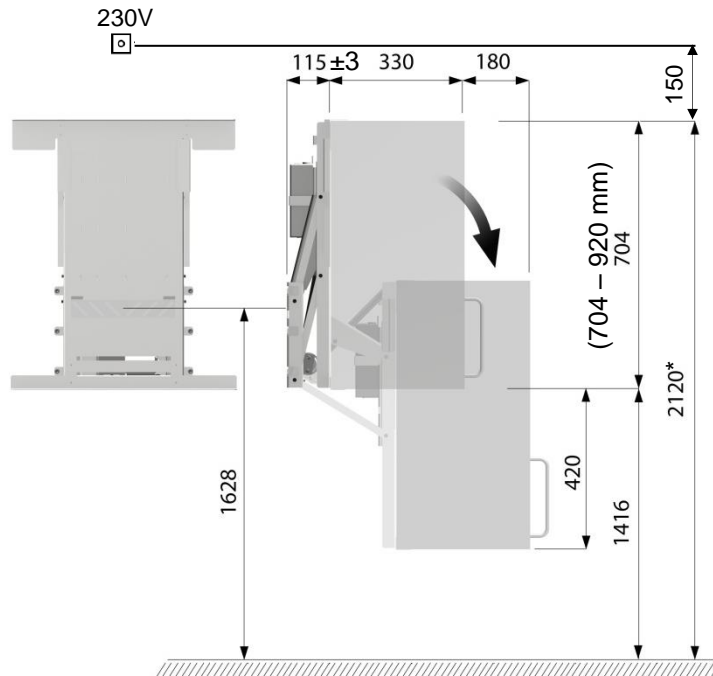

(The frame is designed for cabinet heights from 704-920 mm.)

Height upper edge of wall cabinet = **2120 mm** (for other cabinet heights the dimension sketch will be changed accordingly)



* For cabinet height 704 mm

Construction – see dimensions on the following page

-  Minimum area for reinforcement of wall. Wall material must be suitable for screw mounting.
-  Area for electric installation.
-  Area for conduit.

Cable for operation must be laid from the cabinet to the front edge of the worktop for mounting the control switch. We recommend the installation of a conduit in the wall to accommodate the cable ($\varnothing 3.5\text{cm}$).

If a high cabinet stands in the immediate vicinity of the Diagonal, the cable may be run through the cabinet to avoid the conduit in the wall.

40 – 120 cm

Max. load 120kg evenly distributed, according to DS/EN 12182, based on 9 screws/bolts.

130 – 180 cm

Max. load 220kg evenly distributed, according to DS/EN 12182, based on 18 screws/bolts.

Minimum load capacity per screw/bolt:

60kg

The fitter should always consider the material, condition and strength of the wall and use screws and rawlplugs suitable for the specific wall type.

**Cabinet width 40-50 cm
(30-40904 to 30-40905)**

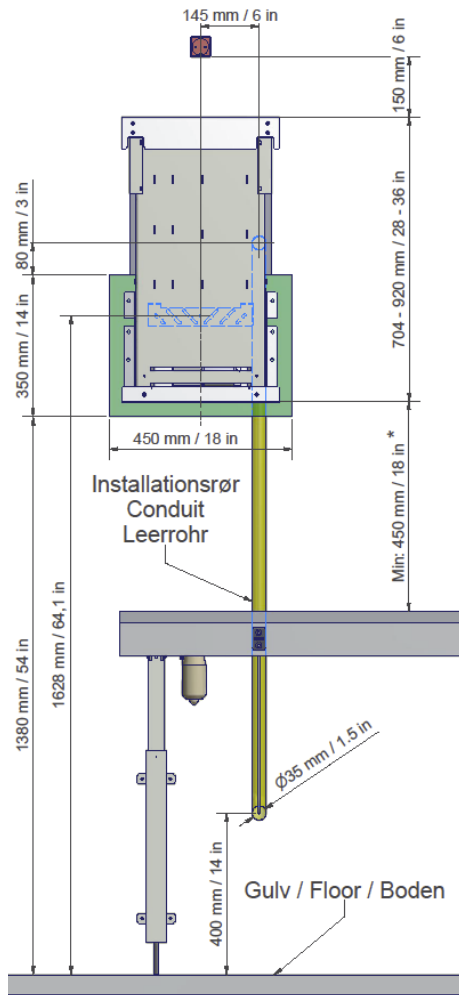

**Cabinet width 60-120 cm
(30-40906 to 30-40912)**

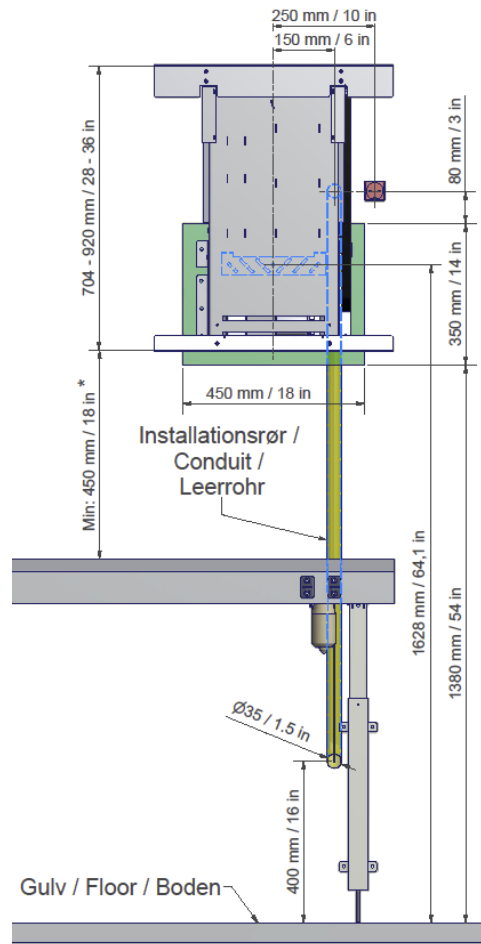

**Cabinet width 130-180 cm
(30-40913 to 30-40918)**

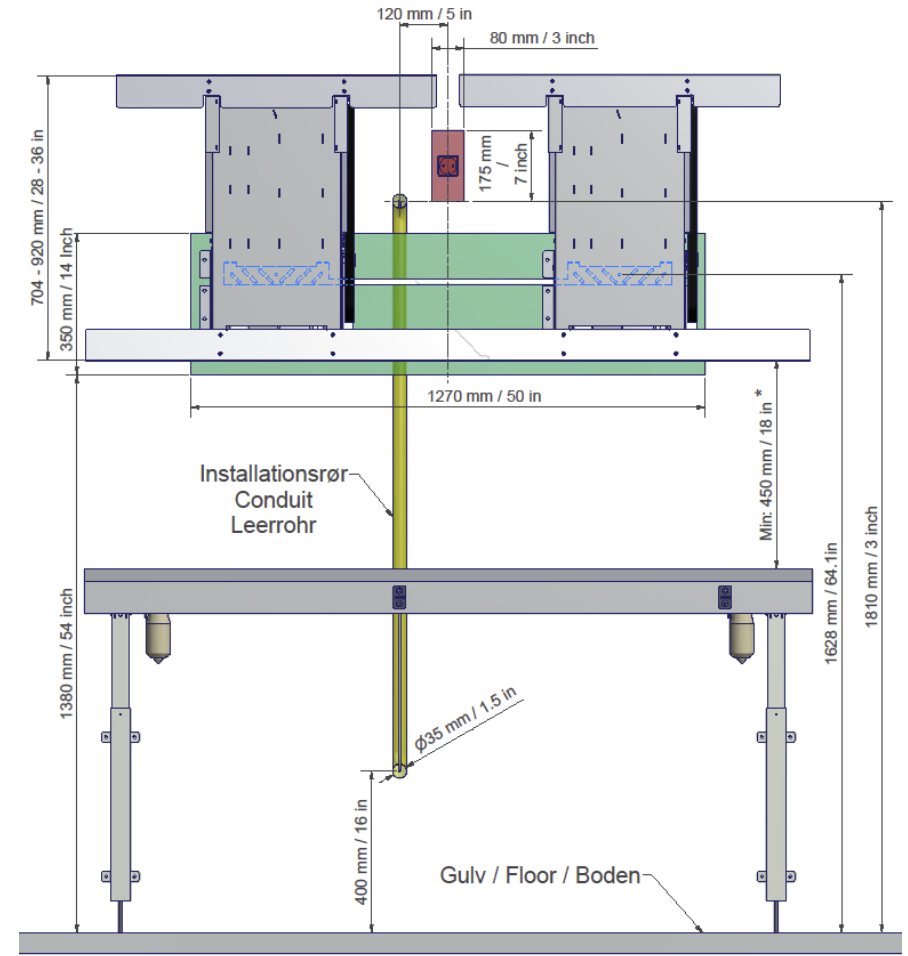

Ropox Verti Electric



Cabinet width 40-180 cm (30-40604 to 30-40618)

 **Assumptions for schematic diagram:**
Cabinet height = **704 mm** – (for other cabinet heights the dimension sketch will be changed accordingly)

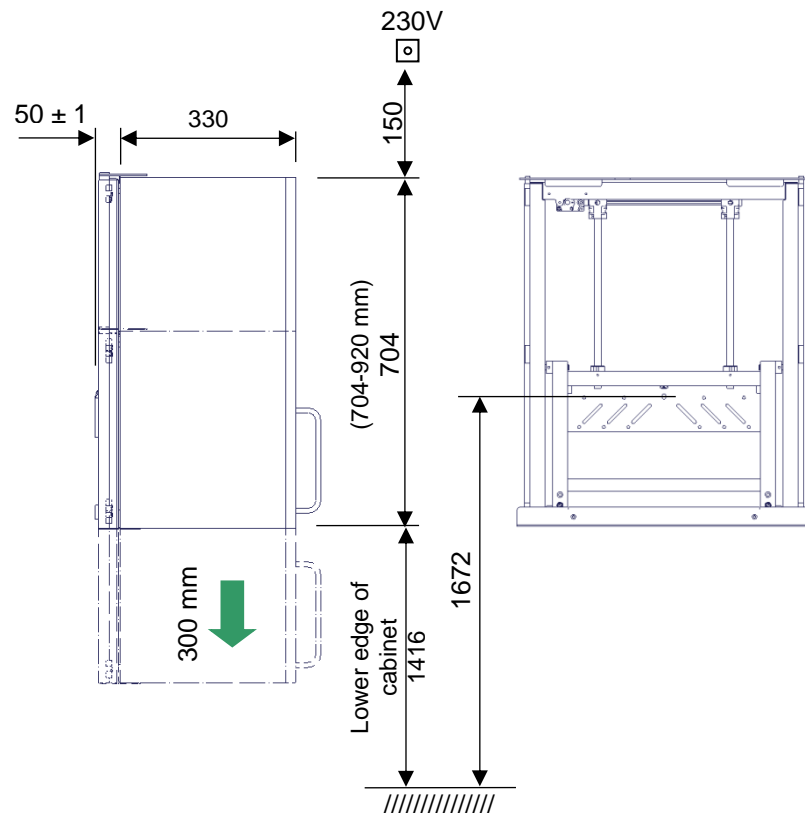
(The frame is designed for cabinet heights from 704-920 mm.)



Construction – see dimensions on the following page

-  Minimum area for reinforcement of wall. Wall material must be suitable for screw mounting.
-  Area for electric installation.
-  Area for conduit.

Cable for operation must be laid from the cabinet to the front edge of the worktop for mounting of the control switch. We recommend the installation of an empty pipe conduit in the wall to accommodate the cable (ø3.5cm).

If a high cabinet stands in the immediate vicinity of the Verti Electric, the cable may be run through the cabinet to avoid the conduit in the wall.

40 – 120 cm

Max. load 80kg evenly distributed, according to DS/EN 12182, based on 11 screws/bolts.

130 – 180 cm

Max. load 120kg evenly distributed, according to DS/EN 12182, based on 22 screws/bolts.

Minimum load capacity per screw/bolt:

22.5kg

The fitter should always consider the material, condition and strength of the wall and use screws and rawlplugs suitable for the specific wall type.

**Cabinet width 40-50 cm
(30-40604 to 30-40605)**

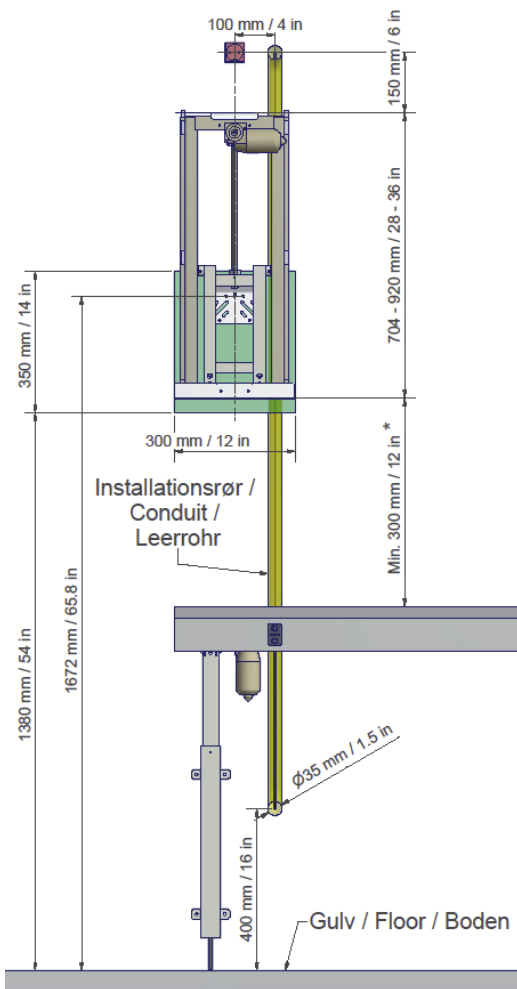

**Cabinet width 60-120 cm
(30-40606 to 30-40612)**

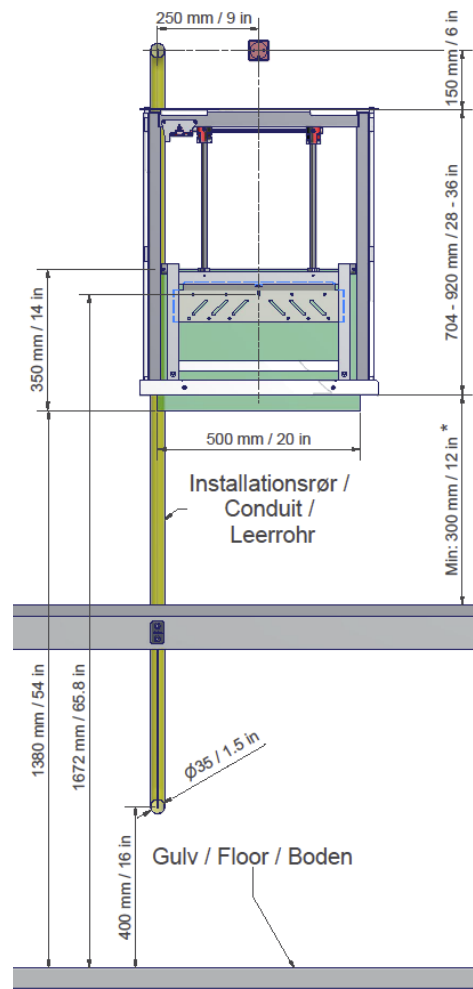

**Cabinet width 130-180 cm
(30-40613 to 30-40618)**

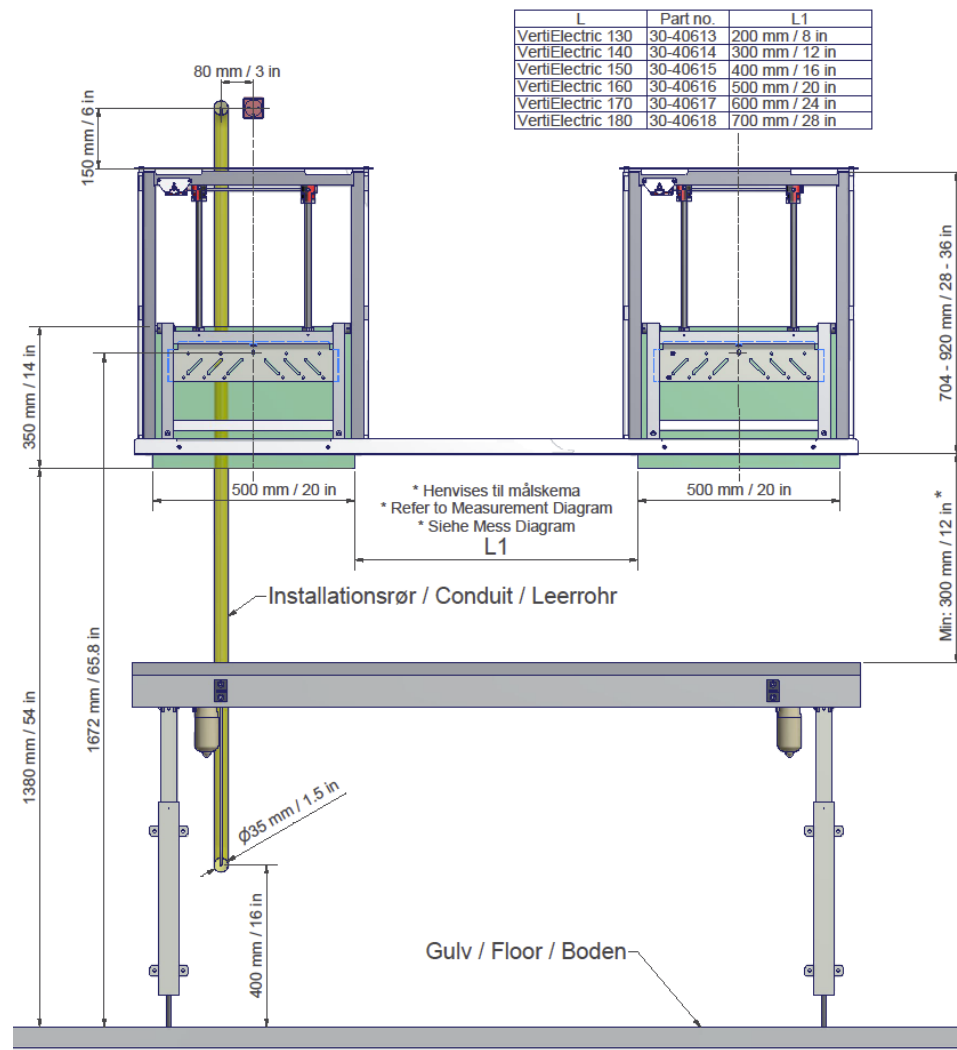

Ropox Verti-Inside

**Cabinet depth 26.5 cm or 31 cm and cabinet width 40-100 cm
(30-40404 to 30-40420)**

Construction – see dimensions on the following page

- Minimum area for reinforcement of wall. Wall material must be suitable for screw mounting.
- Area for electric installation.
- Area for conduit.

Cabinet height of 70.4cm or more. For cabinet heights above 70.4cm a fixed shelf is placed in the upper part of the cabinet (see illustration).

Cable for operation must be laid from the cabinet to the front edge of the worktop for mounting of the control switch. We recommend the installation of an empty conduit in the wall to accommodate the cable (ø3.5cm).

If a high cabinet stands in the immediate vicinity of Verti-Inside, the cable may be run through the cabinet to avoid the conduit in the wall.

Max. load 80kg evenly distributed over all three shelves for cabinets up to 100cm in width, according to DS/EN 12182, based on 8 screws/bolts.

Minimum load capacity per screw/bolt:
10.5kg

The fitter should always consider the material, condition and strength of the wall and use screws and rawplugs suitable for the specific wall type.

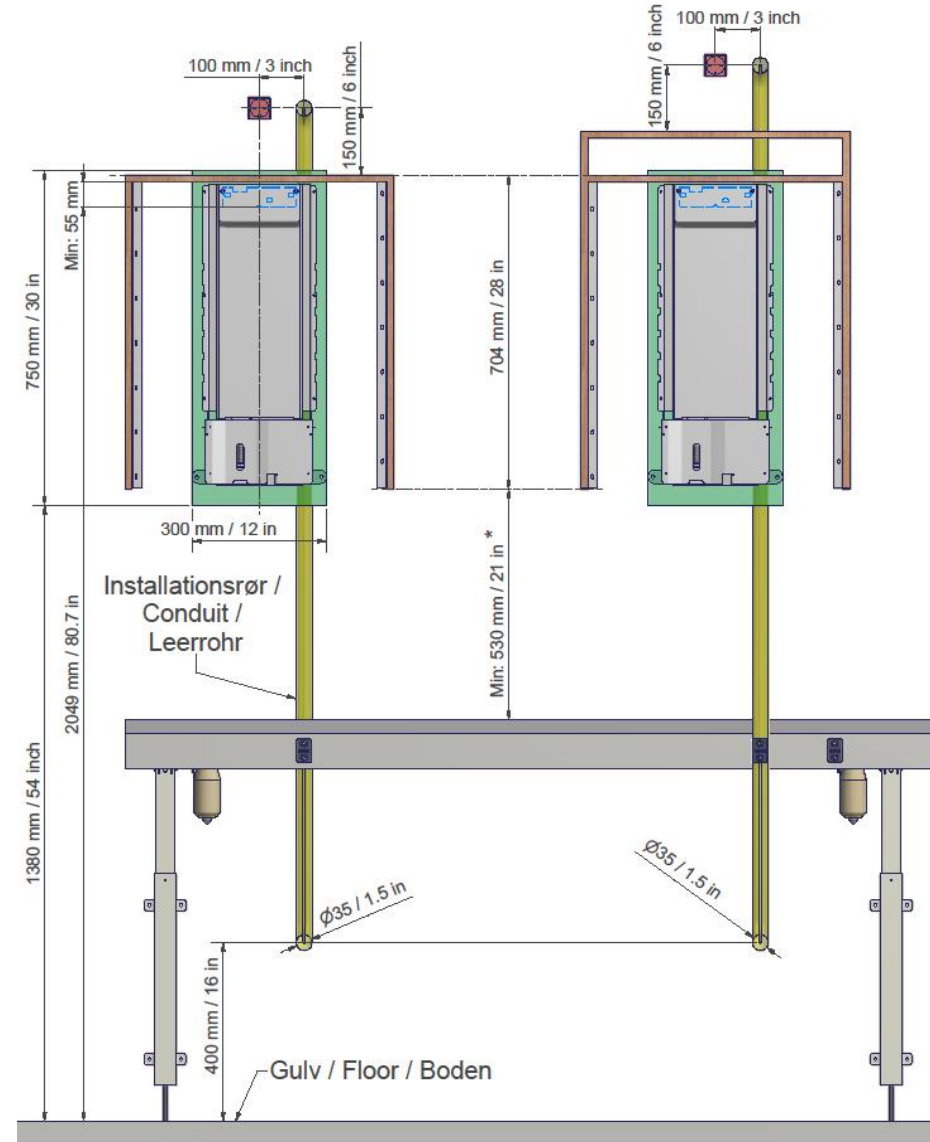

Cabinet height of 70.4 cm

Cabinet height above 70.4 cm

Ropox Brackets

**For wall cabinets
(30-80000)**

Construction – see dimensions on the following page

 Minimum area for reinforcement of wall. Wall material must be suitable for screw mounting.

Max. load 90kg evenly distributed over the cabinet up to 80cm in width, according to DS/EN 12182, based on 12 screws/bolts.

Minimum load capacity per screw/bolt:
25kg

The fitter should always consider the material, condition and strength of the wall and use screws and rawplugs suitable for the specific wall type.

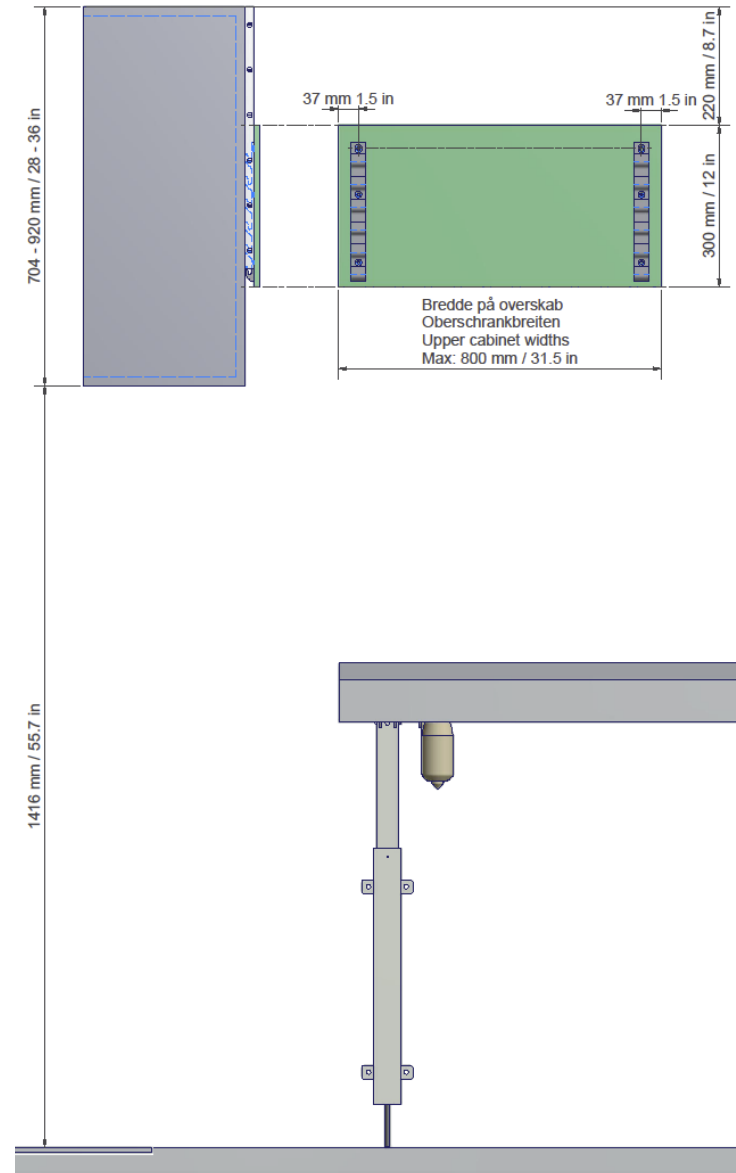

Ropox Brackets

For worktops (30-80006)

Construction – see dimensions on the following page

 Minimum area for reinforcement of wall. Wall material must be suitable for screw mounting.

 Area for electric and plumbing installations.

Max. load 75kg evenly distributed up to 80cm in width, according to DS/EN 12182.

Minimum load capacity per screw/bolt:

100 kg

The fitter should always consider the material, condition and strength of the wall and use screws and rawplugs for the specific wall type.

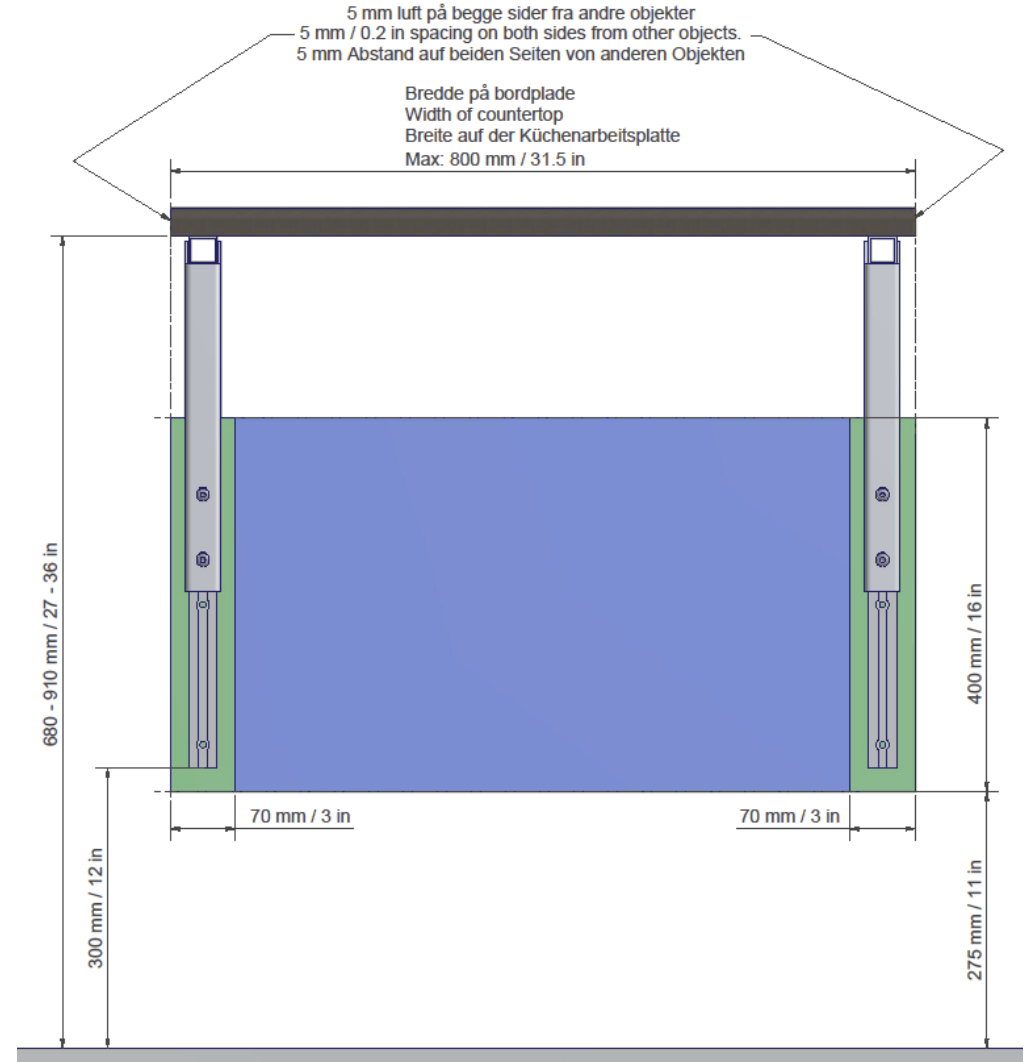

Ropox FlexiBasic

600 - 2000 mm
(30-63060 - 30-63200)

Construction – see dimensions on the following page.

 Minimum area for reinforcement of wall. Wall material must be suitable for screw mounting.

 Area for electric and plumbing installations.

Max. load 150kg evenly distributed over the worktop up to 300cm in width, according to DS/EN 12182.

Minimum load capacity per screw/bolt:

200 kg

The fitter should always consider the material, condition and strength of the wall and use screws and rawplugs suitable for the specific wall type.

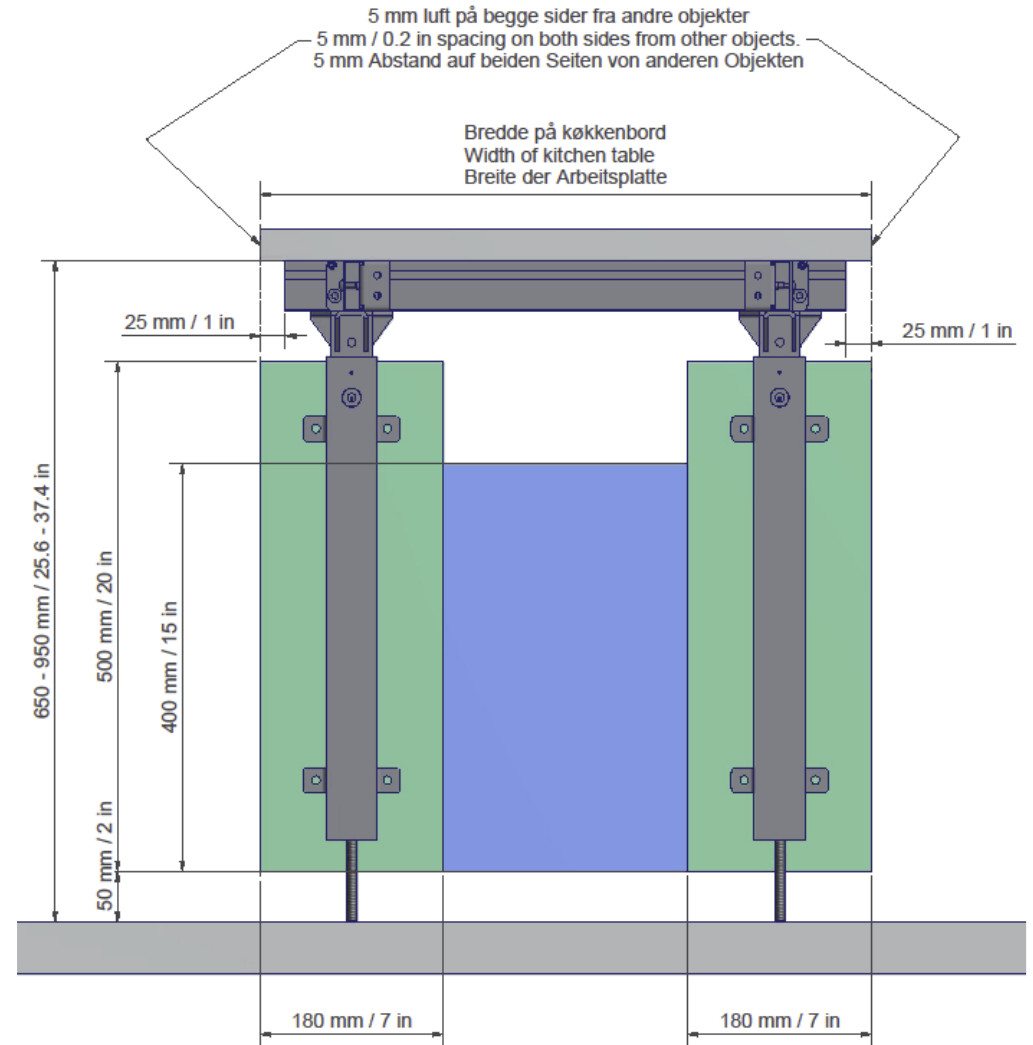

Ropox FlexiBasic

2050 – 3000 mm
(30-63205 - 30-63300)

Construction – see dimensions on the following page

 Minimum area for reinforcement of wall. Wall material must be suitable for screw mounting.

 Area for electric and plumbing installations.

Max. load 150kg evenly distributed over the worktop up to 300cm in width, according to DS/EN 12182.

Minimum load capacity per screw/bolt:
200 kg

The fitter should always consider the material, condition and strength of the wall and use screws and rawplugs suitable for the specific wall type.

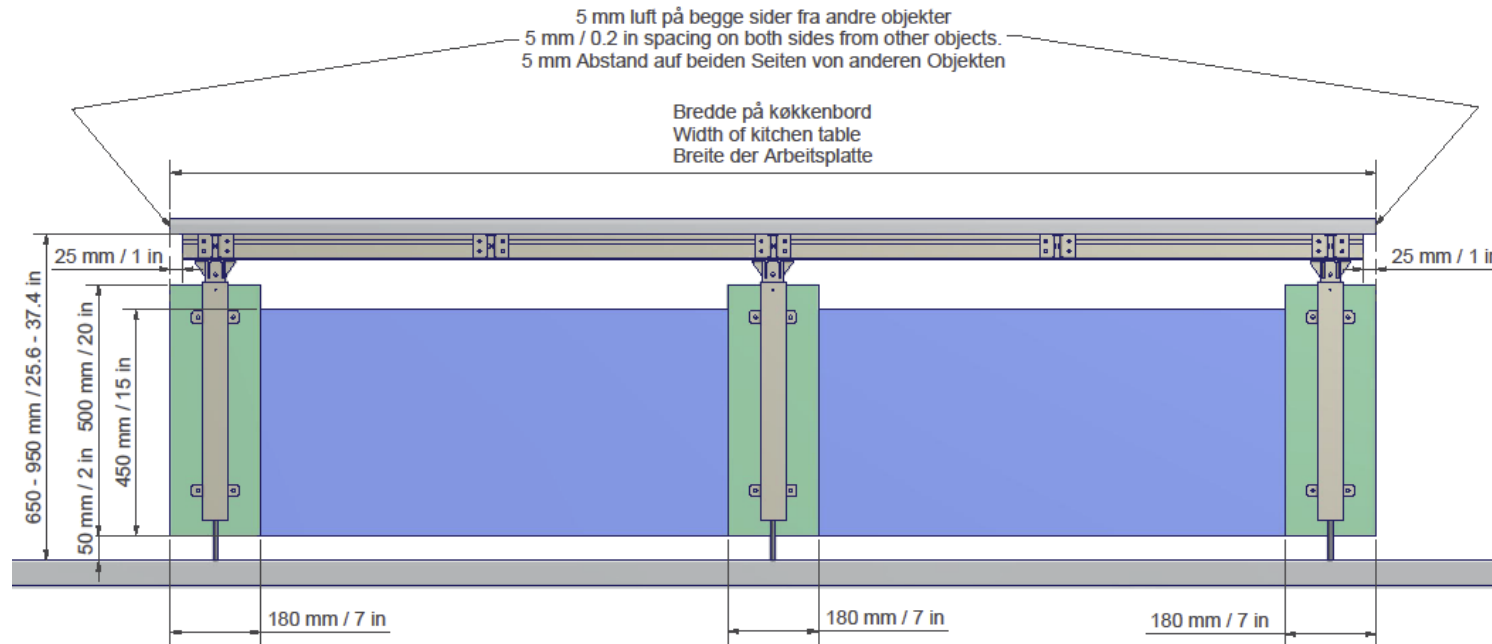

Ropox FlexiManual

600 - 2000 mm
(30-65060 - 30-65200)

Construction – see dimensions on the following page

 Minimum area for reinforcement of wall. Wall material must be suitable for screw mounting.

 Area for electric and plumbing installations.

Max. load 150kg evenly distributed over the worktop up to 300cm in width, according to DS/EN 12182.

Minimum load capacity per screw/bolt:
200 kg

The fitter should always consider the material, condition and strength of the wall and use screws and rawplugs suitable for the specific wall type.

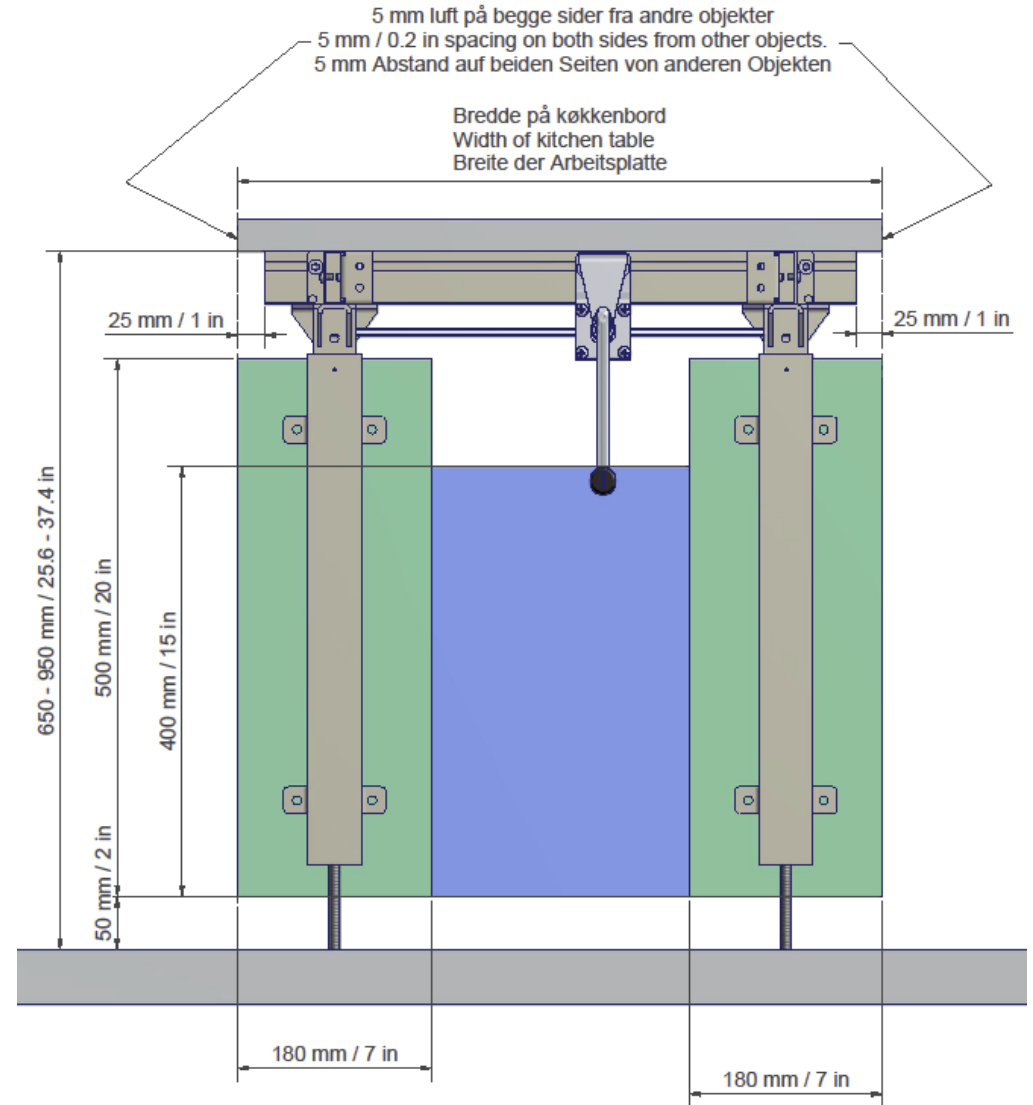

Ropox FlexiManual

2050 – 3000 mm
(30-65205 - 30-65300)

Construction – see dimensions on the following page

 Minimum area for reinforcement of wall. Wall material must be suitable for screw mounting.

 Area for electric and plumbing installations.

Max. load 150kg evenly distributed over the worktop up to 300cm in width, according to DS/EN 12182.

Minimum load capacity per screw/bolt:
200 kg

The fitter should always consider the material, condition and strength of the wall and use screws and rawplugs suitable for the specific wall type.

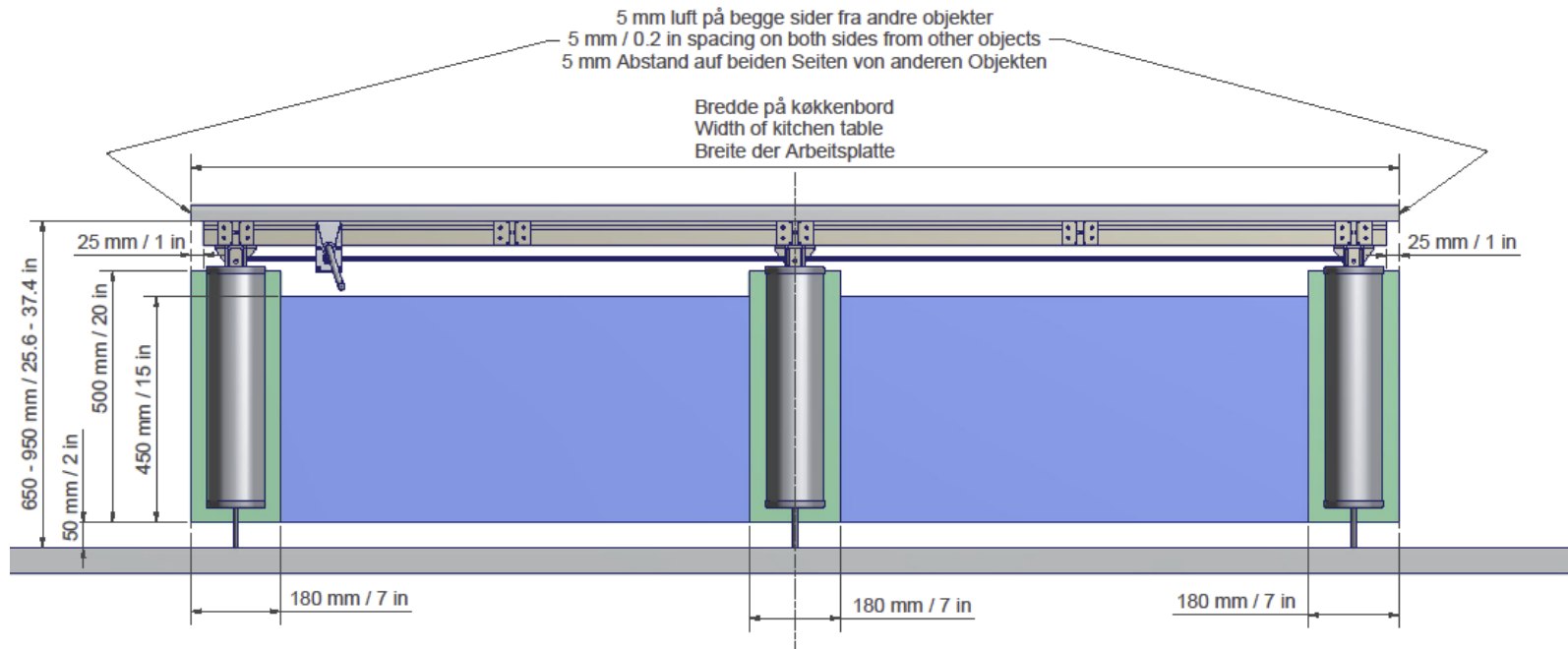

Ropox FlexiElectric

600 – 3000 mm
(30-66060 - 30-66200)

Construction – see dimensions on the following page

 Minimum area for reinforcement of wall. Wall material must be suitable for screw mounting.

 Area for electric and plumbing installations.

Max. load 150kg evenly distributed over the worktop up to 300cm in width, according to DS/EN 12182.

Minimum load capacity per screw/bolt:
200 kg

The fitter should always consider the material, condition and strength of the wall and use screws and rawplugs suitable for the specific wall type.

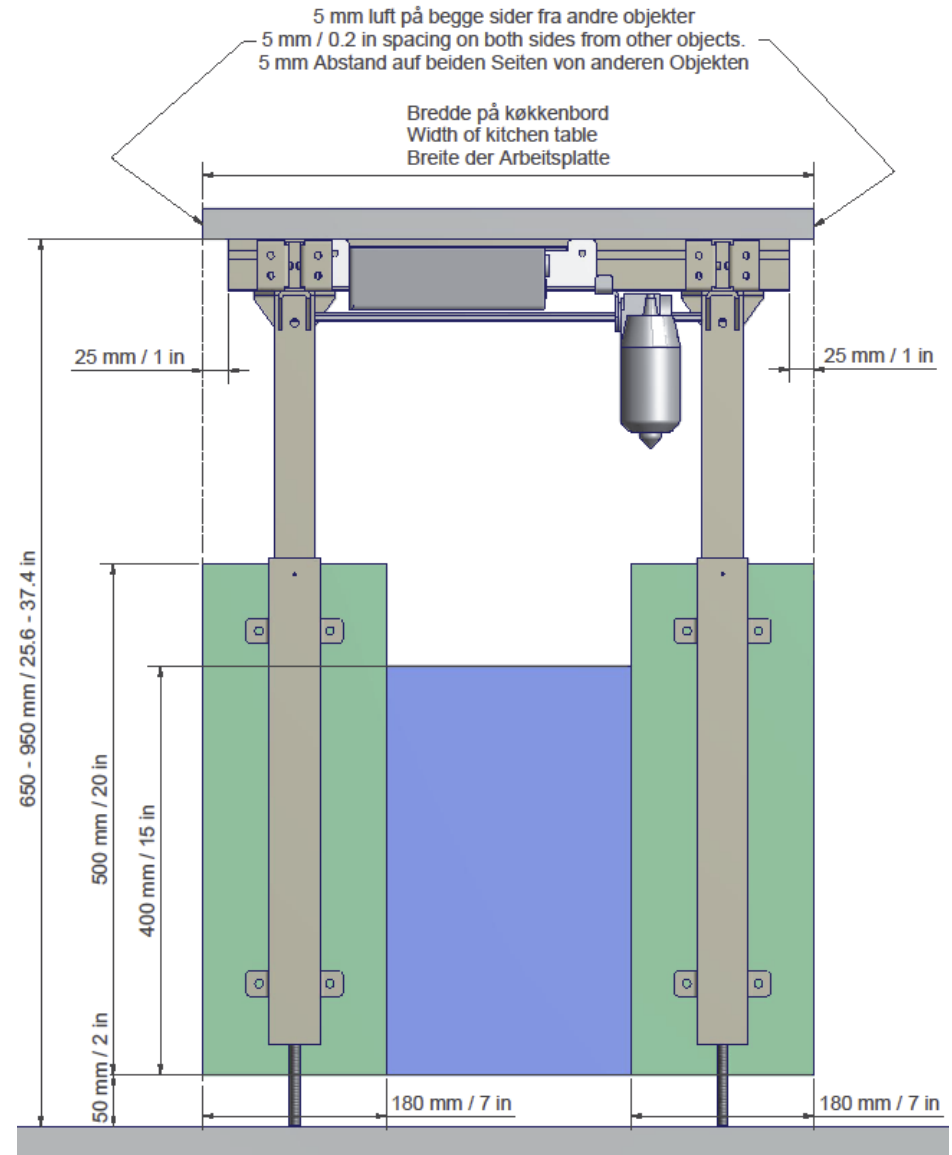

Ropox FlexiElectric

2050 – 3000 mm
(30-66205 - 30-66300)

Construction – see dimensions on the following page

 Minimum area for reinforcement of wall. Wall material must be suitable for screw mounting.

 Area for electric and plumbing installations.

Max. load 150kg evenly distributed over the worktop up to 300cm width, according to DS/EN 12182.

Minimum load capacity per screw/bolt:
200 kg

The fitter should always consider the material, condition and strength of the wall and use screws and rawlplugs suitable for the specific wall type.

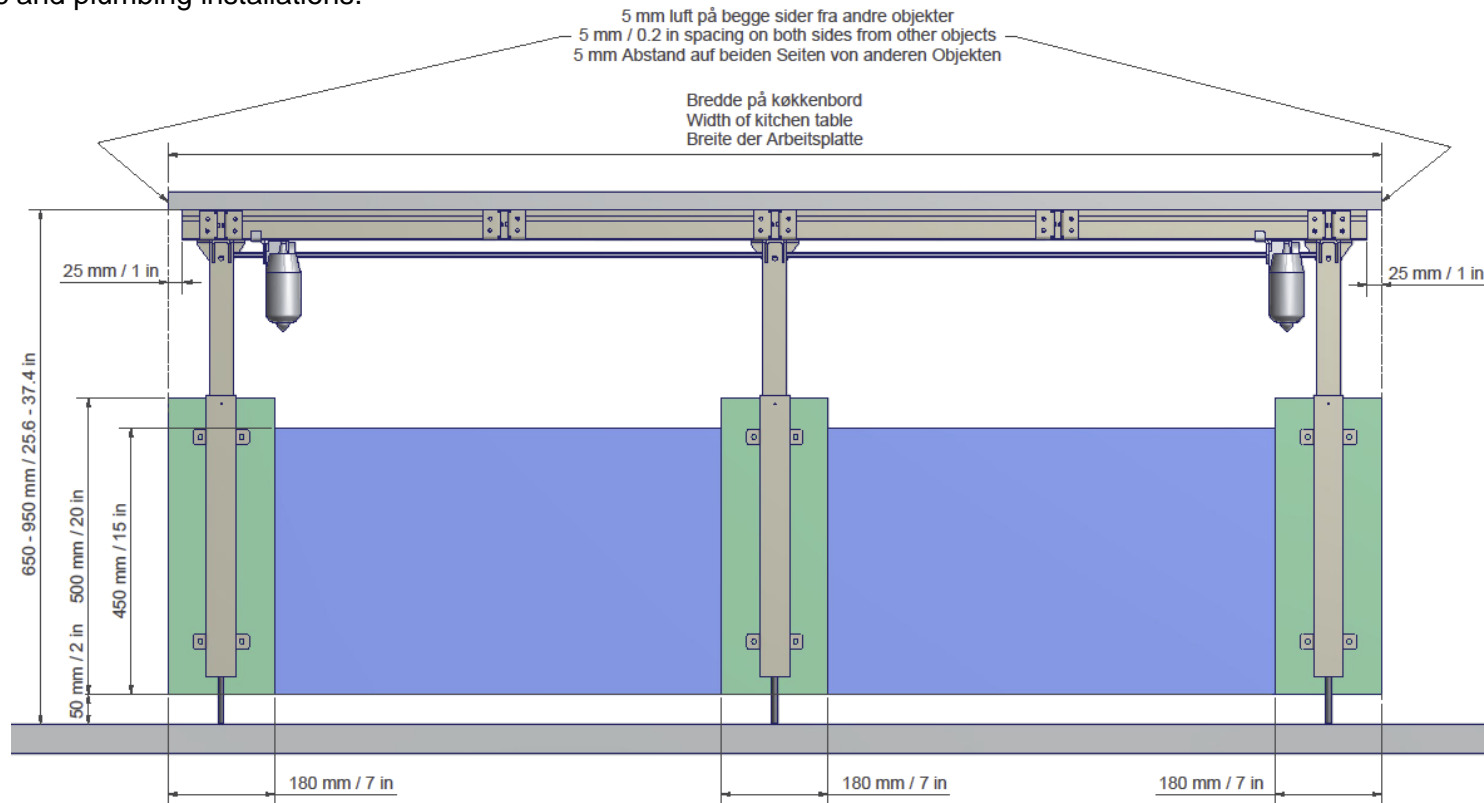

Ropox FlexiCorner

Construction – see dimensions on the following page

 Minimum area for reinforcement of wall. Wall must be suitable for screw mounting.

 Area for electric and plumbing installations.

Max. load 150kg evenly distributed over the worktop up to 300cm width, according to DS/EN 12182.

Min. load capacity per screw/bolt:
200 kg

The fitter should always consider the material, condition and strength of the wall and use screws and rawlplugs suitable for the specific wall type.

Antal ben afhænger af bordpladebredde
The number of table legs depend on the counter top width
Die Anzahl der Tischbeinen abhängig von der Breite der Tischplatte
900 - 2000 mm / 35 - 78 in: 2 ben / 2 legs / 3 Tischbein
2050 - 3000 mm / 80 - 118 in: 3 ben / 3 legs / 3 Tischbein

