

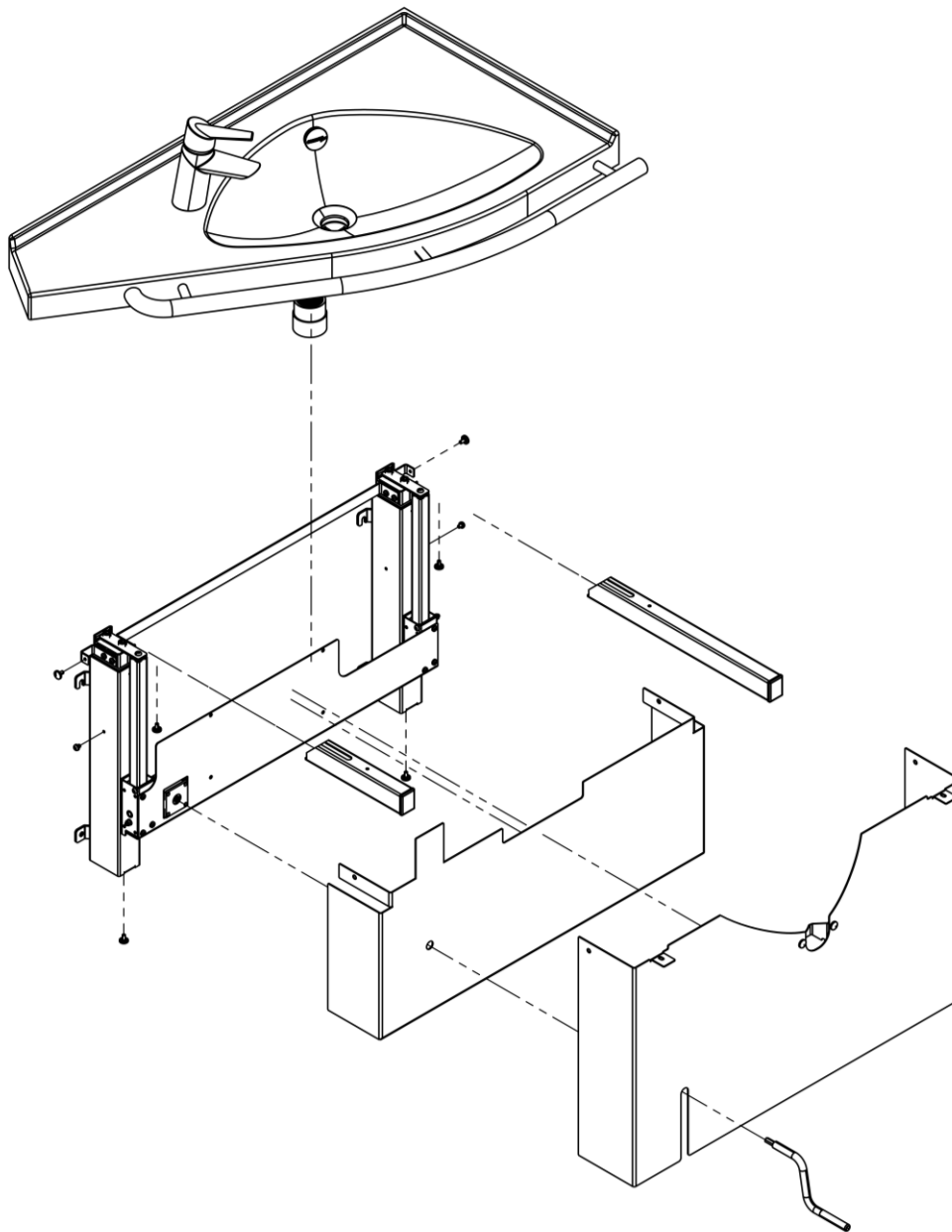



21273109-00 Manual Gaius Original basin lifter installation guide



Description

ID	Item Revision	
D012225	A.2	
Type	Installation instructions	
Subject		
Owner	korpinen_admin	
Owning Group	Korpinen	

Symbols used in this manual

Warning! Indication of potentially hazardous situation. If not avoided, it can result in serious injury or death.	
Caution! Indication of potentially hazardous situation which may result in minor or moderate injury. It may also be used to alert against unsafe practices.	
Notification! This symbol is used to notify correct use and handling of the product.	

General safety

	<p>This manual must be read and understood before use and installation. Always keep this manual in close proximity of the product.</p> <p>The use, installation and service of this product must follow this manual to avoid accidents and serious personal injury.</p> <p>Never use or handle this product in other ways specified in this manual as it can result in personal safety hazards and/or cause damage to the product.</p> <p>Persons installing and/or using this product either as operator or user should have the necessary safety information and access to this manual.</p> <p>If the supply cord is damaged, it must be replaced by the manufacturer, its service agent or duly qualified designated persons in order to avoid a hazard.</p>



Do not perform unauthorized repairs, disassembly or assembly operations, add-ons, re-adjustments or modification of the product beyond what is described in this manual. Any use, modification or adjustment not described in the most recent approved revision of the manual is strictly forbidden. Do not perform service while the product is connected to the mains power.

This appliance can be used by children aged from 8 years and above and persons with reduced physical, sensory or mental capabilities or lack of experience and knowledge if they have been given adequate supervision or instruction concerning the safe use of the appliance and they understand the hazards involved. Children shall not play with the appliance. Cleaning and user maintenance shall not be performed by children without supervision.

Do not use the product if it has defects or signs of damage are present. If the device makes unusual noise or smells, switch off the mains voltage immediately.

Take care that the cables are not damaged. Unplug the mains cable on mobile equipment before it is moved.













The products must only be used in an environment that corresponds to their IP protection.



The information in this manual is based on correct installation in accordance with installation instructions for this product.

Korpinen cannot be held liable if the product is used in any way that differs from stated in this manual and/or installation instruction. Korpinen reserves the right to amend this manual and reference documents without prior notice.

Product label symbols

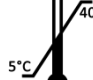
	<p>This product is CE-marked in accordance with:</p> <p>Council Directive 2006/42/EC on machinery</p> <p>Council Directive 2011/65/EU, RoHS</p>
	<p>Manufacturer name and address</p>
	<p>Date of production</p>
	<p>Stock number</p>
	<p>Serial number</p>
	<p>Consult manual before use</p>
	<p>Operating interval of electrically operated equipment. The use of electrical height adjustable equipment can run at maximum 2 minutes, followed by an 18-minute break.</p>
	<p>Type B applied part. The product complies with IEC 60601-1 requirements to provide protection against electric shock.</p>
	<p>Consult manual for important safety related information, warnings, and safety precautions.</p>
	<p>Class II, double isolated electrical components.</p>
	<p>Do not dispose as unsorted municipal waste. Product must be returned to a designated recycling station.</p>
	<p>Mobile phones or other portable RF emitting equipment should be no closer to the product than 30cm.</p>
	<p>Operating and storing temperatures may not exceed 5-40°C</p>

Exploded view

1 pcs. Faucet
with 10mm inlet
tubing (Sold
separate)

1 pcs. 6203
Original basin
(Sold separate)

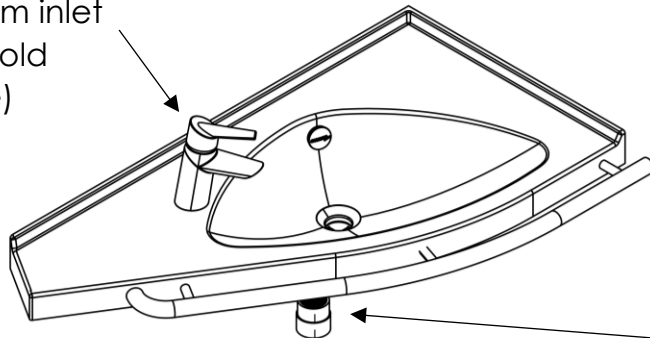

1 pcs. 13982
Drain pipe (sold
separate)

1 pcs. Lifting unit

1 pcs. Bottom
cover

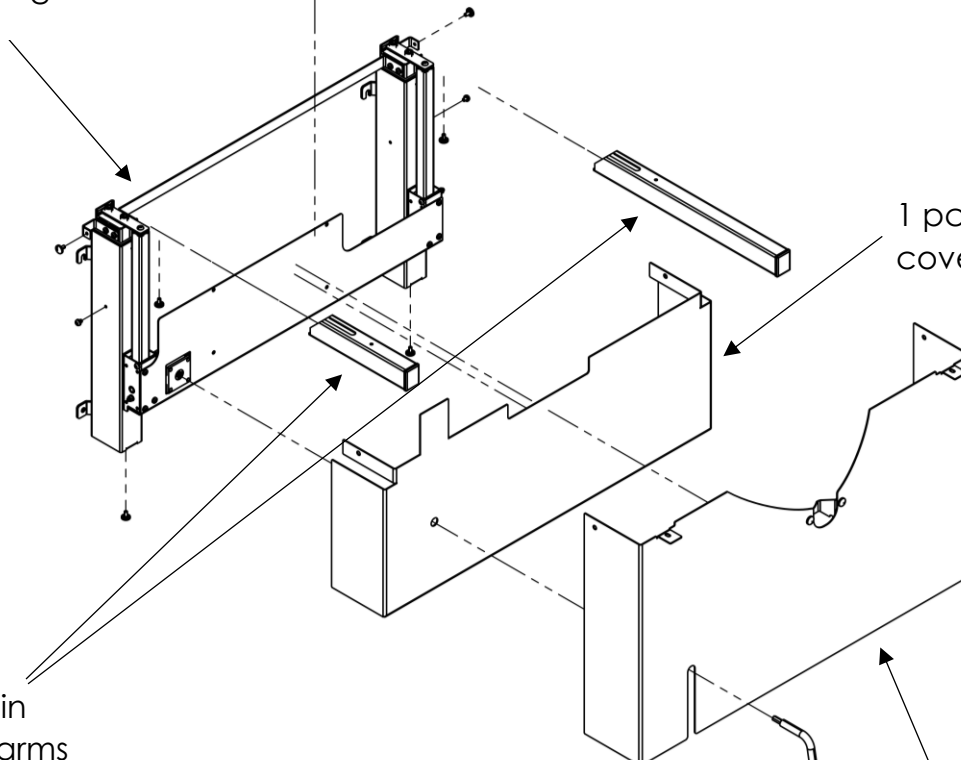

1 set Basin
support arms

1 pcs. Top cover

1 pcs. Crank

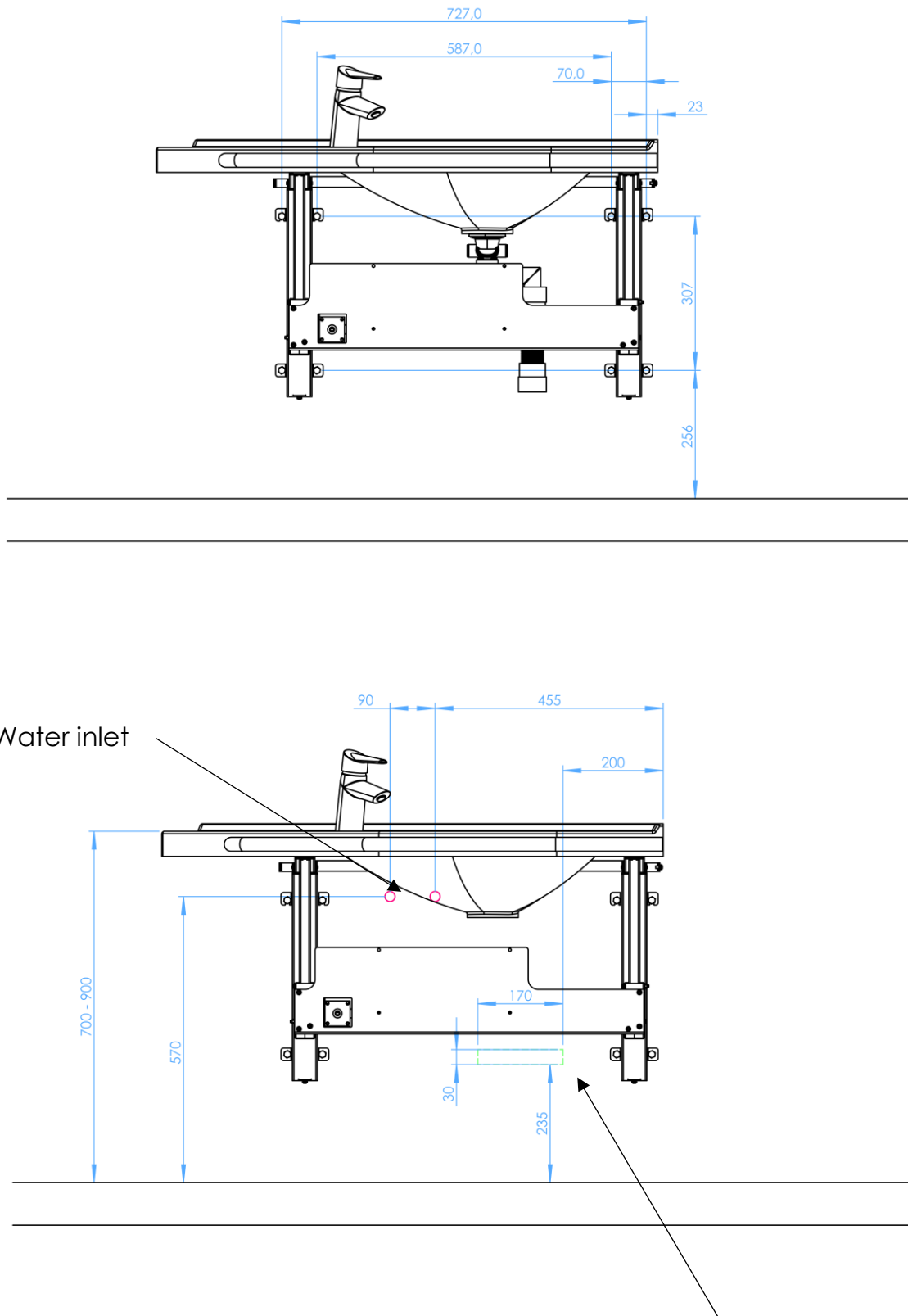

Figure 1. Water inlet, drain and mounting hole placement

Drain area

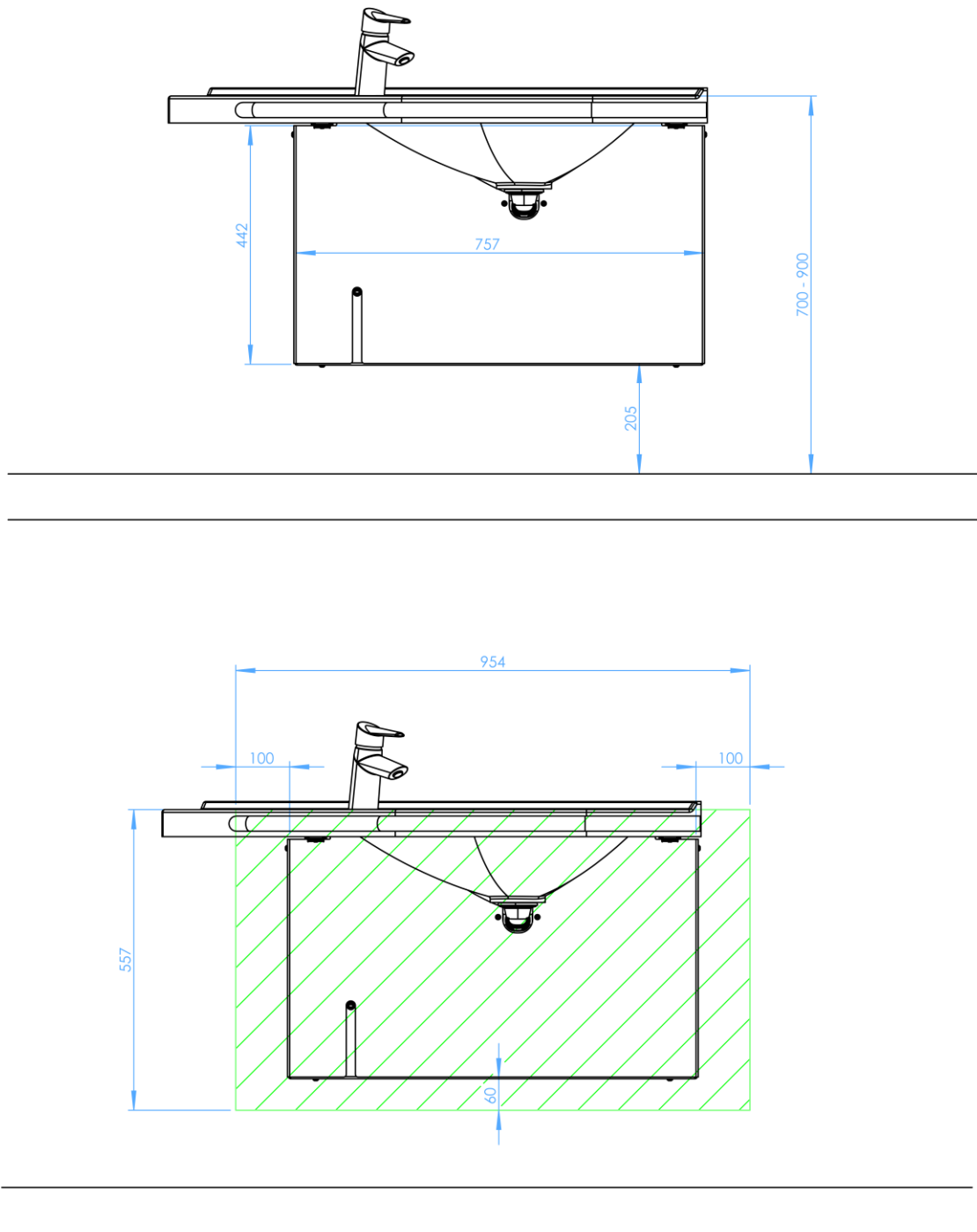
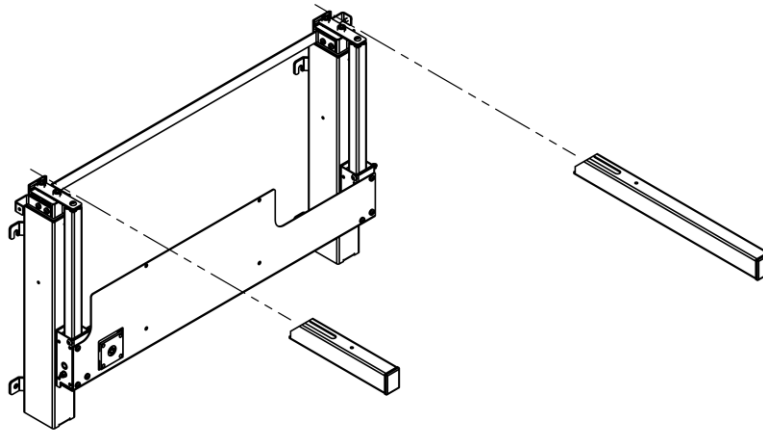
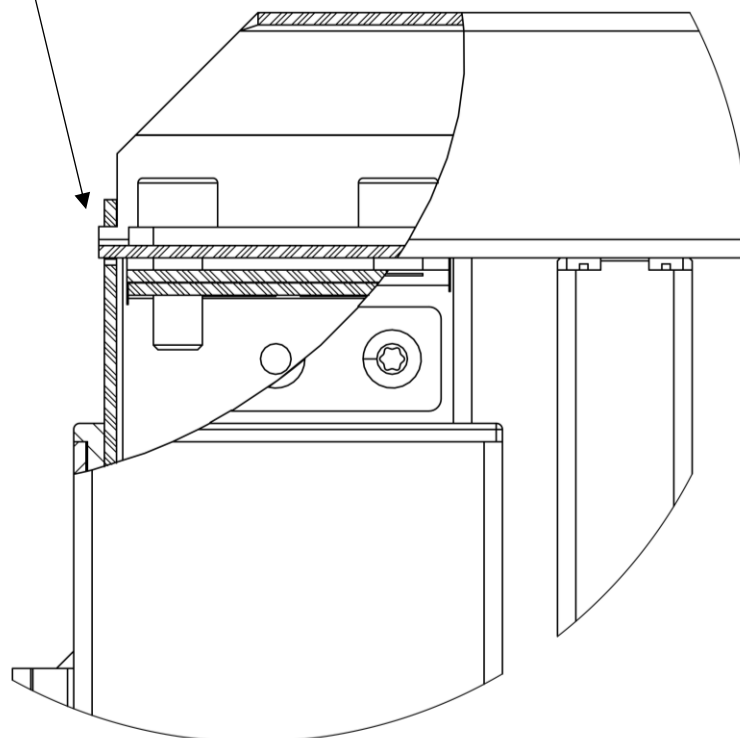

Figure 2. External dimensions and reinforced area (Plywood 20 mm with full thread screws)

1. Install the basin support arms and tighten the mounting screws



Make sure the support arms are mounted as far as they will go.



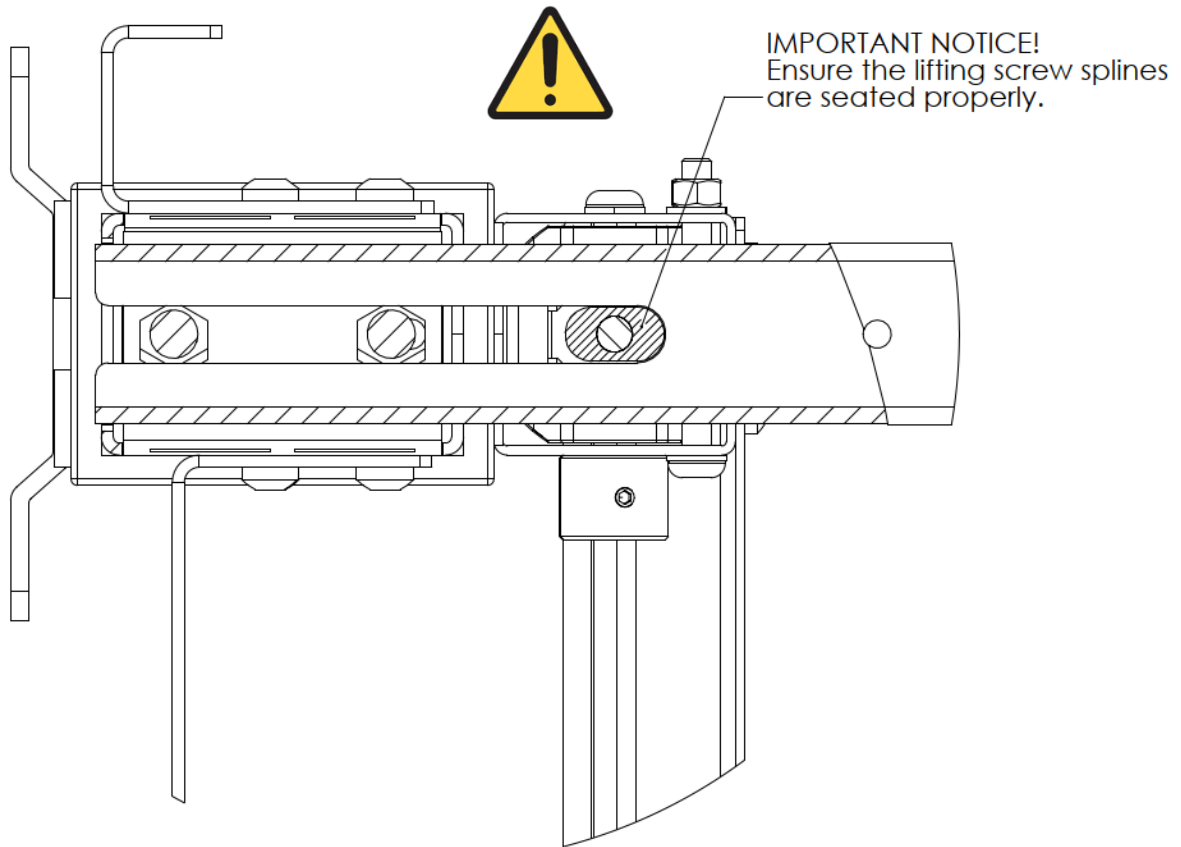

2. Predrill all necessary holes. Refer to Fig. 2 for mounting hole positions. Install the top mounting screws into the wall.

NOTICE! Mounting hardware not included
Korpinen part no. 6219-Z

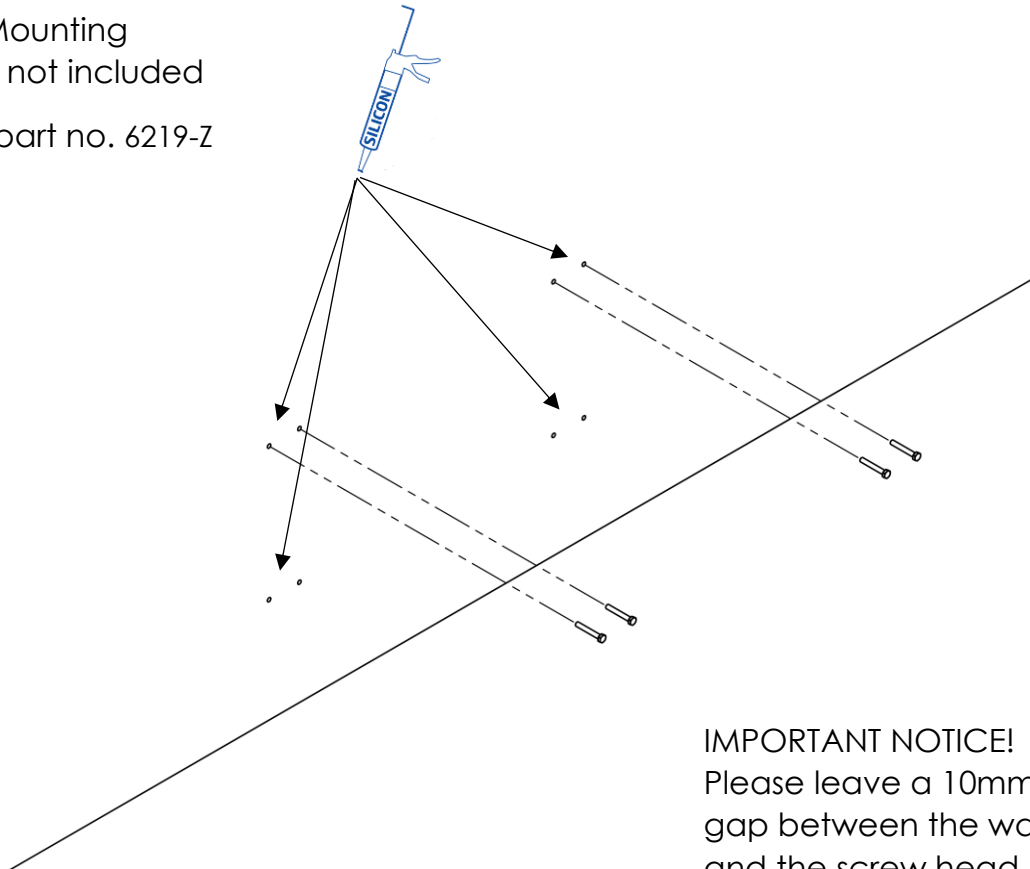

IMPORTANT NOTICE!
Please leave a 10mm gap between the wall and the screw head.
Refer Fig. 2 for hole positions.

NOTICE! If the wall material requires the use of a wall plug, silicone caulk should be used in the holes.

3. Lift the basin lifter on top of the top screws in the wall.
Using a spirit level, ensure that the unit is installed level.

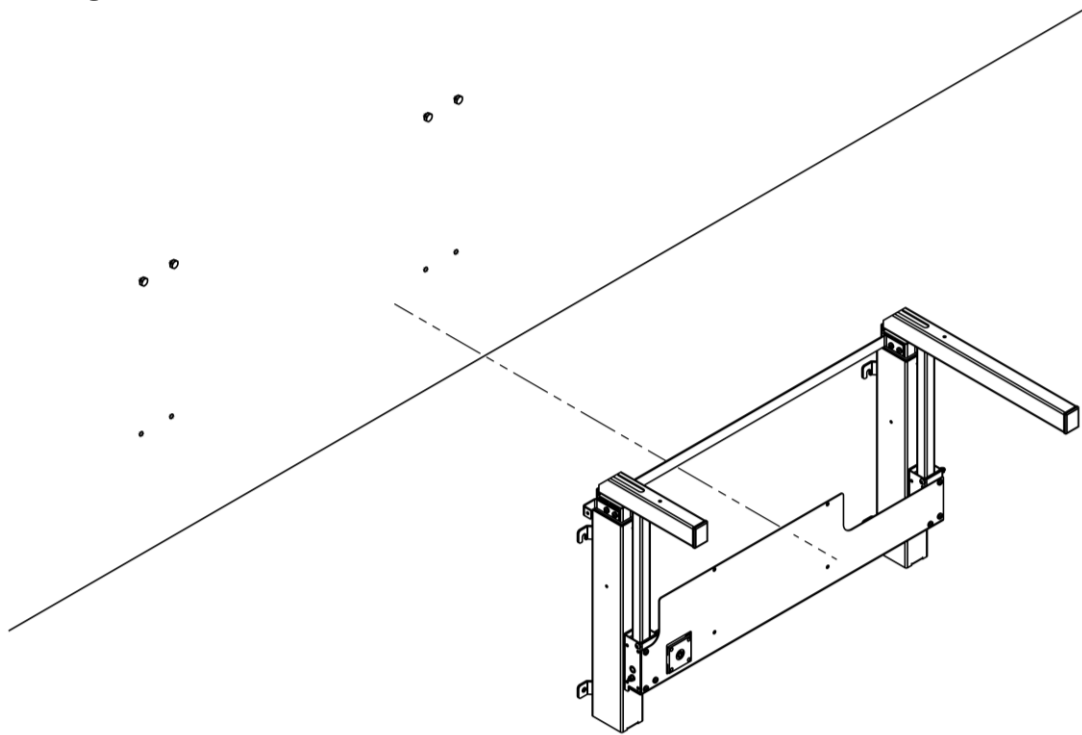

4. When the unit is level, tighten the top screws; insert and tighten the bottom screws. Plug the lifter to mains power and test the lifter before adhering the basin.

IMPORTANT NOTICE! Use a spirit level to ensure the unit is installed level

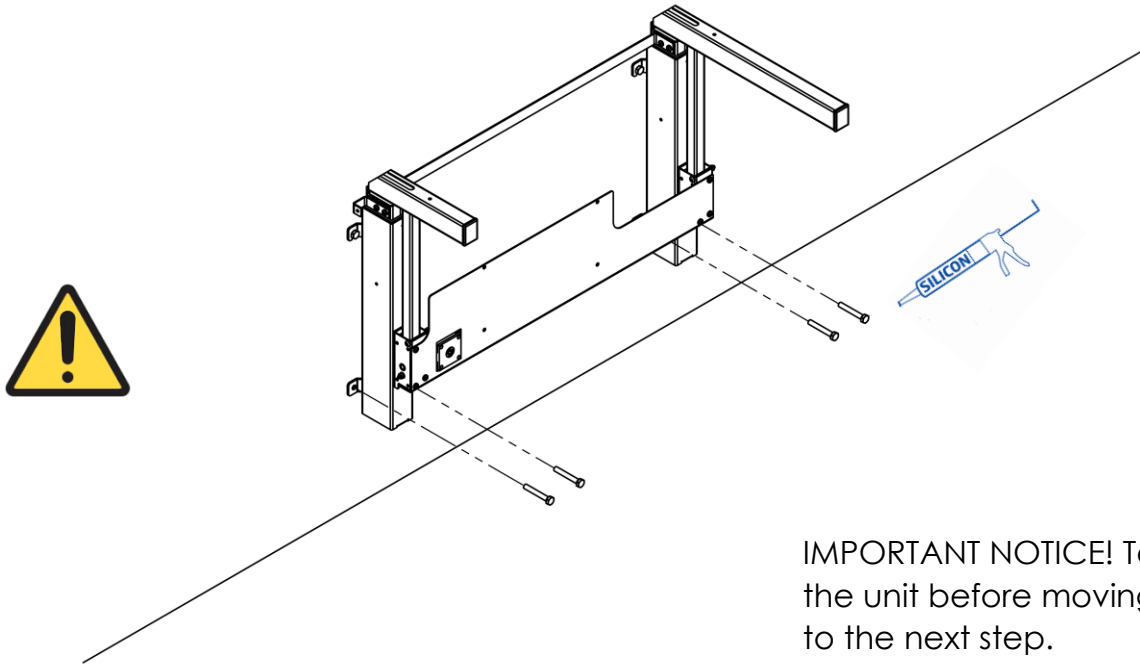

IMPORTANT NOTICE! Test the unit before moving to the next step.

IMPORTANT NOTICE! While testing, keep hands and tools away from the open mechanism.

5. Assemble the faucet, basin and plumbing

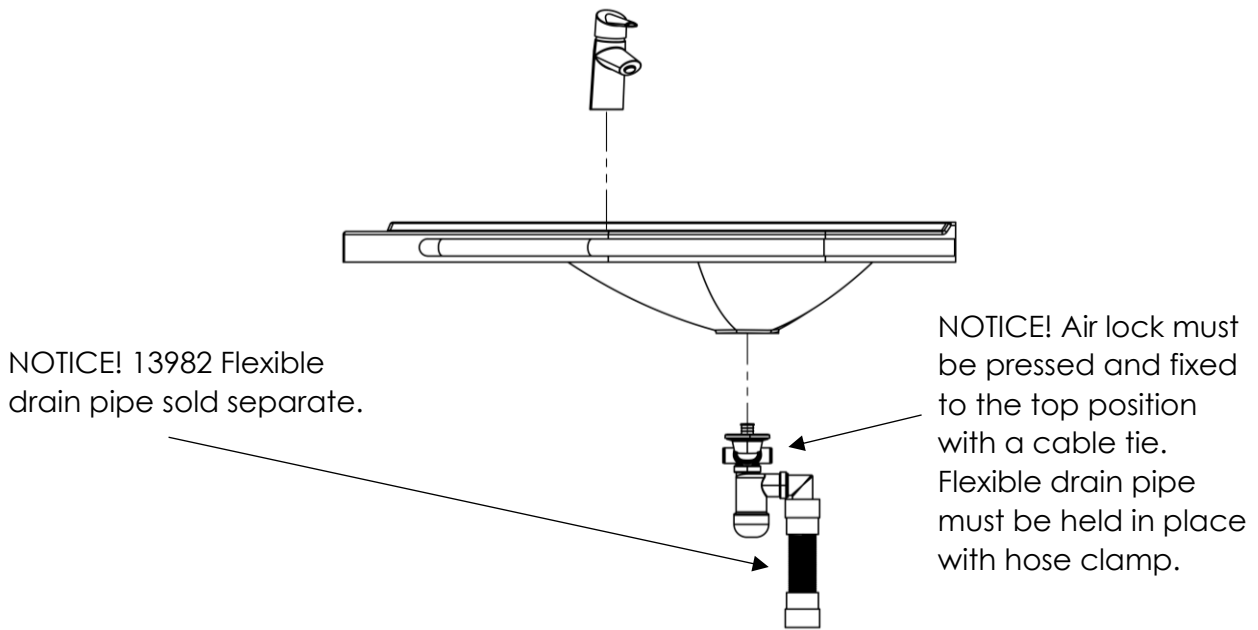

IMPORTANT NOTICE!
The faucet tubes must be 10mm in diameter.
Cut the faucet tubes to the specified length.

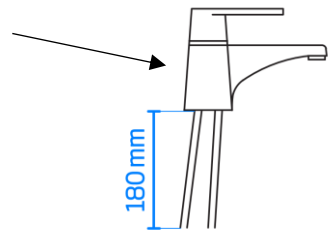

NOTICE! Cut the air lock plumbing to size

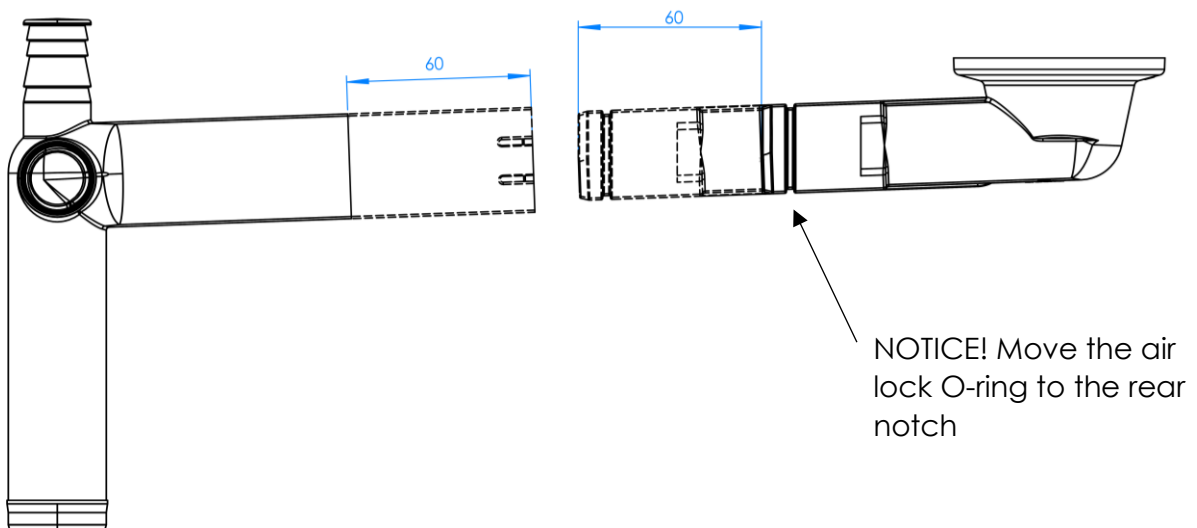

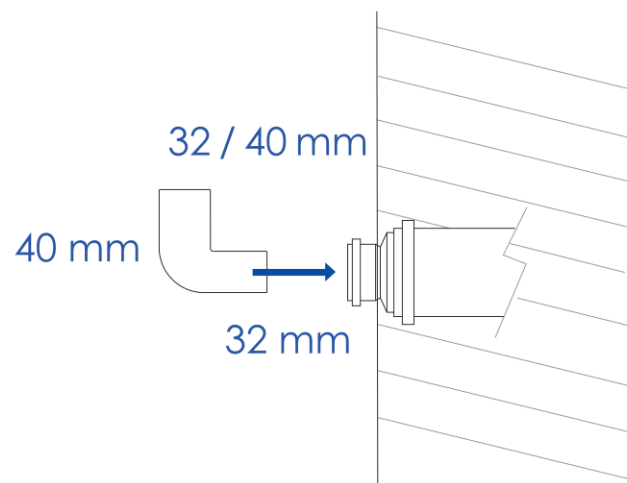
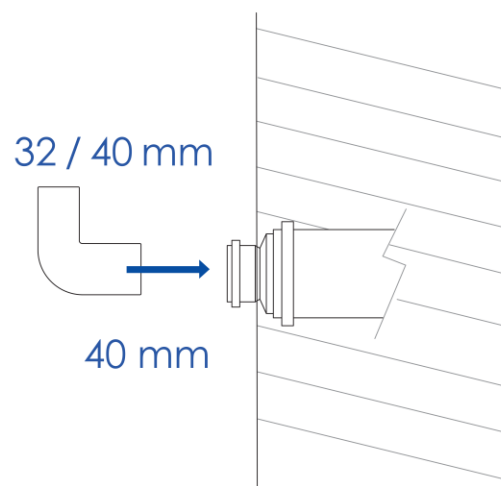
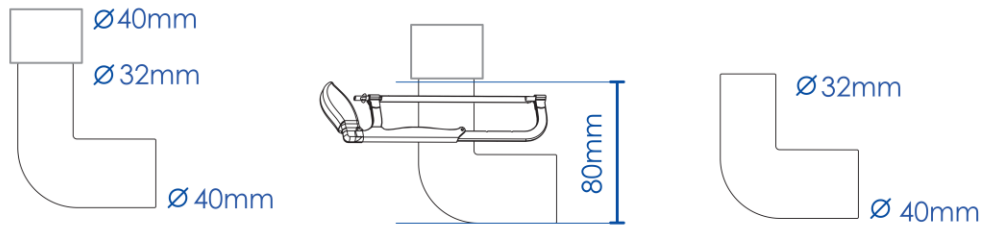

6. After testing the unit and cleaning the underside of the basin, adhere the basin to the lifter frame and install the plumbing.

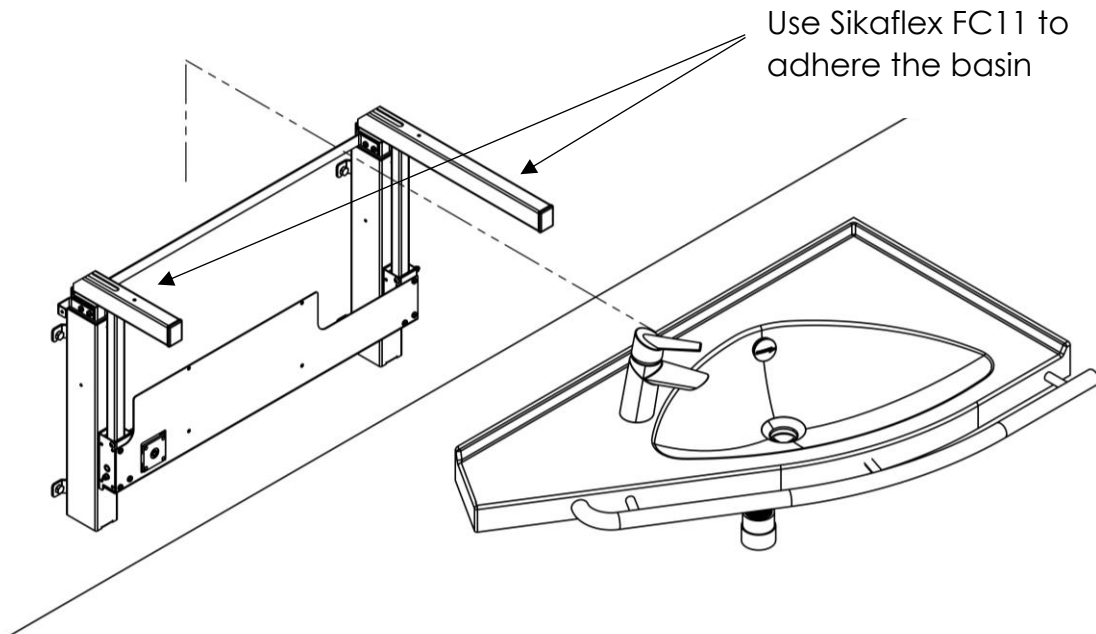

IMPORTANT NOTICE! The bond will be permanent

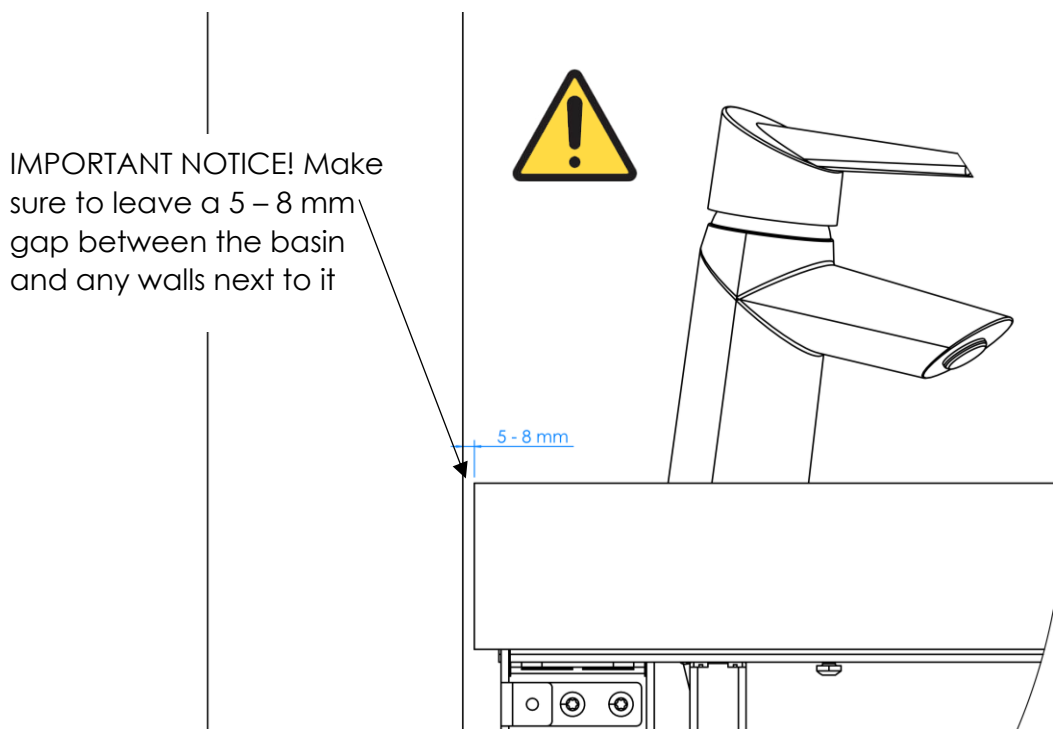

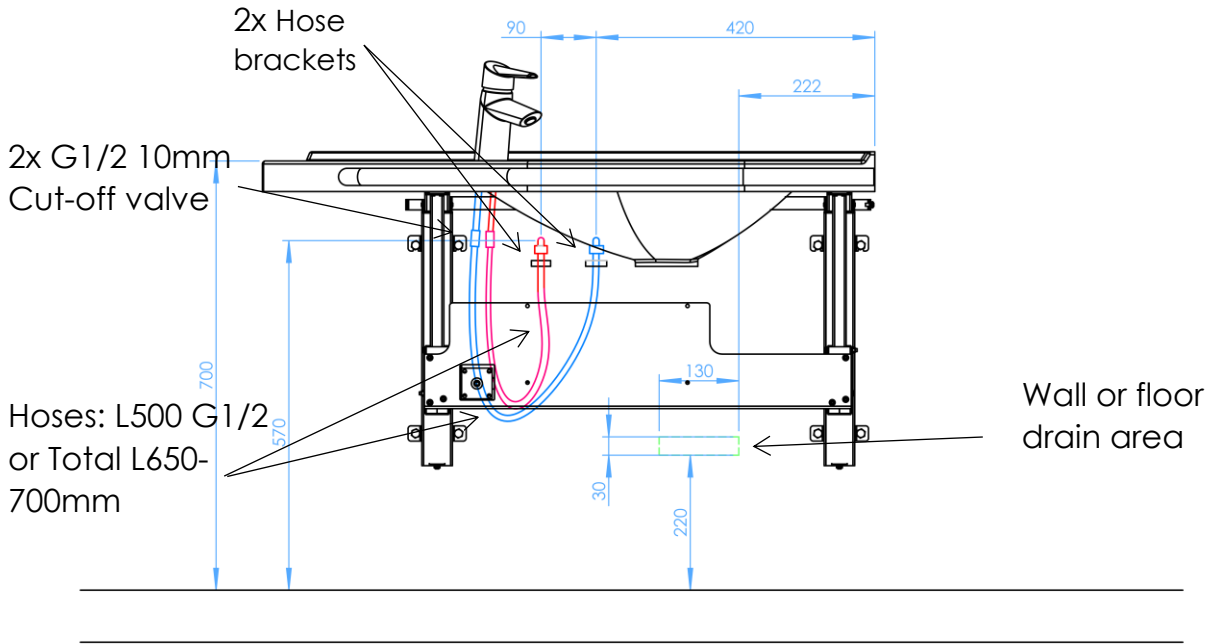

IMPORTANT NOTICE! Floor drain tube diameter 32 – 40 mm. Center distance from wall 50 - 60 mm. Recommended floor drain height 235 mm.

NOTICE! 13970 Water hoses, connectors and brackets package (sold separate) contains: 2 pcs. Hose L500 G1/2, 2 pcs. G1/2 10mm Cut-off valves and 2 pcs. Hose brackets

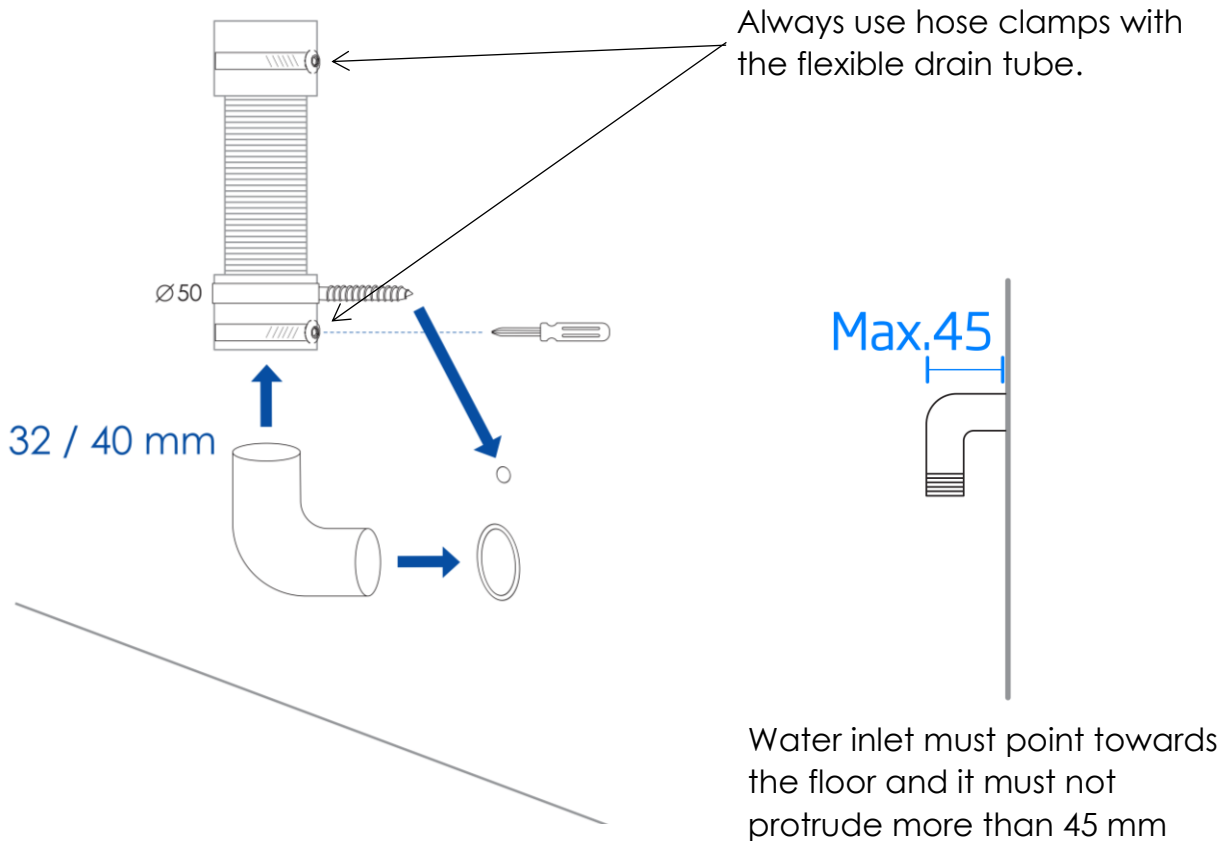

7. Install the bottom cover

IMPORTANT NOTICE!
Mind the bottom screws when sliding the bottom cover to place; remember to tighten the bottom screws.

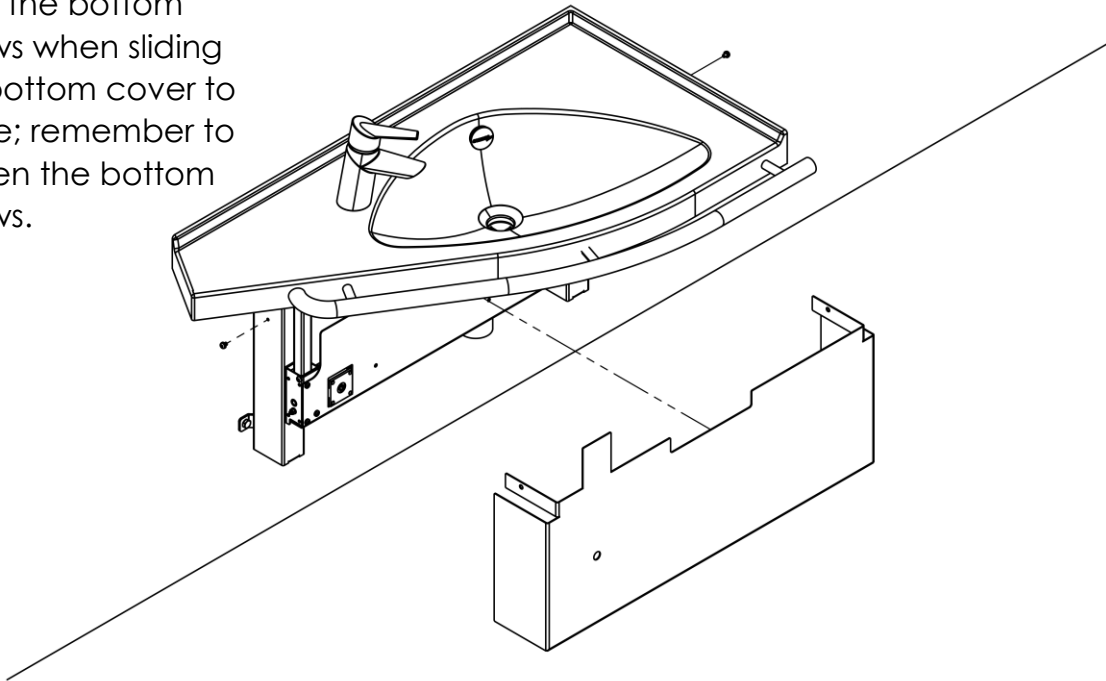

8. Install the top cover.

IMPORTANT NOTICE!
You may omit this
side screw if the
screw cannot be
reached.

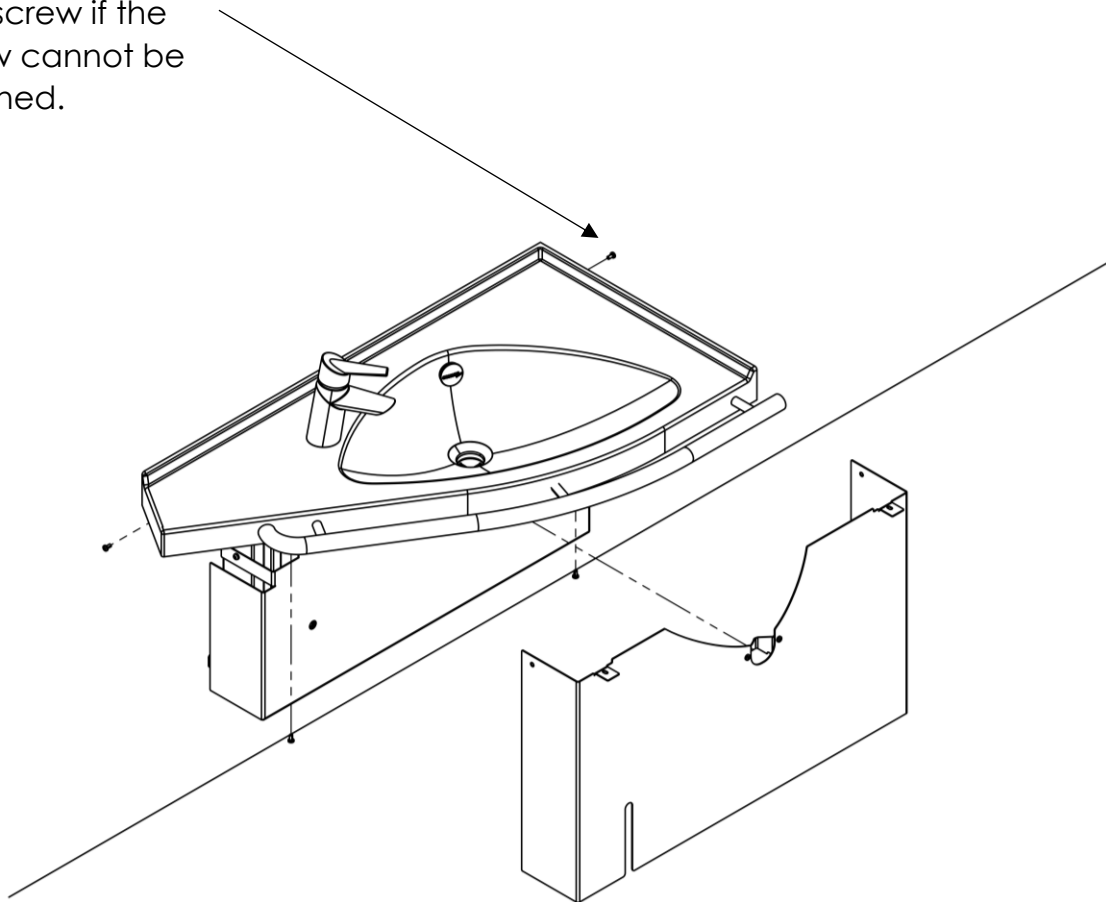

9. Install the crank and perform a final test of the unit

