

17782 wall drain
17783 floor drain

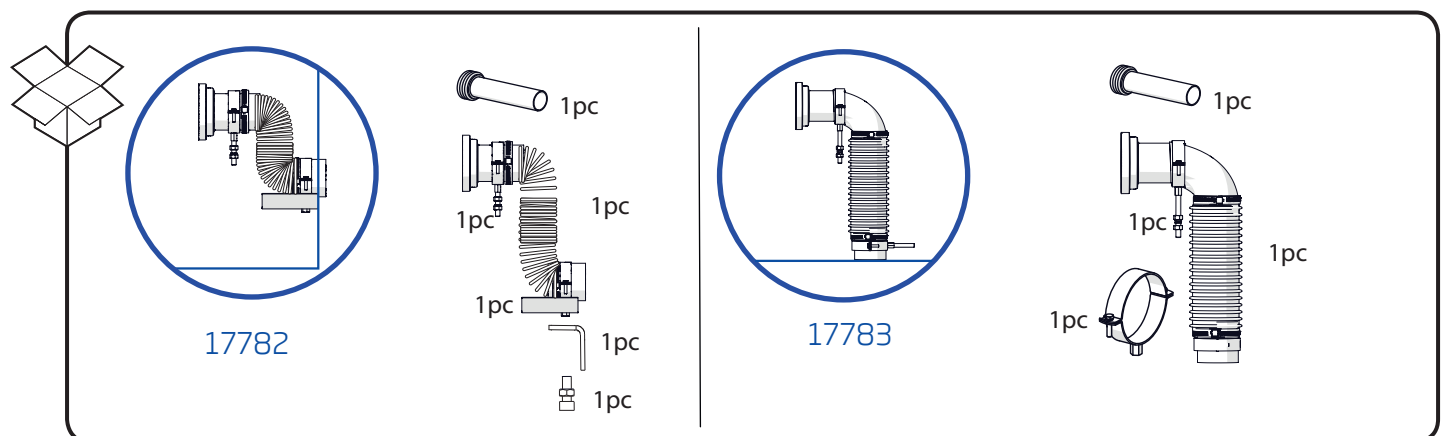

Gaius DUO,

Attachment points, 8 pcs
Seinäkiinnitys 8 kpl
17782, 17783
17785, 17786

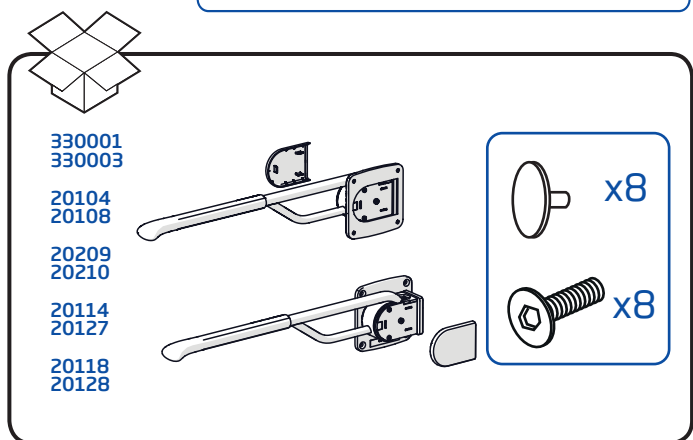
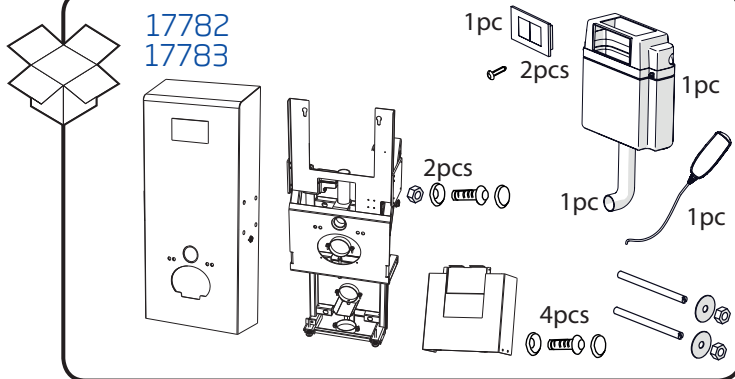
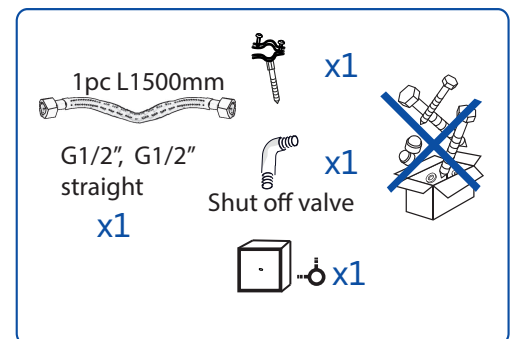
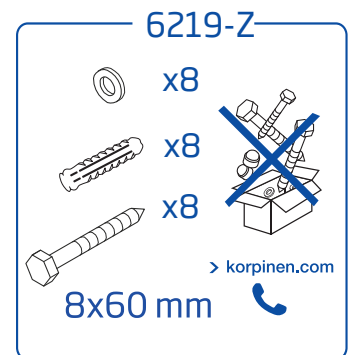
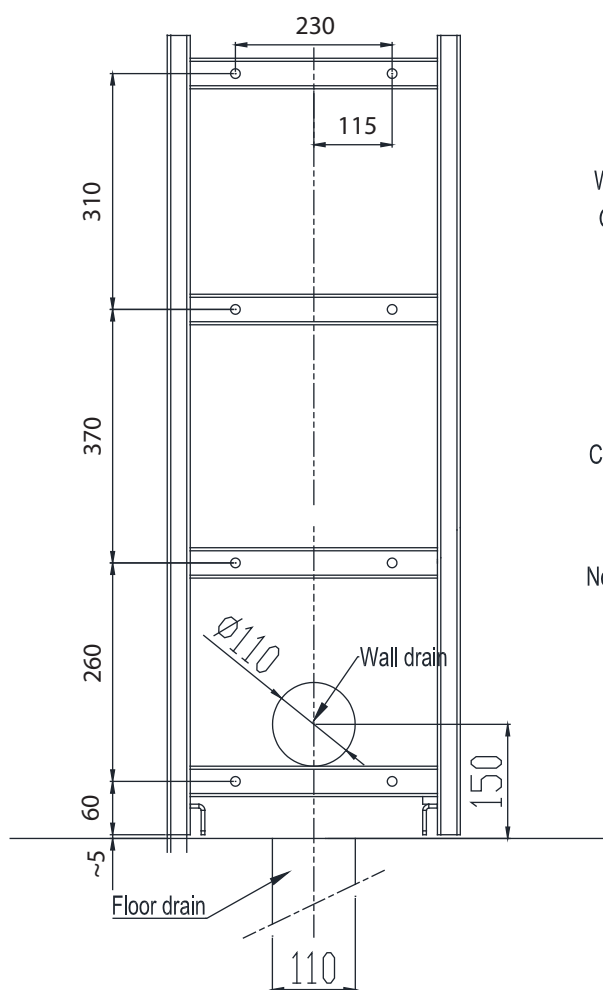

Gaius DUO,

Water and electric
Vesi ja sähköpisteet
17782, 17783

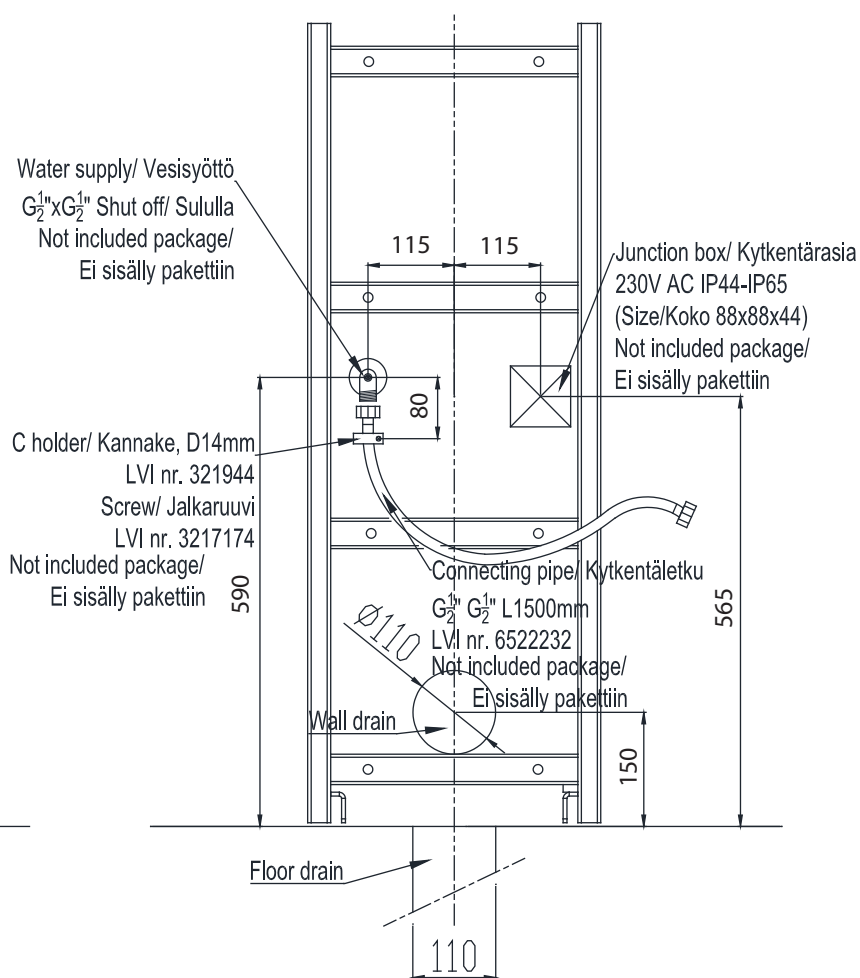

LVI nr. go to www.lvi-info.fi/en/product-search
and find LVI number "Search content"
LVI nr. mene www.lvi-info.fi/tuotehaku
ja etsi LVI-numerolla tuote

Notice!
 General instructions:
 Use motor up and down to help installation.
 If frame don't go down by motor, press moving frame by hand.

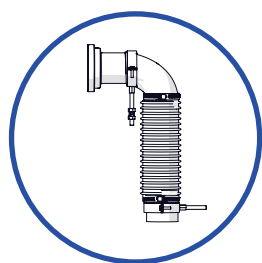
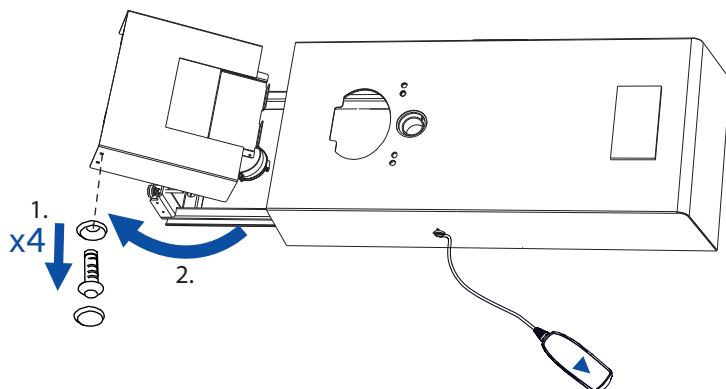

17783 floor drain

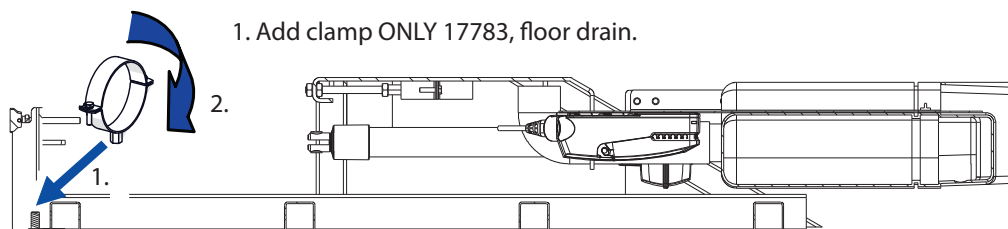

A Connect electricity:

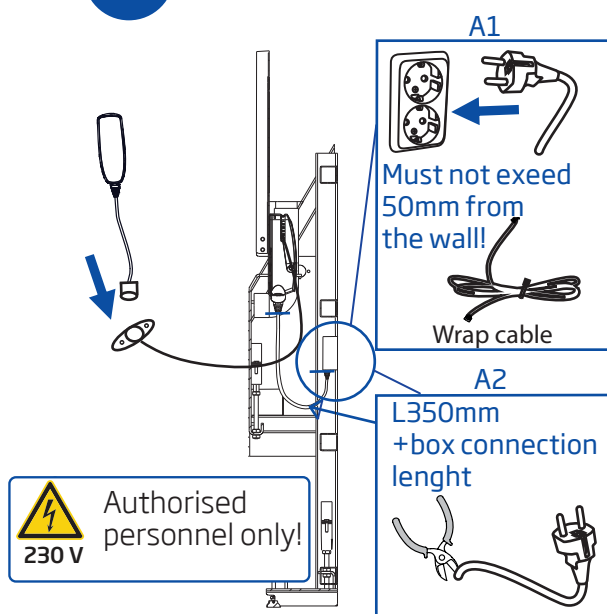

B Affix the frame to the wall:

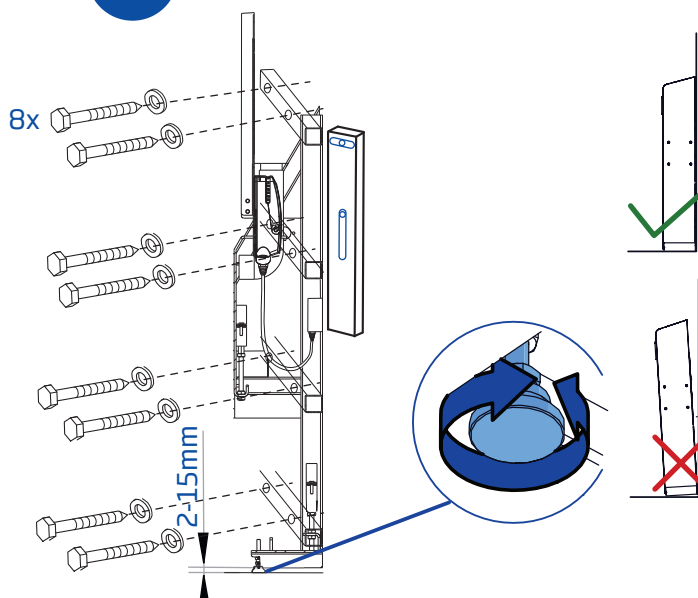

C Connect hose:

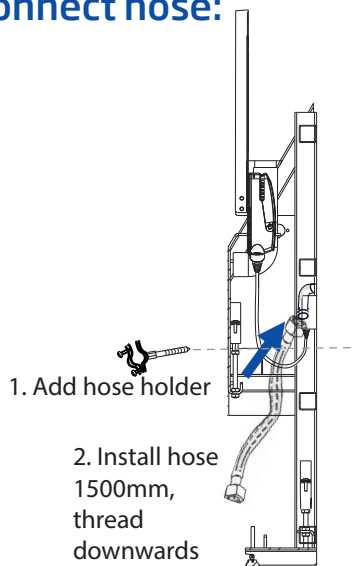

D Drain:

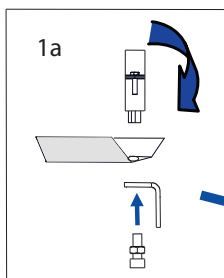
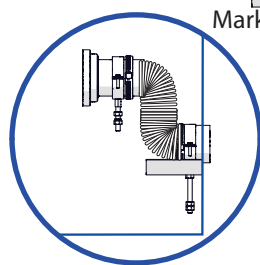

D1

Mark up

2a

2b

2a

1c

1b

D2

!

!

90°

E

Drain:

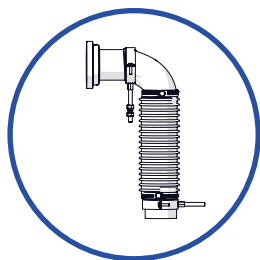

Mark up

1a

1b

2a

2b. Clamp

2a

F

1. Wrap motor cable
2. Add water pipe

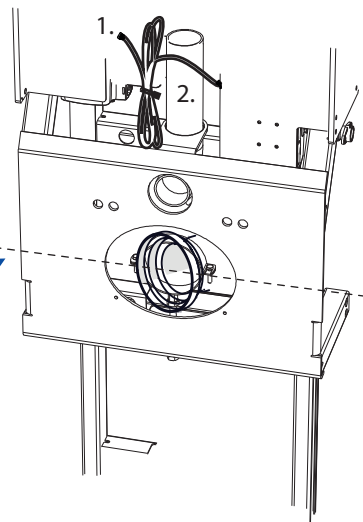

G

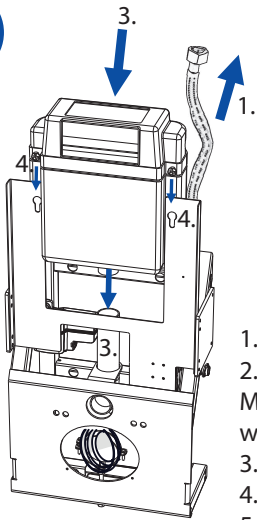

1. Pull out water hose, from right
2. See Gustavsberg Manual Instructions "Bushing pipes with Protective tube 18-28MM"
3. Add to water tank
4. Notice water pipe
5. Press water tank on it's place

G1

1. Water tank on it's place
2. Connect hose to water tank

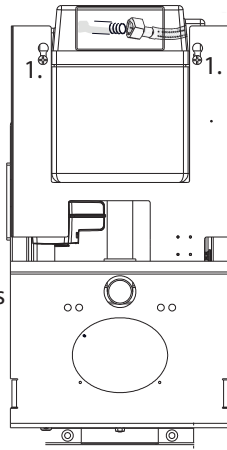

G2

1a. Tie water hose to clamp

1b. Tie water hose to clamp with ground wire ⊥

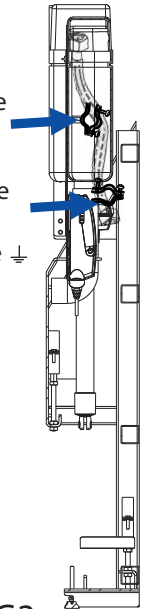

G3

H

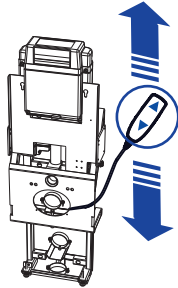

Testing up & down

Mind the water pipes and cables

I

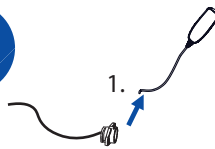

1. Disconnect hand control
2. Choose side to install hand control
3. Pop-up three pieces from cover A
4. Install plug on cover A

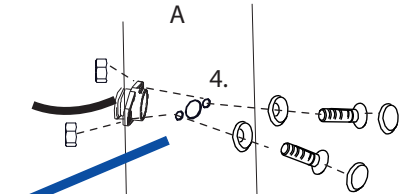
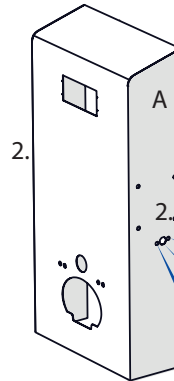

J

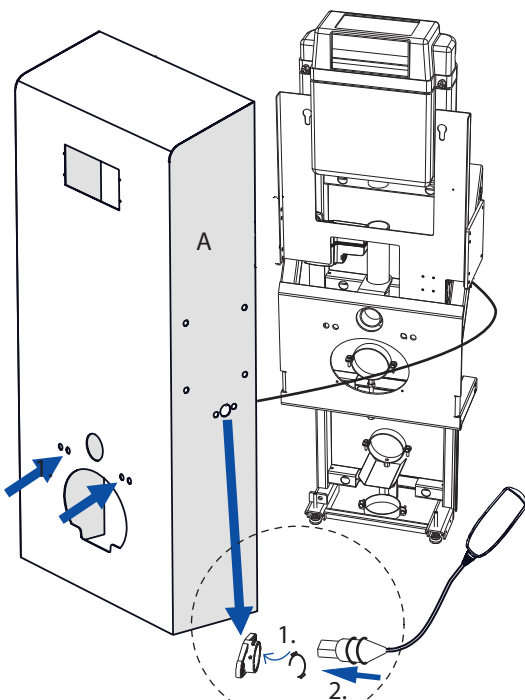

Add Lock ring inside(1)

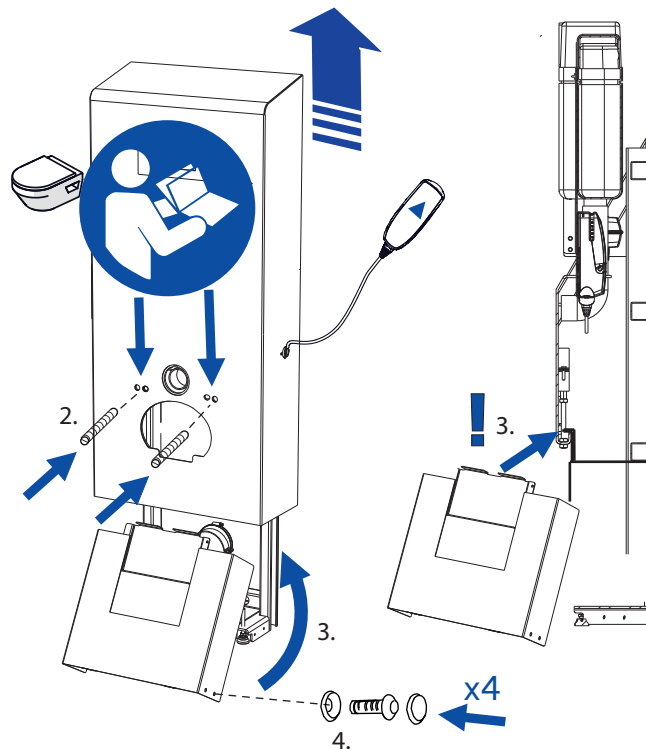

A Measure the pipe:

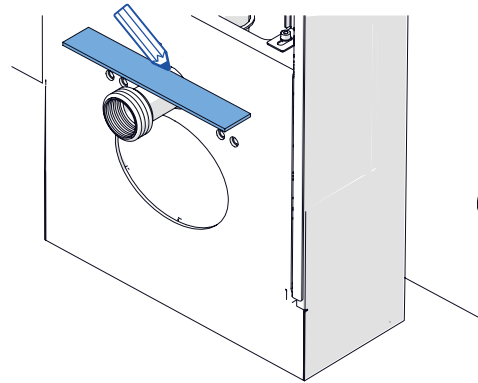
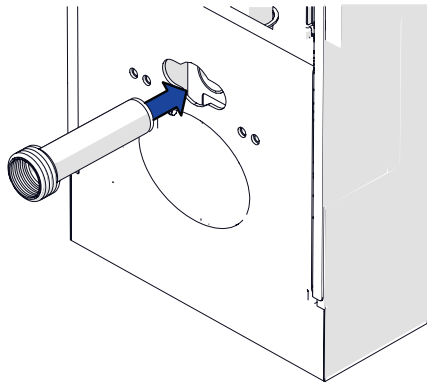
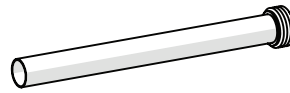

B

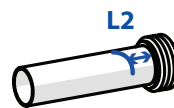
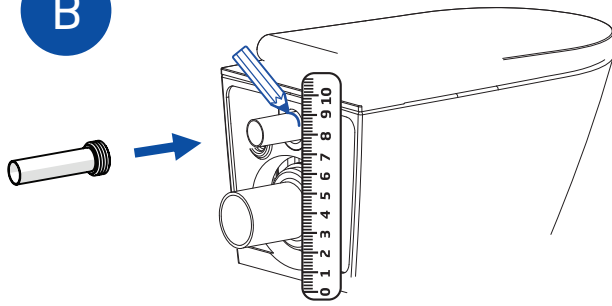

C

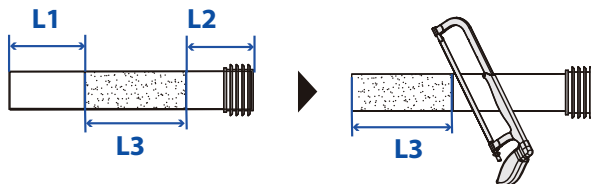

D

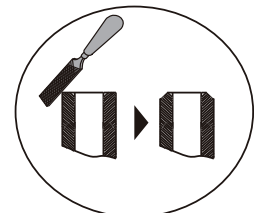

Mount the cover, seat and support rails:

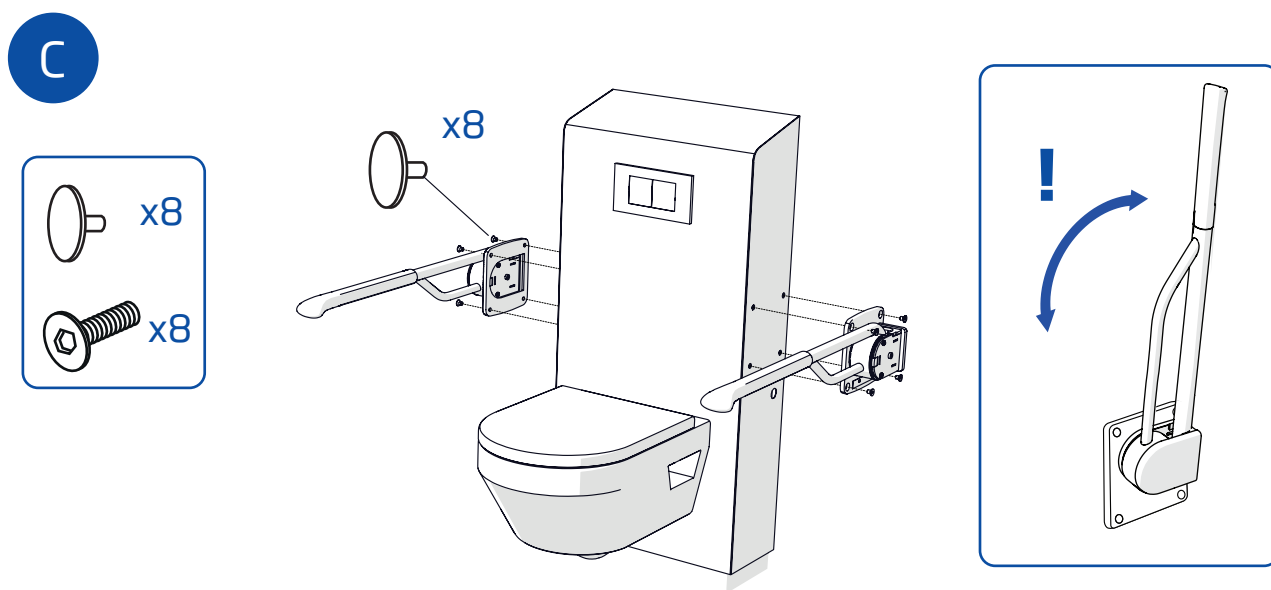
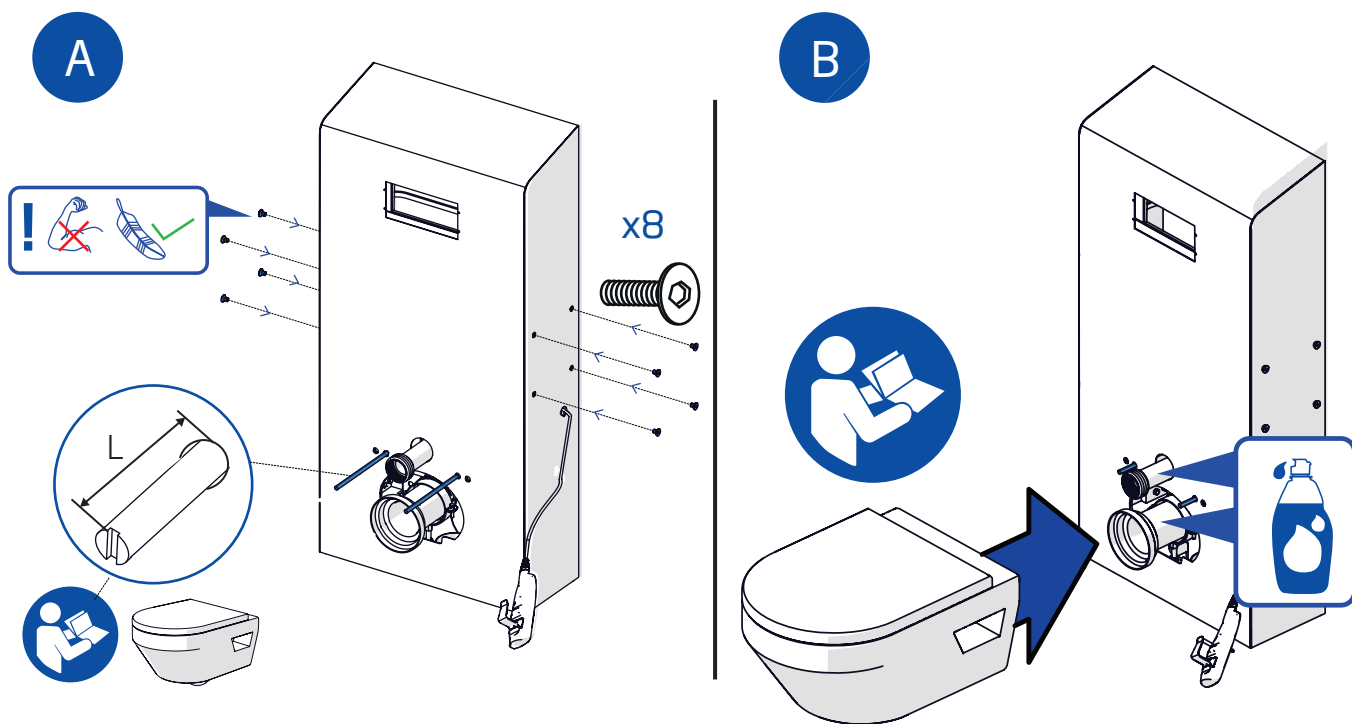

D Mount the toilet roll holder, remote control and push button:

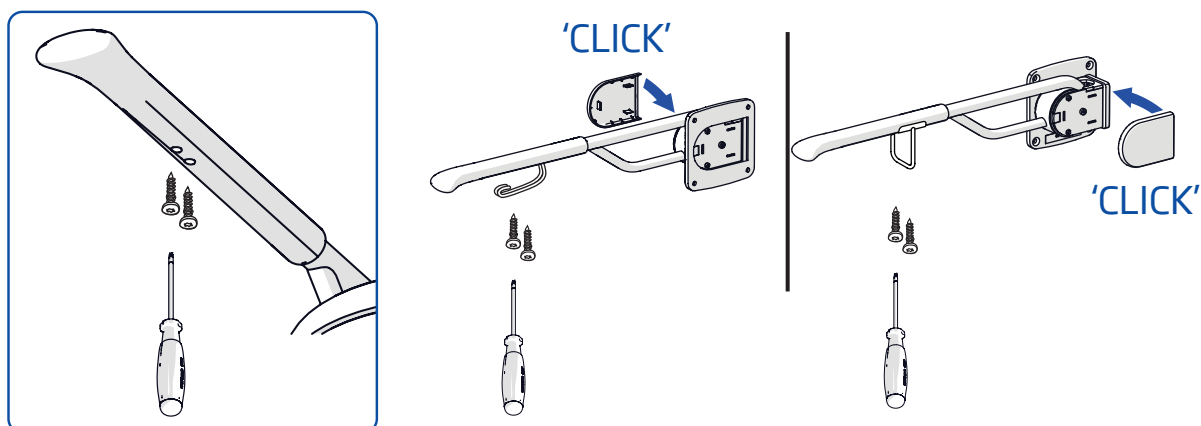

E1

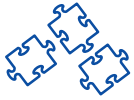

A

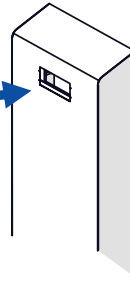
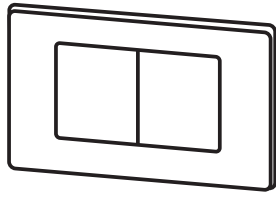

B

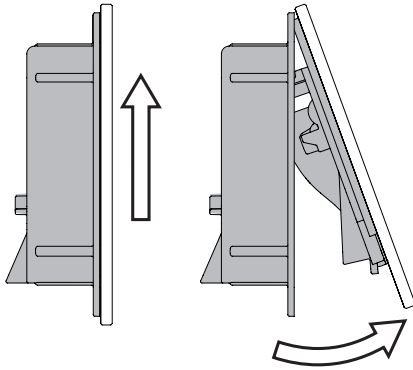

C

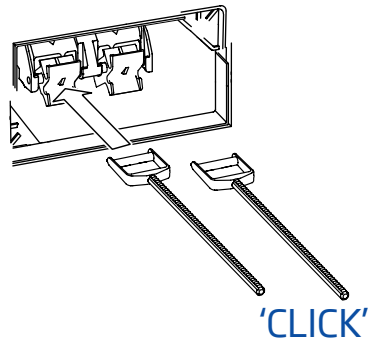

D

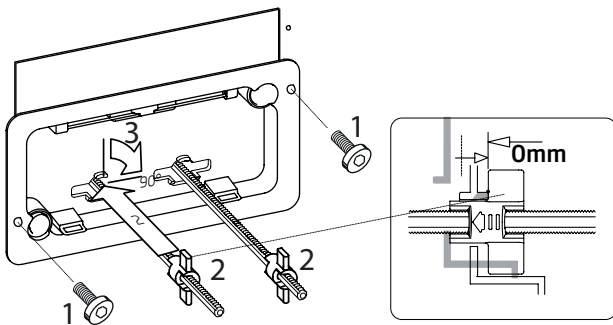

E

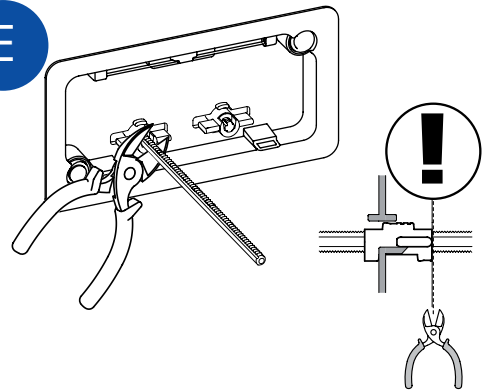

F

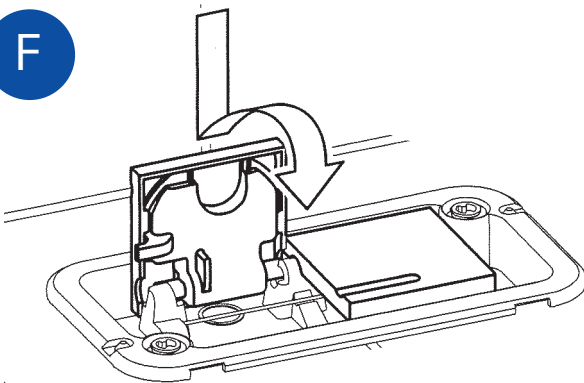

G

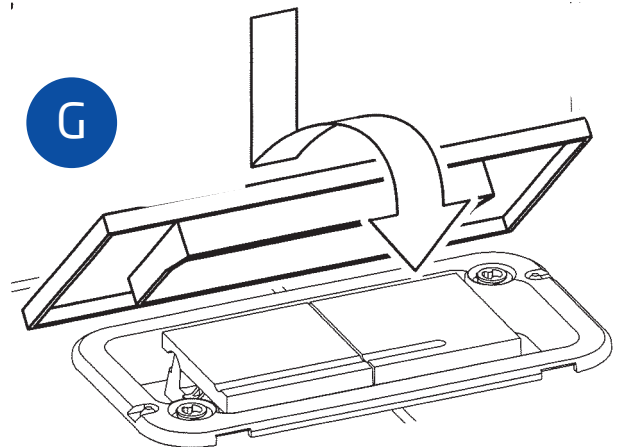

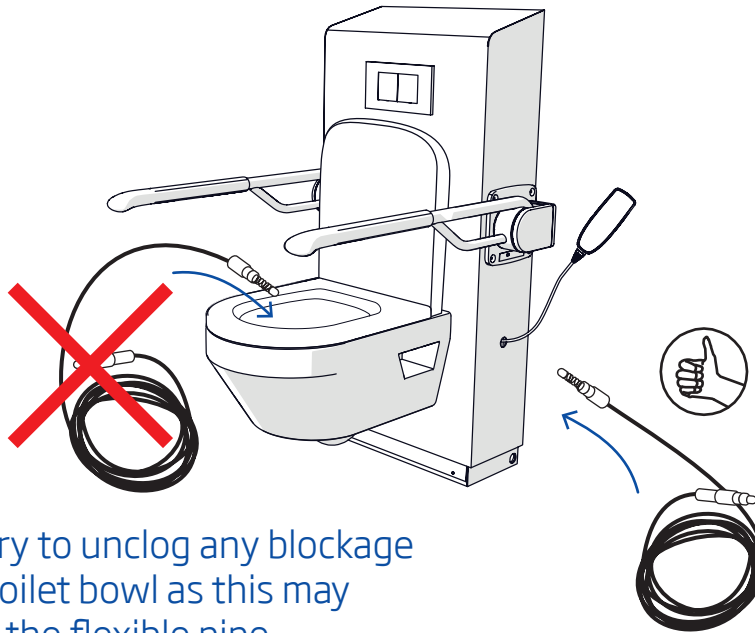

Do not try to unclog any blockage via the toilet bowl as this may damage the flexible pipe.

Always perform unclogging by moving the implement in the direction of the building's drain pipes.

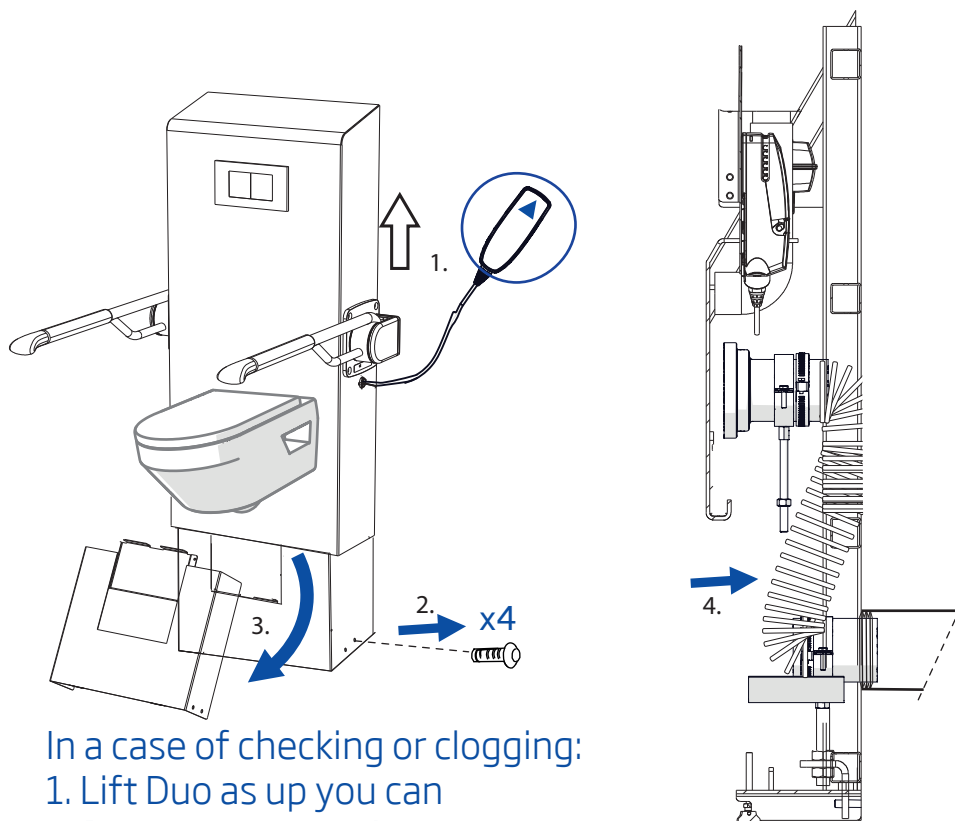

In a case of checking or clogging:
1. Lift Duo as up you can
2. Remove screws, 4 pcs
3. Remove under cover
4. Squeeze black drain pipe