

GAIUS PRODUCT GUIDE

GAIUS GUIDE PRODUCTS

BASINS	6
CABINETS	21
SEATS	30
SUPPORT RAILS	37
HANDRAILS	47
MIRROR CABINETS	57
MIRRORS	62
LIGHTS	63
SOAP DISPENSERS	67
CUP HOLDERS	67
PAPER TOWEL DISPENSERS, TOILET PAPER HOLDERS, TOILET BRUSH HOLDER	69
DUSTBINS	72
HOOKS AND BASKETS	74
TOOL HOLDERS AND DRYING RACKS	76
SOAP TRAYS	77
BABY CARE	78
HEIGHT-ADJUSTED TOILET SEAT	79

We have restricted rights in product and miscellaneous changes

BASINS

Elegant Gaius basins are made of durable and antimicrobial cast marble or composite material. Basins of composite material are seamless with fixed rails, with additional accent-colour strips to promote better spatial recognition. Basins of cast marble have a uniform rail which enables support from all angles. Wheelchair access is ensured by basin design.

Sense basin

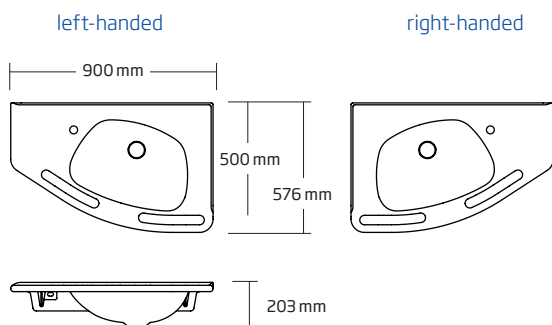

62022WAM right-handed



62022GAM right-handed



62022RAM right-handed

BASINS

GAIUS
CARE

Sense basin 900 x 576

Gaius Sense basins are made of a durable and antimicrobial composite material. The basin is seamless, with fixed rails in front to support standing and ease approach. The angle of the front rim ensures that splashes stay inside the basin. Additional accent-colour strips are available for the rails to promote better spatial recognition.

The basin design embodies the new European PMR standard, which requires 300 mm of empty space below to allow for wheelchair access. A toilet paper dispenser, a white pop-up drain plug, fixed water trap and mounting hardware are included with the basin. Right- and left-handed basins are available, classified by the direction of the tapered tail. The basin can also be customised to not include the overflow drain opening. The recommended mounting height is 800 mm.

Dimensions: W 900 mm x D 576 mm

With overflow

62023WAM	Sense basin, right-handed, white
62023GAM	Sense basin, right-handed, white, with grey accents
62023RAM	Sense basin, right-handed, white, with red accents

62034WAM	Sense basin, left-handed, white
62034GAM	Sense basin, right-handed, white, with grey accents
62034RAM	Sense basin, right-handed, white, with red accents

Without overflow

62022WAM	Sense basin, right-handed, white
62022GAM	Sense basin, right-handed, white, with grey accents
62022RAM	Sense basin, right-handed, white, with red accents
62033WAM	Sense basin, left-handed, white
62033GAM	Sense basin, right-handed, white, with grey accents
62033RAM	Sense basin, right-handed, white, with red accents

Additional equipment:

6233W	Height adjustment rails
6243	Crank height adjustment system
65133	Electric height adjustment
X300	Telescope pipe for water trap (suitable for manually height adjustable basins)
992600	Accordion pipe for water trap (for electrical and crank height adjustable basins)

Sense corner basin 840 x 840

Gaius Sense corner basins are made of a durable and antimicrobial composite material. The basin is seamless, with fixed rails in front to support standing and ease approach. The angle of the front rim ensures that splashes stay inside the basin. Additional accent-colour strips are available for the rails to promote better spatial recognition. The basin design embodies the new European PMR standard, which requires 300 mm of empty space below to allow for wheelchair access. A toilet paper dispenser, a white pop-up drain plug, fixed water trap and mounting hardware are included with the basin. The basin can be customised to not include the overflow drain opening.

The side width is 840 mm, with a 740 mm diagonal length from the corner to the front rim. The recommended mounting height is 800 mm.

Dimensions: W 840 mm x D 840 mm

With overflow

65001WAM	Sense corner basin, white
65001GAM	Sense corner basin, white, with grey accents
65001RAM	Sense corner basin, white, with grey accents

Without overflow

65000WAM	Sense corner basin, white
65000GAM	Sense corner basin, white, with grey accents
65000RAM	Sense corner basin, white, with grey accents

Additional Equipment:

6234W	Height adjustment rails
6244	Crank height adjustment system
65111	Electric height adjustment
X300	Telescope pipe for water trap (suitable for manually height adjustable basins)
992600	Accordion pipe for water trap (for electrical and crank height adjustable basins)

Sense corner basin

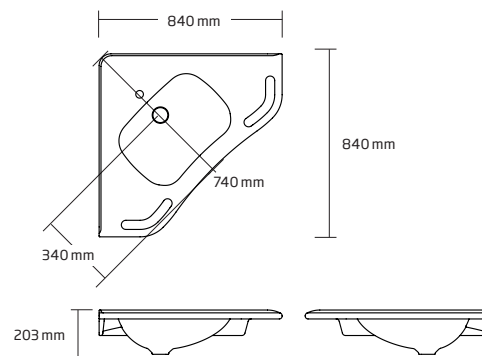

65000WAM



65000RAM



622703GAM

Gaius Sense basins colour choices:

	red RAL 3003		grey RAL 7037
--	-----------------	---	------------------

Sense Plus basin

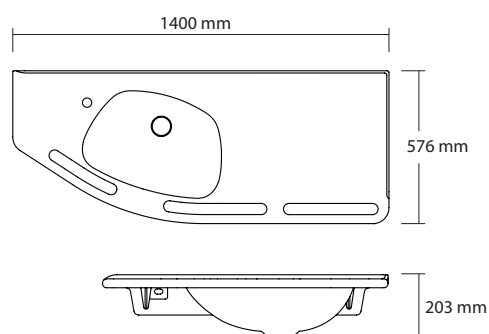

62082WAM left-handed



62082GAM left-handed

Sense Plus basin 1400 x 576

Gaius Sense Plus basins are made of a durable and antimicrobial composite material. The 1400 mm width provides a broad tabletop, with capacity to add a wall-mounted cabinet below the tapered end. The basin is seamless, with fixed rails in front to support standing and ease approach. The angle of the front rim ensures that splashes stay inside the basin. Additional accent-colour strips are available for the rails to promote better spatial recognition. The basin design embodies the new European PMR standard, which requires 300 mm of empty space below to allow for wheelchair access. A toilet paper dispenser, a white pop-up drain plug, fixed water trap and mounting hardware are included with the basin.

Right- and left-handed basins are available, classified by the direction of the tapered tail. The recommended mounting height is 800 mm.

Dimensions: W 1400 mm x D 576 mm

With overflow

62081WAM	Sense Plus basin, right-handed, white
62081GAM	Sense Plus basin, right-handed, white, with grey accents
62081RAM	Sense Plus basin, right-handed, white, with red accents
62082WAM	Sense Plus basin, left-handed, white
62082GAM	Sense Plus basin, left-handed, white, with grey accents
62082RAM	Sense Plus basin, left-handed, white, with red accents

Additional Equipment:

6234W	Height adjustment rails
6249	Crank height adjustment system
65155	Electric height adjustment
X300	Telescope pipe for water trap (height adjustment rails)
992600	Accordion pipe for water trap (for electrical and crank height adjustable basins)

Original basin 1000 x 500

Original basins are made of a durable and antimicrobial cast marble. The classic basin has fixed rails in front to support standing and ease approach. The angle of the front rim ensures that splashes stay inside the basin. Rails are available in different accent colours to promote better spatial recognition.

A toilet paper dispenser, wall brackets and fixed water trap are included with the basin. Mounting hardware is sold separately. Manual and electronic height adjustments and bidé showerheads are available for the model.

Original basin and rails sustain 230 kg of weight (VTT (RTE 3664/01)). Right- and left-handed basins are available, classified by the direction of the tapered tail. The recommended mounting height is 800 mm.

Dimensions: W 1000 mm x D 500 mm
(overall depth to the outer edge of the rail 570 mm)

With overflow

6202WAM Original basin, right-handed, white, white rail
6202GAM Original basin, right-handed, white, grey rail
6202RAM Original basin, right-handed, white, red rail

6203WAM Original basin, left-handed, white, white rail
6203GAM Original basin, left-handed, white, grey rail
6203RAM Original basin, left-handed, white, red rail

Handrails with rounded rail ends

With overflow

6202WCAM Original basin, right-handed, white, white rail
6202GCAM Original basin, right-handed, white, grey rail
6202RCAM Original basin, right-handed, white, red rail

6203WCAM Original basin, left-handed, white, white rail
6203GCAM Original basin, left-handed, white, grey rail
6203RCAM Original basin, left-handed, white, red rail

Additional equipment:

6232W Height adjustment rails
6236N Crank height adjustment system
6513N Electric height adjustment
X300 Telescope pipe for water trap (suitable for manually height adjustable basins)
992600 Accordion pipe for water trap (for electrical and crank height adjustable basins)

The fastening accessories are sold separately

Original basin

left-handed

right-handed

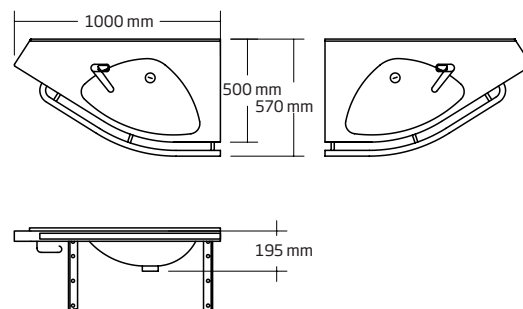

6202WAM right-handed



6202RAM right-handed



6202GCAM right-handed

Colour choices for rails:



white
RAL 9016



grey
RAL 7037



red
RAL 3003

RST rail to order

Plus basin

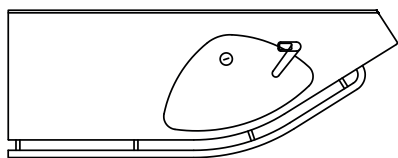

right-handed

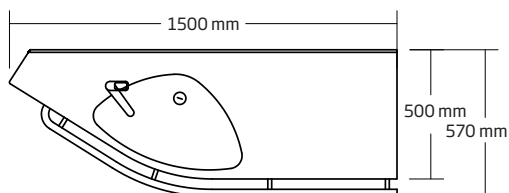

left-handed



62001WAM right-handed

Public basin

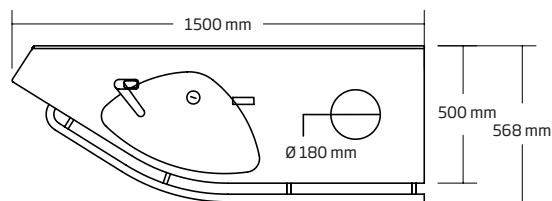

left-handed

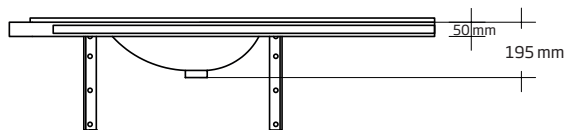

62012SSAM right-handed



62015SSAM left-handed

Plus basin 1500 x 500

The Plus basin features all the same qualities as the Original basin, but with a tapered end for additional storage space.

Dimensions: W 1500 mm x D 500 mm
(overall depth to the outer edge of the rail 570 mm)

With overflow

62001WAM Plus basin, right-handed, white, white rail
62001GAM Plus basin, right-handed, white, grey rail
62001RAM Plus basin, right-handed, white, red rail

62011WAM Plus basin, left-handed, white, white rail
62011GAM Plus basin, left-handed, white, grey rail
62011RAM Plus basin, left-handed, white, red rail

Public basin 1500 x 500

The durable and antimicrobial composite material of Public basins makes them idea for bathroom conditions. The basin is seamless, with fixed rails in front to support standing and ease approach. Basins are available in both dark granite and white. The Gaius Public lower cabinet with a waste bin included complements the waste hole in the tapered end of the basin. A toilet paper dispenser, wall brackets and fixed water trap are included with the basin. The recommended mounting height is 800 mm

Dimensions: W 1500 mm x D 500 mm
(overall depth to the outer edge of the rail 568 mm)

With overflow

62012SSAM Public basin, right-handed, grey granite with stainless steal hand rail and waste hole
62013SSAM Public basin, left-handed, grey granite with stainless steal hand rail and waste hole
62014SSAM Public basin, right-handed, white, with stainless steal handrail and waste hole
62014WAM Public basin, right-handed, white, white handrail, with waste hole
62014GAM Public basin, right-handed, white, grey handrail, with waste hole
62014RAM Public basin, right-handed, white, red handrail, with waste hole
62015SSAM Public basin, left-handed, white, with stainless steal handrail and waste hole
62015WAM Public basin, left-handed, white, white handrail, with waste hole
62015GAM Public basin, left-handed, white, grey handrail, with waste hole
62015RAM Public basin, left-handed, white, red handrail, with waste hole

Additional equipment:

6232W Height adjustment rails
6240N Crank height adjustment system
6515N Electric height adjustment
X300 Telescope pipe for water trap (suitable for manually height adjustable basins)
992600 Accordion pipe for water trap (for electrical and crank height adjustable basins)

The fastening accessories are sold separately

Mini basin 800 x 400

Due to its compact size, the antimicrobial Mini basin is most suitable for small bathrooms. The basin features all the same qualities as the Original basin. A toilet paper dispenser, wall brackets and fixed water trap are included with the basin. The recommended mounting height is 800 mm.

Dimensions: W 800 mm x D 400 mm
(overall depth to the outer edge of the rail 470 mm)

6302WAM	Mini basin, right-handed, white, white rail
6302GAM	Mini basin, right-handed, white, grey rail
6302RAM	Mini basin, right-handed, white, red rail
6303WAM	Mini basin, left-handed, white, white rail
6303GAM	Mini basin, left-handed, white, white rail
6303RAM	Mini basin, left-handed, white, red rail

Additional equipment:

6232W	Height adjustment rails
6241N	Crank height adjustment system
65161	Electric height adjustment
X300	Telescope pipe for water trap (suitable for manually height adjustable basins)
992600	Accordion pipe for water trap (for electrical and crank height adjustable basins)

The fastening accessories are sold separately

Mini basin

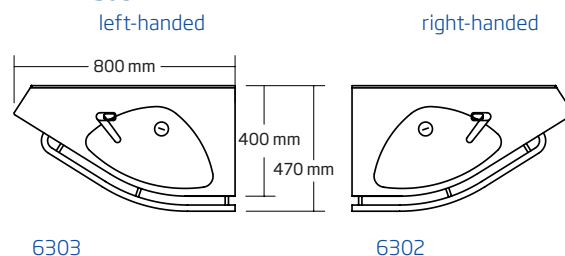

6302WAM right-handed

Colour choices for rails:



white
RAL 9016



grey
RAL 7037



red
RAL 3003

Hospital basin

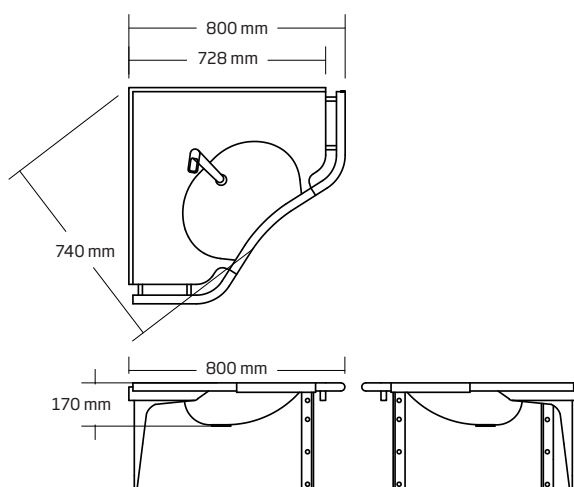

6500RAM



6502GAM

Colour choices for rails:



red
RAL 3003



grey
RAL 7037

Hospital basin 800 x 800

The Hospital basin has fixed rails on both sides to support standing and ease approach. The rounded front edge combined with the side rails, with an anti-microbial elastomeric coating, form a uniform support rail. Hospital basins are made of a durable and antimicrobial cast marble.

Manual or electric height adjustments are available for the model. Side length including rails is 800 mm, and depth from the front in 740 mm. Handrails can support up to 160 kg. A toilet paper dispenser, wall brackets and fixed water trap are included with the basin. The recommended mounting height is 800 mm.

Dimensions: W 800 mm x D 800 mm

6502GAM Hospital basin, white, grey rails with elastomeric coating

6500RAM Hospital basin, white, red rails with elastomeric coating

Hospital basin without overflow, special order product, 6-8 week delivery time

6519GAM Hospital basin, white, grey rails with elastomeric coating

6517RAM Hospital basin, white, red rails with elastomeric coating

Additional equipment:

6232W Height adjustment rails

6237N Crank height adjustment system

6511N Electric height adjustment

X300 Telescope pipe for water trap (suitable for manually height adjustable basins)

992600 Accordion pipe for water trap (for electrical and crank height adjustable basins)

The fastening accessories are sold separately

Ergomedic Surgery basin

The Ergomedic Surgery basin is specifically designed for operating room use. The basin is made of CreaCore® antimicrobial composite material, which makes it durable and hygienic. Fixed water trap and mounting hardware are also included. The recommended mounting height is 800 mm.

Dimensions: W 810 mm x D 600 mm x H 940 mm

- 622600 Surgery basin with two Dispenso dispensers
- 622601 Surgery basin without Dispenso dispensers
- 622602 Surgery basin with faucet and mixer

Ergomedic Doctor One M basin

The Ergomedic Doctor M basin is made of CreaCore® antimicrobial composite material, which makes it durable and hygienic. Two Dispenso dispensers and mounting hardware are included. The basin has a maintenance hatch. A fixed water seal and mounting hardware are included, but the faucet and mixer are not.

Dimensions: W 400 mm x D 499 mm x H 1319

- 622501 Doctor One M basin, with mirror and two Dispenso dispensers
- 622501LED Doctor One M-basin, with mirror, LED light and two Dispenso dispensers
- 622502 Doctor One M-basin, with mirror, without Dispenso dispensers
- 622502 Doctor One M-basin, with mirror and LED light, without Dispenso dispensers
- 622503 Doctor One M basin, with mirror and with faucet and mixer and Dispenso dispensers
- 622503LED Doctor One M-basin, with mirror and LED light

Baby bath basin

The antimicrobial cast marble basin is designed for bathing infants. Height adjustment vertically is facilitated by a gas spring that allows the basin to move 200 mm, with a maximum usage height of 1050 mm. Fixed water trap and mounting hardware included.

Dimensions: W 476 mm x H 1050 mm x D 980 mm

- 68100 Baby bath basin, white, with height adjustment

Niche basin

The Niche basin is ideal for hospital or health clinic patient rooms or in hall-way alcoves.

Dimensions: W 600 mm x D 920 x H 312 mm

- 622700 Niche basin

Niche basin door

Dimensions: W 598 mm x D 14 mm x H 540 mm

- 622701 Niche basin door, right-handed
- 622702 Niche basin door, left-handed

Ergomedic Surgery



622602

Ergomedic Doctor M



622503

Baby bath basin



68100

Niche basin



622700

Water tap is not supplied.

Lyon basin



6406AM

Aino basin

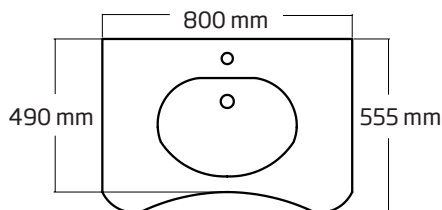

6400AM

Luna basin



6510AM

GAIUS
PUBLIC

Lyon basin

Lyon basins are made of a durable and antimicrobial cast marble. The basin is suitable for a variety of operational environments, including public bathrooms, patient rooms, reception areas and for home. This versatility derives from the hygienic and elegant design. A fixed water trap and mounting hardware are included. The recommended mounting height is 800 mm.

Dimensions: W 598 mm x D 525 mm x H 164 mm

6406AM Lyon basin, no railing, the height of the front edge of the basin is 100 mm

Aino basin 800 x 555

Aino basins are made of durable and antimicrobial cast marble. The basin is specially designed for wheelchair patients in cooperation with the Käpylä Rehabilitation Centre SYNAPSIA of the Finnish Association for the Disabled. Its design includes sufficient leg space and plenty of tabletop space for elbow support. The Aino basin is suitable for both homes and public bathrooms, as it is easy to clean and hygienic.

A toilet paper dispenser, fixed water trap and wall brackets are included. Mounting hardware sold separately. The recommended mounting height is 800 mm.

Dimensions: W 800 mm x D 555 mm

6400AM Aino basin, white, low bottom

Additional equipment:

- | | |
|--------|---|
| 6232W | Height adjustment rails |
| 6239N | Crank height adjustment system |
| 6516N | Electric height adjustment |
| X300 | Telescope pipe for water trap (suitable for manually height adjustable basins) |
| 992600 | Accordion pipe for water trap (for electrical and crank height adjustable basins) |

The fastening accessories are sold separately

Luna basin 390 x 270

The Luna basin is designed for hospital use, and thus features no overflow. Also works as a bidet basin. Right- and left-handed basins are available, classified by the location of the faucet. A fixed water trap and mounting hardware are included.

Dimensions: W 390 mm x D 270 mm x H 90 mm

- | | |
|--------|--------------------------------|
| 6509AM | Right-handed, without overflow |
| 6510AM | Left-handed, without overflow |

Life basin 600 / 700 / 900 / 1200

Life basins are antimicrobial cast marble with a modern design, making them an ideal addition to bathrooms in private homes. The fixed rails support standing and ease approach and, if necessary, can also be used as towel racks. The recommended mounting height is 800 mm.

Dimensions: W 600 mm x D 400 mm
(overall depth to the outer edge of the rail 470 mm)

- 6720CAM Life basin with straight chrome handrail
- 6721CAM Life basin, right-handed with L-shaped chrome rail
- 6722CAM Life basin, left-handed with L-shaped chrome rail

Dimensions: W 700 mm x D 490 mm
(overall depth to the outer edge of the rail 560 mm)

- 6700CAM Life basin with straight chrome handrail
- 6701SSAM Life basin with straight stainless steel rail
- 6702SSAM Life basin, right-handed with L-shaped stainless steel rail
- 6703SSAM Life basin, left-handed with L-shaped stainless steel rail

Dimensions: W 900 mm x D 490 mm
(overall depth to the outer edge of the rail 560 mm)

- 6706SSAM Life basin, right-handed straight stainless steel rail
- 6707SSAM Life basin, left-handed straight stainless steel rail
- 6708CAM Life basin, right-handed with straight chrome handrail
- 6709CAM Life basin, left-handed with straight chrome handrail

Dimensions: W 1200 mm x D 490 mm
(overall depth to the outer edge of the rail 560 mm)

- 6710CAM Life basin, right-handed with straight chrome handrail
- 6711CAM Life basin, left-handed with straight chrome handrail

Additional equipment:

The fastening accessories are sold separately.
See the Life cabinets on page 27

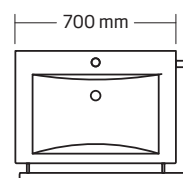

right-handed
6702

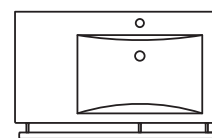

right-handed
6706/6708

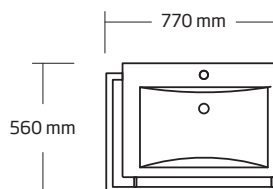

left-handed
6703

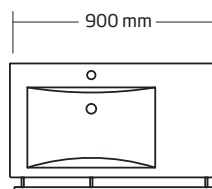

left-handed
6707/6709

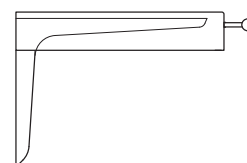

6703SSAM



6708CAM



6721CAM

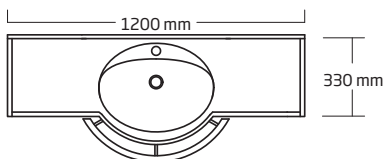
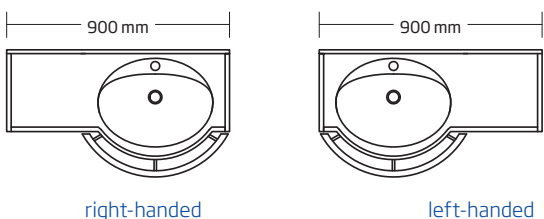
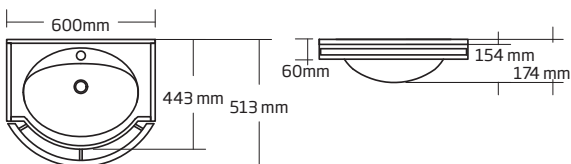

6401RAM



6402GAM right-handed



6404WAM

Colour choices for rails:



white
RAL 9016



grey
RAL 7037



red
RAL 3003

GAIUS
LIFE

Senior basin 600 / 750 / 900 / 1200 x 443

The classically styled Senior basin is made of antimicrobial cast marble, making it an ideal addition to bathrooms in private homes. The load bearing capacity of the fixed rails is 240 kg. The recommended mounting height is 800 mm.

Dimensions: W 600 mm x D 443 mm

(overall depth to the outer edge of the rail 513 mm)

6401WAM	Senior basin, white, with white rail
6401GAM	Senior basin, white, with grey rail
6401RAM	Senior basin, white, with red rail
6401CAM	Senior basin, white, with chrome rail

Dimensions: W 750 mm x D 443 mm

(overall depth to the outer edge of the rail 513 mm)

6407WAM	Senior basin, white, with white rail
6407GAM	Senior basin, white, with grey rail
6407RAM	Senior basin, white, with red rail
6407CAM	Senior basin, white, with chrome rail

Dimensions: W 900 mm x D 443 mm

(overall depth to the outer edge of the rail 513 mm)

6402WAM	Senior basin, right-handed, white, with white rail
6402GAM	Senior basin, right-handed, white, with grey rail
6402RAM	Senior basin, right-handed, white, with red rail
6402CAM	Senior basin, right-handed, white, with chrome rail
6403WAM	Senior basin, left-handed, white, with white rail
6403GAM	Senior basin, left-handed, white, with grey rail
6403RAM	Senior basin, left-handed, white, with red rail
6403CAM	Senior basin, left-handed, white, with chrome rail

Dimensions: W 1200 mm x D 443 mm

(overall depth to the outer edge of the rail 513 mm)

6404WAM	Senior basin, white, with white rail
6404GAM	Senior basin, white, with grey rail
6404RAM	Senior basin, white, with red rail
6404CAM	Senior basin, white, with chrome rail

Additional Equipment:

6232W	Height adjustment rails
6238N	Crank height adjustment system
6514N	Electric height adjustment
X300	Telescope pipe for water trap (suitable for manually height adjustable basins)
992600	Accordion pipe for water trap (for electrical and crank height adjustable basins)

The fastening accessories are sold separately

See the Senior cabinets on page 28

BASIN HEIGHT ADJUSTMENT OPTIONS

Height adjustment rails

Recommended for places where height adjustment is needed rarely.

- | | |
|----------|--|
| 6232W x2 | Height adjustment rails suitable for the Original, Mini, Aino and Senior basins, height adjustment range is 180 mm |
| 6232W x3 | Height adjustment rails suitable for the Public, Plus and Hospital basins, height adjustment range is 180 mm |
| 6233W | Height adjustment rails suitable for the Sense basins 900 mm, height adjustment range is 200 mm |
| 6234W | Height adjustment rails suitable for the Sense corner basin and Sense Plus basins, height adjustment range is 200 mm |

Crank height adjustment system

(Special order product, delivery time 6 weeks)

The crank height adjustment system allows for smooth and easy customisation via a removable hand crank. Height adjustment range is 200 mm. All metal parts coated with antimicrobial polymer paint.

- | | |
|-------|--|
| 6236N | Crank height adjustment system for the Original basin |
| 6237N | Crank height adjustment system for the Hospital basin |
| 6238N | Crank height adjustment system for the Senior basin |
| 6239N | Crank height adjustment system for the Aino basin |
| 6240N | Crank height adjustment system for the Plus and Public basin |
| 6241N | Crank height adjustment system for the Mini basin |
| 6243 | Crank height adjustment system for the Sense basin 900 mm |
| 6244 | Crank height adjustment system for the Sense corner basin |
| 6249 | Crank height adjustment system for the Sense Plus |

Electric height adjustment

Height range is 160 mm (special order product, delivery time 4 weeks).

- | | |
|-------|--|
| 6511N | Electric height adjustment for the Hospital basin |
| 6513N | Electric height adjustment for the Original basin |
| 6514N | Electric height adjustment for the Senior basin |
| 6515N | Electric height adjustment for the Plus and Public basin |
| 65161 | Electric height adjustment for the Mini basin |
| 6516N | Electric height adjustment for the Aino basin |
| 65111 | Electric height adjustment for the Sensecorner basin |
| 65133 | Electric height adjustment for the Sense basin 900 mm |
| 65155 | Electric height adjustment for the Sense Plus basin |

Additional equipment:

- | | |
|--------|---|
| X300 | Telescope pipe for water trap (suitable for manually height adjustable basins) |
| 992600 | Accordion pipe for water trap (for electrical and crank height adjustable basins) |
| 6223 | Water trap wall junction part 90° |

Mounting set

- | | |
|--------|--|
| 6216-Z | 12 acid-proof screws, base plates, wall plugs and caps for fixed Public and Plus table top basins and Hospital corner basins |
| 6218-Z | 8 acid-proof screws, base plates, wall plugs and caps for fixed Original, Aino, Mini and Senior, Life basins |
| 17500 | 100 acid-proof screws, base plates, wall plugs and caps |



6232W Height adjustment rails



Crank height adjustment system

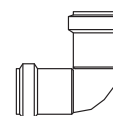
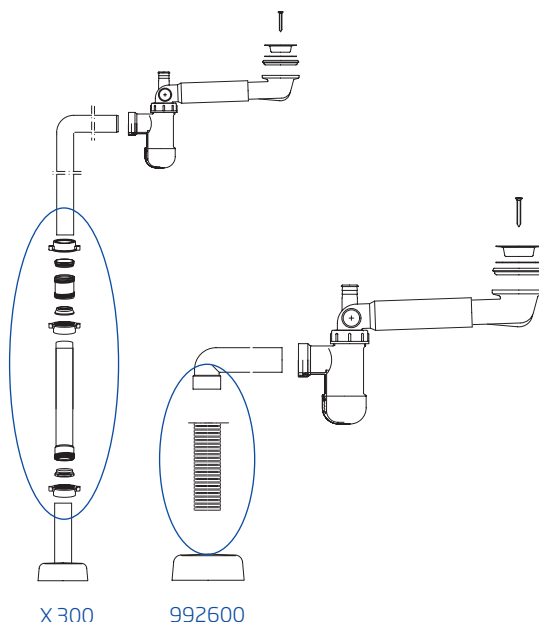

6223

CABINETS

Stylish Gaius cabinets are designed to withstand active use and humid bathroom conditions. The range includes a variety of storage, hand towel and soap dispenser options. Functionality of the bathroom is maximised with a correctly chosen cabinet. Special requirements of a location determine the customisation necessary.

CABINETS

High Gaius cabinets

Gaius cabinets are customisable to different individual needs. The wall-mounted cabinets ease cleaning in humid bathroom conditions. The white moisture-resistant melamine frame ensures longevity in active use. The doors are made of high-pressure laminate with additional grey accent strips along the edges to promote spatial recognition. Orientation of the doors is changeable.

The cabinet can be customised to include a lock hole, suitable for an Abloy or cabinet lock. Such modification requires identification of preferred door orientation with order.

Gaius cabinet 6300

The cabinet frame is white, moisture-resistant 16 mm melamine, which ensures longevity in active use. The cabinet model 6300 consists of two stationary shelves, handrail, with a pull-out laundry basket and drawer. The cabinet includes a fixed enclosing that can be fitted with an electrical outlet. The doors are made of high-pressure laminate with additional grey accent strips along the edges to promote spatial recognition. Orientation of the doors is changeable.

Dimensions: W 400 mm x H 1800 mm x D 500 mm

- 6300W Storage cabinet with white handrail
- 6300G Storage cabinet with grey rail
- 6300R Storage cabinet with red rail

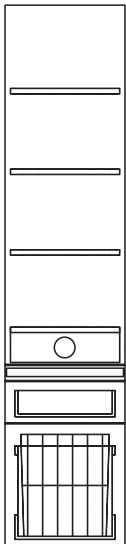

From the front, without door
W 400/H 1800/D 500



6300R

Colour choices for rails



white
RAL 9016



grey
RAL 7037



red
RAL 3003



6309



6313



6314



6315G

GAIVS
CARE

Gaius cabinet 6309

The cabinet frame is white, moisture-resistant 16 mm melamine, which ensures longevity in active use. The cabinet model 6309 consists of two stationary shelves with a pull-out laundry basket and drawer. The cabinet includes a fixed enclosing that can be fitted with an electrical outlet. The doors are made of high-pressure laminate with additional grey accent strips along the edges to promote spatial recognition. Orientation of the doors is changeable.

Dimensions: W 400 mm x H 1800 mm x D 500 mm

6309 Storage cabinet

Gaius cabinet 6313

The cabinet frame is white, moisture-resistant 16 mm melamine, which ensures longevity in active use. The cabinet model 6313 consists of four stationary shelves. The cabinet includes a fixed enclosing that can be fitted with an electrical outlet. The doors are made of high-pressure laminate with additional grey accent strips along the edges to promote spatial recognition. Orientation of the doors is changeable.

Dimensions: W 400 mm x H 1800 mm x D 500 mm

6313 Storage cabinet

Gaius cabinet 6314

The cabinet frame is white, moisture-resistant 16 mm melamine, which ensures longevity in active use. The cabinet model 6314 consists of four stationary shelves. The cabinet includes a fixed enclosing that can be fitted with an electrical outlet. The doors are made of high-pressure laminate with additional grey accent strips along the edges to promote spatial recognition. Orientation of the doors is changeable.

Dimensions: W 400 mm x H 1800 mm x D 500 mm

6314 Storage cabinet

Gaius cabinet 6315

The cabinet frame is white, moisture-resistant 16 mm melamine, which ensures longevity in active use. The cabinet model 6315 consists of two stationary shelves, handrail, with a pull-out laundry basket and drawer. The cabinet includes a fixed enclosing that can be fitted with an electrical outlet. The doors are made of high-pressure laminate with additional grey accent strips along the edges to promote spatial recognition. Orientation of the doors is changeable.

Dimensions: W 400 mm x H 1800 mm x D 500 mm

6315W Storage cabinet with white support rail

6315G Storage cabinet with grey support rail

6315R Storage cabinet with red support rail

Gaius cabinet 6316

The cabinet frame is white, moisture-resistant 16 mm melamine, which ensures longevity in active use. The cabinet model 6316 consists of four stationary shelves. The cabinet includes a fixed enclosing that can be fitted with an electrical outlet. The doors are made of high-pressure laminate with additional grey accent strips along the edges to promote spatial recognition. Orientation of the doors is changeable.

Dimensions: W 300 mm x H 1800 mm x D 500 mm

6316 Storage cabinet

Gaius cabinet 6317

The cabinet frame is white, moisture-resistant 16 mm melamine, which ensures longevity in active use. The cabinet model 6317 consists of three stationary shelves and a pull-out laundry basket. The cabinet includes a fixed enclosing that can be fitted with an electrical outlet. The doors are made of high-pressure laminate with additional grey accent strips along the edges to promote spatial recognition. Orientation of the doors is changeable.

Dimensions: W 300 mm x H 1800 mm x D 500 mm

6317 Storage cabinet

Gaius cleaning cabinet 6305 HH

The cabinet frame is white, moisture-resistant 16 mm melamine, which ensures longevity in active use. Gaius cleaning cabinet consists of one stationary shelf, double hook and a storage rack for a vacuum. The single door is made of high-pressure laminate with additional grey accent strips along the edges to promote spatial recognition. Orientation of the door is changeable.

Dimensions: W 300 mm x H 1800 mm x D 500 mm

6305HH Cleaning cabinet

Gaius washing machine cabinet 63020 H

The cabinet frame is white, moisture-resistant 16 mm melamine, which ensures longevity in active use. Gaius washing machine cabinet consists of two separate frames. The top section includes two shelves, and the bottom has one shelf. The doors are made of high-pressure laminate with additional grey accent strips along the edges to promote spatial recognition. Orientation of the doors is changeable.

Dimensions: Upper cabinet W 600 mm x H 1100 mm x D 500 mm
Bottom cabinet W 600 mm x H 700 mm x D 500 mm

63020 H Washing machine cabinet

63020-1 H Washing machine upper cabinet

63020-2 H Washing machine sub-cabinet



6316



6317



6305 HH

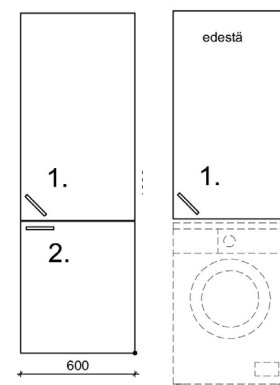

63020



6326



6327



6320 HH



Door with grey edge strips.



Gaius paper towel cabinet

The cabinet has a white moisture-resistant frame, made of 16 mm melamine, which ensures longevity in active use. The paper towel cabinet includes a paper towel dispenser and a fixed shelf. The doors are made of high-pressure laminate with additional grey accent strips along the edges to promote spatial recognition. Orientation of the doors is changeable.

Dimensions: W 300 mm x H 900 mm x D 135 mm

6326 The paper towel dispenser is situated in the top frame of the cabinet, with two shelves of additional storage

6327 The paper towel dispenser is situated in the bottom frame of the cabinet, with three shelves of additional storage

Dispenser cabinets

The cabinet has a white moisture-resistant frame, made of 16 mm melamine, which ensures longevity in active use. The dispenser cabinet consists of a paper towel dispenser and shelf in the top section, and two Dispenso Pac stands hidden by a door in the bottom frame. The doors are made of white high-pressure laminate with additional grey accent strips along the edges to promote spatial recognition. Orientation of the doors is changeable.

Dimensions: W 300 mm x H 900 mm x D 135 mm

6320 HH Dispenser cabinets

Other cabinets and shelf units

Upper cabinets and glass shelf units have white moisture-resistant frames made of 16 mm melamine, with grey accent strips. The cabinet includes a fixed enclosing that can be fitted with an electrical outlet. The doors are made of white high-pressure laminate with additional grey accent strips along the edges to promote spatial recognition. Orientation of the doors is changeable.

Dimensions: W 300 mm x H 900 mm x D 135 mm

- 6328 Equipment cabinet, 3 shelves, one door,
W 300 mm x H 900 mm x D 135 mm
- 6329 Equipment cabinet, top and bottom shelves, two doors,
W 300 mm x H 900 mm x D 135 mm
- 63003 HH Top cabinet W 400 mm x H 800 mm x D 300 mm, consists of three
shelves, with a fixed enclosing that can be fitted with two
electrical outlets
- 63004 HH Glass shelf unit, W 300 x H 800 mm x D 110 mm, 4 glass shelves
- 63007 HH Shelf unit, W 300 x H 800 mm x D 110 mm, 4 adjustable shelves

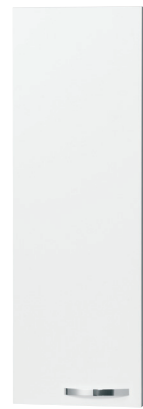

6328



6329



63003 HH



63004 HH



63007 HH

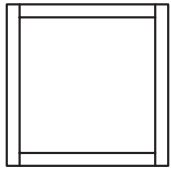

From the front

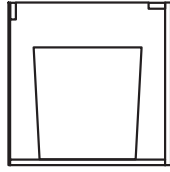

From the side

L 500/K 500/S 500

GAIUS
PUBLIC

Gaius lower cabinets

Wall-mounted cabinets ease cleaning in humid bathroom conditions. The white moisture-resistant frame is made of 16 mm melamine, and features grey accent strips. The complementary cabinet for the fixed Public basin includes a waste bin. The doors are made of white or stainless steel-coloured laminate with additional grey accent strips. Orientation of the doors is changeable.

Dimensions: W 500 mm x H 500 mm x D 500 mm

- 63013 Bottom waste cabinet whit waste bin, suitable for a fixed Public basin, white laminated door
- 63014 Bottom waste cabinet whit waste bin, suitable for a fixed Public basin, stainless steel-coloured laminated door
- 63016 Bottom cabinet, suitable for a height adjustable Plus basin, includes a pull-out laundry basket
- 63017 Bottom cabinet, suitable for a fixed Plus basin, includes a pull-out laundry basket



63013



63014



63016

Choices for doors



Door with grey edge strips



Stainless steel

Life cabinets

The Life series frames are made of grey, moisture-resistant 16 mm melamine, with a 1 mm ABS accent ribbon. Orientation of the doors is changeable.

Dimensions: W 400 mm x H 1750 mm x D 400 mm

- 6336 Life tall cabinet, grey
- 6336W Life tall cabinet, high-gloss white
- 6336VT Life tall cabinet, white frame, front panel light oak

Life basin dresser

The Life series dresser is made of moisture-resistant 16 mm melamine. The frame holds two pull-out drawers. The dresser is not connected to the basin, and can thus be removed from way of wheelchairs without disturbing the basin.

Dimensions: W 700 / 900 mm x H 560 mm x D 380 / 480 mm

- 6340 Life dresser, grey, W 600 x H 560 mm x D 380 mm
- 6337 Life dresser, grey, W 700 x H 560 mm x D 480 mm
- 6338 Life dresser, grey, W 900 x H 560 mm x D 480 mm
- 6340W Life dresser, high-gloss white, W 600 x H 560 mm x D 380 mm
- 6337W Life dresser, high-gloss white, W 700 x H 560 mm x D 480 mm
- 6338W Life dresser, high-gloss white, W 900 x H 560 mm x D 480 mm
- 6340VT Life dresser, white frame, front panel light oak, W 600 x H 560 mm x D 380 mm
- 6337VT Life dresser, white frame, front panel light oak, W 700 x H 560 mm x D 480 mm
- 6338VT Life dresser, white frame, front panel light oak, W 900 x H 560 mm x D 480 mm



6336



6338



6337

Senior cabinets

Senior cabinet solutions are designed to complement the 900 mm wide Senior basin. Cabinets have a white moisture-resistant frame made of 16 mm melamine. The cabinet solution includes a 600 mm basin cabinet, 300 mm side cabinet and a 300 mm wall-mounted cabinet. All parts can be ordered separately. The basin cabinet can be removed without disturbing the basin.



64100

- 64100 Senior cabinet set, white, white doors
- 64100-1 Senior basin cabinet, white, white doors
W 600 mm x H 640 mm x D 290 mm
- 64100-2 Senior side cabinet, white, white doors
W 300 mm x H 640 mm x D 290 mm
- 64100-3 Senior wall cabinet, white, white doors
W 300 mm x H 695 mm x D 155 mm
- 64101 Senior cabinet set, white, grey doors
- 64101-1 Senior basin cabinet, white, grey doors
W 600 mm x H 640 mm x D 290 mm
- 64101-2 Senior side cabinet, white, grey doors
W 300 mm x H 640 mm x D 290 mm
- 64101-3 Senior wall cabinet, white, grey doors
W 300 mm x H 695 mm x D 155 mm



64101

SEATS

Shower seats transform washing into a safe and easy activity. The folding seat requires minimal space. Suitable especially for elderly people or those with reduced mobility.

SHOWER SEATS

GAIUS
CARE

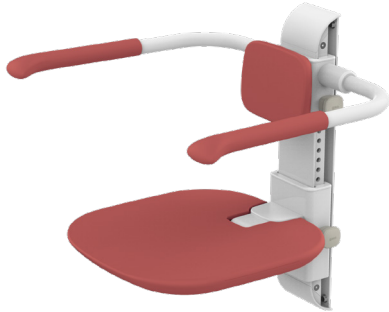

17412R + 17414R

Sense shower seats

The dynamic and antimicrobial Sense shower seat allows for customisation to individual needs. The adjustment lever allows for two-step height modification. The hidden hinges of the seat make folding up easy, and keep the seat upright without additional locking mechanisms.

The seat design ensures safety, ease and cleanliness during use. The hygienic properties of the seat and its complementary parts are key elements of the design. Mounting hardware sold separately.

Features:

- Unloading mechanism aids with folding
- Easy and fast to install
- Height adjustment range with armrests 160 mm, and without armrests 300 mm
- Armrests can be moved separately
- Backrest
- Shower seat withstands min. 400 kg, armrests 80 kg per rail
- Colour options include red and grey
- Seat with hole provides further comfort to washing

Mounting hardware is sold separately.

Sense shower seat, fixed

The Sense fixed shower seat is ideal for locations where space is scarce. The folded seat occupies only 140 mm of space. The tilted surface channels excess water off the seat.

The antimicrobial, elastomeric coating combined with hidden hinges assist cleaning. Hidden hinges also make folding up easy, and keep the seat upright without additional locking mechanisms.

Dimensions:

Shower seat W 430 mm x H 205 mm x D 450 mm

With hole W 430 mm x H 205 mm x D 450 mm

17402G Shower seat, fixed, grey

17402R Shower seat, fixed, red

17405G Shower seat with hole, fixed, grey

17405R Shower seat with hole, fixed, red

Mounting hardware sold separately.



17402G



17402R



17405R



17412G



17413R

Colour choices:



grey
RAL 7037



red
RAL 3003

Sense shower seat, height adjustable

The Sense shower seat with height adjustment is ideal for locations where there are a number of different users. The adjustment lever allows for height customisation in two steps. The design allows for a comfortable seating position.

The antimicrobial, elastomeric coating combined with hidden hinges assist cleaning. An armrest and backrest can be incorporated if needed. Hidden hinges also make folding up easy, and keep the seat upright without additional locking mechanisms. The folded seat occupies a max. 210 mm of space.

Features:

- Armrests can be moved separately
- Shower seat withstands min. 400 kg, armrests 80 kg per rail
- Colour options include red and grey
- Available in both fixed and height adjustable options
- Available as solid or seat with a hole

Dimensions:

Shower seat W 430 mm x H 600 mm x D 510 mm
With hole W 430 mm x H 600 mm x D 510 mm

17412G Shower seat, height adjustable, grey
17412R Shower seat, height adjustable, red
17413G Shower seat with hole, height adjustable, grey
17413R Shower seat with hole, height adjustable, red

Mounting hardware sold separately.

Armrest and backrest for Sense shower seat

Combined hand and back support makes it easier to sit down and provides comfort and safety to the Sense shower seat. Handrails can be moved individually. Handrails have an elastomeric coating which provides a non-slip grip.

Dimensions: W 588 mm x H 130 mm x D 535 mm
Handrails have an elastomeric coating for 280 mm,
The size of the back supports 195 x 145 mm.

17414G Sense hand and back support, grey
17414R Sense hand and back support, red

The Sense armrest and backrest is complementary to the Sense shower seats 17412G/R and 17413G/R.

Chest support

The chest support bar can be attached to a shower seat with an armrest and backrest or support rails fixed on both sides of a toilet.

Dimensions: W 640 x H 160 mm

20120 Chest support, white, rail colour grey



17414G



17414R



20120



1737GAM



1738GAM



17372GAM

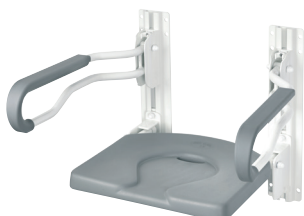

17372GAM+6522N

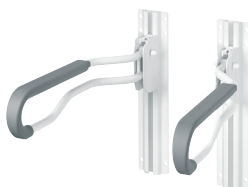

6522N



1770

Gaius shower seats

Gaius shower seats are made of integral plastic, which makes them easy to clean and comfortable to use. Seats equipped with height adjustment rails can also be customised with an armrest and backrest. Such extra support provides security for approaching and leaving the seat. All metal parts are stainless steel or aluminium and have antimicrobial paint cover.

Without additional handrails, height adjustable shower seats have a range of 300 mm. Height adjustment via hex key. Total loading capacity min. 250 kg.

- 1737GAM Fixed shower seat, grey
- 1738GAM Fixed shower seat with support leg, grey
- 17372GAM Height adjustable shower seat, grey
- 17373GAM Quickly height adjustable, shower seat, grey
- 1740GAM Shower seat with hole and support leg, grey

Elastomer handrails of the Gaius shower seat

Complementary handrails to the 17372 and 17373 shower seat. An antimicrobial frame with rails that can be turned up and out of the way.

- 6522N Handrails to the shower seat 17372, grey
- 6520 Handrails to the shower seat 17372, red
- 1770 Handrails to the shower seat 17372GAM, grey

Mounting hardware is sold separately.

Mounting set

- 6209S 4 acid-proof screws, wall plugs and caps for shower seats 17402 and 17405
- 20064-Z 6 acid-proof screws, wall plugs and caps for shower seats 1737, 17372 and 17373
- 6219-Z 8 acid-proof screws, wall plugs and caps for shower seats 17412 and 17413

SUPPORT AND HANDRAILS

Support and handrails are designed to ease activities in bathroom conditions and improve the security of elderly people and those with reduced mobility.

SUPPORT RAILS

Regal support rail, fixed, wall-mounted

The side-mounted Regal support rail suits both private and public bathroom facilities. The rail can be mounted, for example, to an enclosed water tank. Rails are equipped with hinges that aid with folding, and keeping the rails in an upright position. Load-bearing capacity is 200 kg. These modern support rails have a chrome-plated or white antimicrobial frame with an elastomeric gripping surface. Additional hardware is painted steel, with plastic cover plates.

Dimensions: Length from the wall 770 mm or 870 mm.

20105G	Fixed support rail, side-mounted, white, L 770 mm, grey
20105R	Fixed support rail, side-mounted, white, L 770 mm, red
20203G	Fixed support rail, side-mounted, white, L 870 mm, grey
20203R	Fixed support rail, side-mounted, white, L 870 mm, red
20101C	Fixed support rail, side-mounted, white, L 800 mm, chrome-plated

Mounting hardware sold separately.

Additional equipment:

1721	Toilet paper holder
1764N	Hand shower holder
20120	Chest support

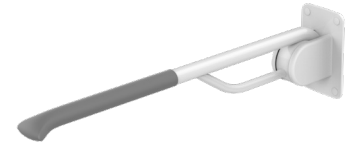

20105G



20105R

Colour choices:



grey
RAL 7037



red
RAL 3003

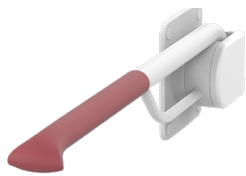

330001RAM

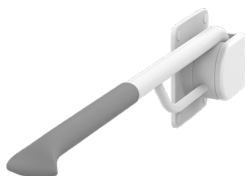

330001GAM

Regal support rail pair, fixed, side-mounted

The side-mounted Regal support rail suits both private and public bathroom facilities. The rail can be mounted, for example, to an enclosed water tank. Rails are equipped with hinges that aid with folding, and keeping the rails in an upright position. Load-bearing capacity is 200 kg. These modern support rails have a chrome-plated or white antimicrobial frame with an elastomeric gripping surface. The rail diameter is 27 mm. Additional hardware is painted steel, with plastic cover plates.

Dimensions: Length from the wall 770 mm or 870 mm.

330001GAM	Fixed support rail, 770 mm, side-mounted, grey
330001RAM	Fixed support rail, 770 mm, side-mounted, red
330003GAM	Fixed support rail, 870 mm, side-mounted, grey
330003RAM	Fixed support rail, 870 mm, side-mounted, red

Mounting hardware sold separately.

Additional equipment:

1721	Toilet paper holder
1764N	Hand shower holder
20120	Chest support

Regal fixed support rail, floor-mounted

The height adjustable Regal support rails comprise of many features which improve functionality. The adjustment lever allows for two-step height modification. Rails are equipped with hinges that aid with folding, and keeping the rails in an upright position. Height adjustment range of 200 mm. Load-bearing capacity is 250 kg, with capacity of 150 kg from the side. Cover plates are plastic.

Dimensions: W 100 x H 850 x D 930 mm, length from the floor 770 mm or 870 mm.

- 20107G Fixed support rail, floor-mounted, L 820 mm, white with grey coating
- 20107R Fixed support rail, floor-mounted, L 820 mm, white with red coating
- 20107C Fixed support rail, floor-mounted, L 820 mm, chrome-plated

Mounting hardware is sold separately.

Additional equipment:

- 1721 Toilet paper holder
- 1764N Hand shower holder
- 20120 Chest support



20107G



20107R

Regal support rail, height adjustable, wall-mounted

The height adjustable Regal support rails comprise of many features which improve functionality. The adjustment lever allows for two-step height modification. Rails are equipped with hinges that aid with folding, and keeping the rails in an upright position. Height adjustment range of 200 mm. Load-bearing capacity is 250 kg, with capacity of 225 kg from the side. Cover plates are plastic.

Dimensions: Length from the wall 615, 650, 800 or 900 mm



20204R



20102C

20213G	Height adjustable support rail, L 650 mm, white with grey coating
20103R	Height adjustable support rail, L 650 mm, white with red coating
20106G	Height adjustable support rail, L 800 mm, white with grey coating
20106R	Height adjustable support rail, L 800 mm, white with red coating
20204G	Height adjustable support rail, L 900 mm, white with grey coating
20204R	Height adjustable support rail, L 900 mm, white with red coating
20102C	Height adjustable support rail, L 830 mm, chrome-plated
20205C	Height adjustable support rail, L 930 mm, chrome-plated

Mounting hardware is sold separately.

Additional equipment:

1721	Toilet paper holder
1764N	Hand shower holder
20120	Chest support

Oval support rail, fixed, wall-mounted

Oval support rails have a white antimicrobial frame with an elastomeric gripping surface. Chrome-plated rails do not feature a gripping surface. The polished and ergonomic design of the Oval support rail enables two gripping heights. Rails are equipped with hinges that aid with folding, and keeping the rails in an upright position. Load-bearing capacity is 220 kg, with a capacity of 220 kg from the side. Additional hardware is painted steel with plastic cover plates. The rail diameter is 30 x 33 mm.

Measurements: Distance from the wall 720 or 820 mm.

- 20111G Fixed support rail, wall-mounted, L 720 mm, white, with grey coating
- 20111R Fixed support rail, wall-mounted, L 720 mm, white, with red coating
- 20111C Fixed support rail, wall-mounted, L 720 mm, chrome-plated
- 20115G Fixed support rail, wall-mounted, L 820 mm, white, with grey coating
- 20115R Fixed support rail, wall-mounted, L 820 mm, white, with red coating
- 20115C Fixed support rail, wall-mounted, L 820 mm, chrome-plated

Mounting hardware is sold separately.

Oval support rail, side-mounted

- 20127G Fixed support rail, side-mounted, right, L 720 mm, white with grey coating
- 20127R Fixed support rail, side-mounted, right, L 720 mm, white with red coating
- 20127C Fixed support rail, side-mounted, right, L 720 mm, chrome-plated
- 20114G Fixed support rail, side-mounted, left, L 720 mm, white with grey coating
- 20114R Fixed support rail, side-mounted, left, L 720 mm, white with red coating
- 20114C Fixed support rail, side-mounted, left, L 720 mm, chrome-plated
- 20128G Fixed support rail, side-mounted, right, L 820 mm, white with grey coating
- 20128R Fixed support rail, side-mounted, right, L 820 mm, white with red coating
- 20128C Fixed support rail, side-mounted, right, L 820 mm, chrome-plated
- 20118G Fixed support rail, side-mounted, left, L 820 mm, white with grey coating
- 20118R Fixed support rail, side-mounted, left, L 820 mm, white with red coating
- 20118C Fixed support rail, side-mounted, left, L 820 mm, chrome-plated

Additional equipment:

- 1721 Toilet paper holder
- 1764N Hand shower holder
- 20120 Chest support



20111C

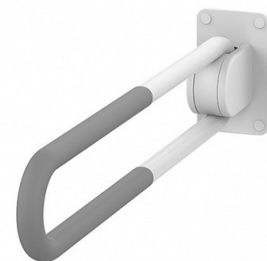

20115G

Colour choices:



grey
RAL 7037



red
RAL 3003



20112G



20116R

Oval support rail, height adjustable, wall-mounted

The height adjustable Oval support rails comprise of many features which improve functionality. The adjustment lever allows for two-step height modification. Rails are equipped with hinges that aid with folding, and keeping the rails in an upright position. Height adjustment range is 200 mm. Load-bearing-capacity at mid-height is 220 kg, with a capacity of 220 kg from the side.

Dimensions: Length from the wall 750 or 850 mm

20112G	Height adjustable support rail, wall-mounted, L 750 mm, white, with grey coating
20112R	Height adjustable support rail, wall-mounted, L 750 mm, white, with red coating
20112C	Height adjustable support rail, wall-mounted, L 750 mm, chrome-plated
20116G	Height adjustable support rail, wall-mounted, L 850 mm, white, with grey coating
20116R	Height adjustable support rail, wall-mounted, L 850 mm, white, with red coating
20116C	Height adjustable support rail, wall-mounted, L 850 mm, chrome-plated

Mounting hardware is sold separately.

Additional equipment:

1721	Toilet paper holder
1764N	Hand shower holder
20120	Chest support

Mounting set for Regal/Oval support rail

6208-Z	6 acid-proof screws, wall plugs and caps
20063-Z	4 acid-proof screws, base plates, wall plugs and caps
6209S	4 acid-proof screws, base plates, wall plugs and caps (fixed and wall-mounted rails)

Art 4 support rail

Durability is the primary priority of the design of the Art 4 support rail. The wall-mounted rail ensures safe and stable support from the top and sides. The antimicrobial elastomeric coating of the rail provides a hygienic and non-slip grip. Height adjustment range is 200 mm, alterable without tools. Load-bearing capacity is 150 kg and 60 kg torque from the side. The rail diameter is 33 mm.

Dimensions: Length from the wall 800 mm

- 10407 Art 4 support rail, red
- 10408 Art 4 support rail, yellow
- 10409 Art 4 support rail, grey

Mounting hardware sold separately.

Additional equipment:

- 1721 Toilet paper holder
- 1764N Hand shower holder
- 20120 Chest support

Mounting set for Art 4 support rail

- 6219-Z 8 acid-proof screws for Art 4 support rails

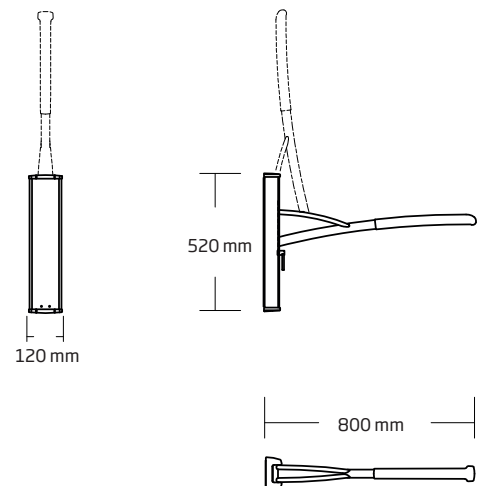

10407



1721



1764N

Colour choices:



grey
RAL 7037



red
RAL 3003



10101



10102



10111

STAY SUPPORT RAILS

Finnish-made Stay support rails have a white antimicrobial frame with an elastomeric gripping surface. Additional hardware is aluminium. The rail diameter is 22 mm. Rails are sold individually.

Stay support rail, fixed

Dimensions: Length from the wall 800 mm

- 10101GW Stay 1 support rail, white, with grey coating
- 10101RW Stay 1 support rail, white, with red coating

Wall-mounted Stay 2 support rail with leg, length from the wall 800 mm.

- 10102GW Stay 2 support rail with leg, white, with grey coating
- 10102RW Stay 2 support rail with leg, white, with red coating

Wall-mounted Stay 3 support rail with leg, length from the wall 1000 mm.

- 10103GW Stay 3 support rail with leg, white, with grey coating
- 10103RW Stay 3 support rail with leg, white, with red coating

Stay support rail, height adjustable, floor-mounted

The height adjustable and floor-mounted Stay 11 support rail has a 200 mm height adjustment range. Rail length is 800 mm. Trunk is aluminium.

- 10111G Stay 11 support rail, white, with grey coating
- 10111R Stay 11 support rail, white, with red coating

Mounting hardware is sold separately.

Additional equipment:

- 1756N Toilet paper holder
- 1759 Alarm button holder
- 1768N Hand shower holder
- 20120 Chest support
- 1901 Hook for the chest support
- 20034 ESD protection

Stay support rail, height adjustable, wall-mounted

The height adjustable and wall-mounted Stay 13 support rail has a 200 mm height adjustment range. Rail length is 820 mm

- 10113GW Stay 13 support rail, white, with grey coating
- 10113RW Stay 13 support rail, white, with red coating

Wall-mounted and height adjustable Stay 13 support rail length is 920 mm from the wall. The height adjustment range is 200 mm.

- 10115GW Stay 15 support rail, white, with grey coating
- 10115RW Stay 15 support rail, white, with red coating

Wall-mounted and height adjustable Stay 16 support rail length is 650 mm from the wall. The height adjustment range is 200 mm.

Special ordered product, minimum order of 45 pieces .

- 10116GW Stay 16 support rail, white, with grey coating
- 10116RW Stay 16 support rail, white, with red coating

Additional equipment:

- 1756N Toilet paper holder
- 1759 Alarm button holder
- 1768N Hand shower holder
- 20120 Chest support
- 1901 Hook for the chest support
- 20034 ESD-protection

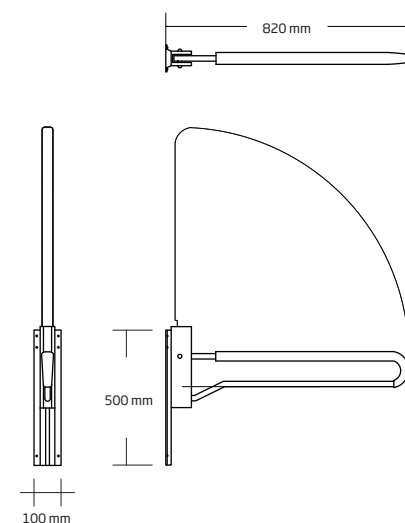

10113

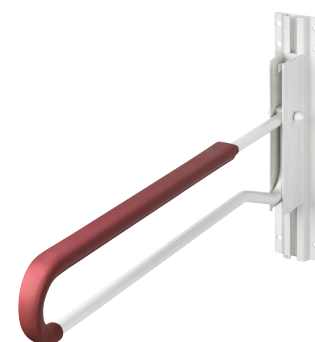

10115RW



10116GW



10123GW

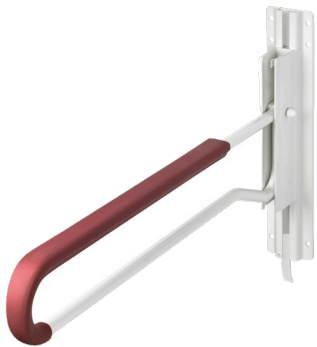

10125RW



1756N



1759

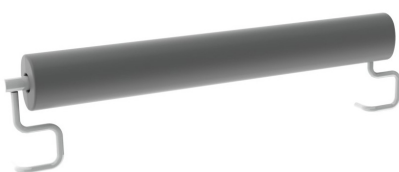

1768N



20120

Stay support rail, quick height adjustment

The Stay 23 support rail is wall-mounted, with 820 mm rail length. The quick height adjustment serves a range of 200 mm.

- 10123GW Stay 23 support rail, white, with grey coating
- 10123RW Stay 23 support rail, white, with red coating
- 10123YW Stay 23 support rail, white, with yellow coating

Wall-mounted and height adjustable Stay 25 support rail length is 920 mm from the wall. The height adjustment range is 200 mm.

- 10125GW Stay 25 support rail, white, with grey coating
- 10125RW Stay 25 support rail, white, with red coating

Mounting hardware is sold separately.

Additional equipment:

- 1756N Toilet paper holder
- 1759 Alarm button holder
- 1768N Hand shower holder
- 20120 Chest support
- 1901 Hook for the chest support
- 20034 ESD protection

Mounting set to Stay support rail

- 20064-Z 6 acid-proof screws, wall plugs and studs

HANDRAIL

Modular handrail, straight

Modular handrails have a special oval shape which enables a natural firm grip. The rail diameter is 30 x 33 mm. Load-bearing capacity is a max. of 225 kg. The rail frame is aluminium, with a non-slip, antimicrobial paint cover. Additional hardware is polymer. Mounting hardware included.

Modular handrails are available in a variety of standardised sizes, but are also customisable from individual modules (special ordered products).

16211W 450 mm, straight handrail, antimicrobial, white, with white profile
16211G 450 mm, straight handrail, antimicrobial, white, with grey profile
16211R 450 mm, straight handrail, antimicrobial, white, with red profile

16222W 550 mm, straight handrail, antimicrobial, white, with white profile
16222G 550 mm, straight handrail, antimicrobial, white, with grey profile
16222R 550 mm, straight handrail, antimicrobial, white, with red profile

16255W 700 mm, straight handrail, antimicrobial, white, with white profile
16255G 700 mm, straight handrail, antimicrobial, white, with grey profile
16255R 700 mm, straight handrail, antimicrobial, white, with red profile

16266W 800 mm, straight handrail, antimicrobial, white, with white profile
16266G 800 mm, straight handrail, antimicrobial, white, with grey profile
16266R 800 mm, straight handrail, antimicrobial, white, with red profile

16277W 1000 mm, straight handrail, antimicrobial, white, with white profile
16277G 1000 mm, straight handrail, antimicrobial, white, with grey profile
16277R 1000 mm, straight handrail, antimicrobial, white, with red profile

Modular

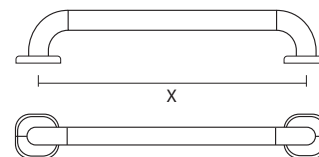

X = standard length 450 / 550 / 700 / 800 / 1000

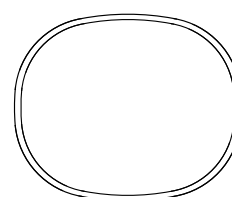

profile cross-section



16211W



16222G



16222R



16277G

Modular L-handrail

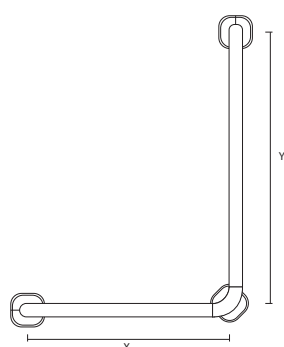

X = 450

Y = 600 / 1000

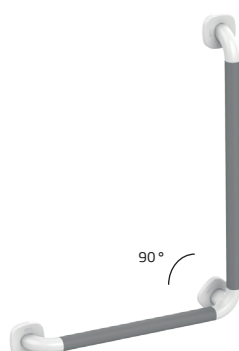

16244G

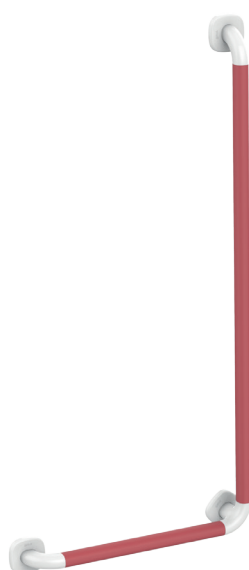

16288R

Modular L handrail

Modular handrails have a special oval shape which enables a natural firm grip. The rail diameter is 30 x 33 mm. Load-bearing capacity is min. 400 kg. The rail frame is aluminium, with a non-slip, antimicrobial Soft Touch paint cover. Additional hardware is polymer. Mounting hardware is included.

16244W 450 + 600 mm 90°, L handrail, antimicrobial, white, with white profile

16244G 450 + 600 mm 90°, L handrail, antimicrobial, white, with grey profile

16244R 450 + 600 mm 90°, L handrail, antimicrobial, white, with red profile

16288W 450 + 1000 mm 90°, L handrail, antimicrobial, white, with white profile

16288G 450 + 1000 mm 90°, L handrail, antimicrobial, white, with grey profile

16288R 450 + 1000 mm 90°, L handrail, antimicrobial, white, with red profile

Horizontal rail can be placed either left or right.

Modular L handrail

Dimensions: The rail diameter is 30 x 33 mm

16299W	700 + 700 mm 90°, L handrail, antimicrobial, white, with white profile
16299G	700 + 700 mm 90°, L handrail, antimicrobial, white, with grey profile
16299R	700 + 700 mm 90°, L handrail, antimicrobial, white, with red profile
16300W	550 + 700 + 1000 mm, handrail, antimicrobial, white, with white profile
16300G	550 + 700 + 1000 mm, handrail, antimicrobial, white, with white profile
16300R	550 + 700 + 1000 mm, handrail, antimicrobial, white, with red profile
16366W	800 + 600 mm 90°, handrail, antimicrobial, white, with white profile
16366G	800 + 600 mm 90°, handrail, antimicrobial, white, with grey profile
16366R	800 + 600 mm 90°, handrail, antimicrobial, white, with red profile

Modular

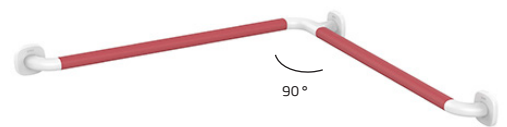
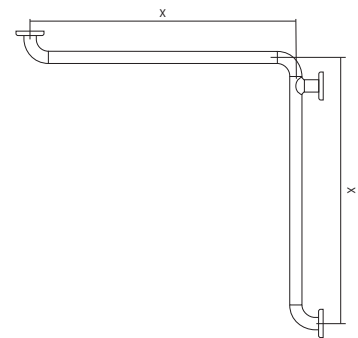

16299R

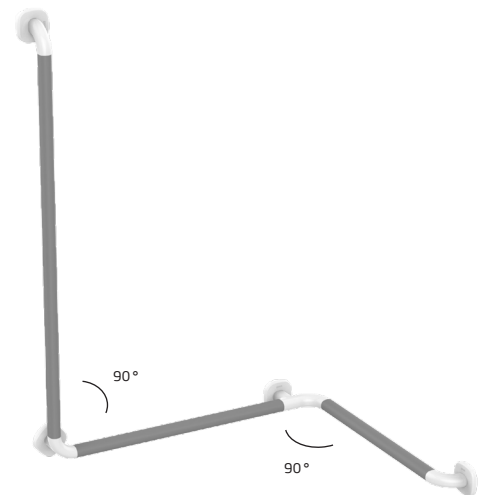

16300G

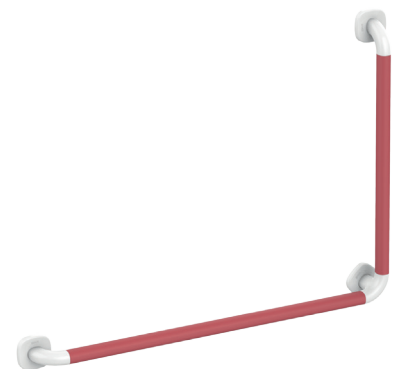

16366R

Modular shower support

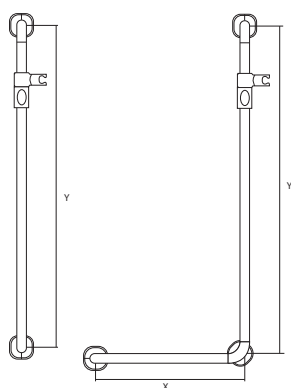

16388G



16400W

Horizontal rail can be placed either left or right.

GAIUS
CARE

Modular shower support

Shower support rails have a special oval shape which enables a natural firm grip. Load-bearing capacity is 250 kg. The rail frame is aluminium, with a non-slip, antimicrobial Soft Touch paint cover. Additional hardware is polymer. Mounting hardware is included.

Dimensions: The rail Ø 33 x 30 mm.

16388W	1000 mm, shower support, one shower holder, white
16388G	1000 mm, shower support, one shower holder, grey
16388R	1000 mm, shower support, one shower holder, red
16399W	450 + 1200 mm 90°, shower support, one shower holder, white
16399G	450 + 1200 mm 90°, shower support, one shower holder, grey
16399R	450 + 1200 mm 90°, shower support, one shower holder, white
16400W	350 + 1200 mm 90°, shower support, one shower holder, white
16400G	350 + 1200 mm 90°, shower support, one shower holder, grey
16400R	350 + 1200 mm 90°, shower support, one shower holder, red

Additional equipment:

16501	Showerhead holder's adjustment rail, long, 350 mm
-------	---

Solo handrail

The seamless design of the Solo handrail, coupled with the slim, oval shape of the bar provides a firm grip. The antimicrobial properties of the frame ensure a high level of hygiene. Load-bearing capacity is min. 225 kg. Mounting hardware is included.

Dimensions: The rail diameter is 30 x 33 mm

Solo handrail, straight

16800W 400 mm, Solo handrail, antimicrobial, white
16800G 400 mm, Solo handrail, antimicrobial, grey
16800R 400 mm, Solo handrail, antimicrobial, red

16801W 600 mm, Solo handrail, antimicrobial, white
16801G 600 mm, Solo handrail, antimicrobial, grey
16801R 600 mm, Solo handrail, antimicrobial, red

16802W 800 mm, Solo handrail, antimicrobial, white
16802G 800 mm, Solo handrail, antimicrobial, grey
16802R 800 mm, Solo handrail, antimicrobial, red

Solo L handrail

16803W 790 x 790 mm 90 °, Solo L handrail, antimicrobial, white
16803G 790 x 790 mm 90 °, Solo L handrail, antimicrobial, grey
16803R 790 x 790 mm 90 °, Solo L handrail, antimicrobial, red

Solo shower support

16804W 1200 mm, shower support, inc. one showerhead holder, white
16804G 1200 mm, shower support, inc. one showerhead holder, grey
16804R 1200 mm, shower support, inc. one showerhead holder, red

16800W



16801G



16802R



16803G



16804W



16804G





16805W



16806G

Solo L shower support with showerhead holder, vertical pole on the right

- 16805W 440 + 1200 mm 90 ° + shower support, right, inc. one showerhead holder, white
- 16805G 440 + 1200 mm 90 ° + shower support, right, inc. one showerhead holder, grey
- 16805R 440 + 1200 mm 90 ° + shower support, right, inc. one showerhead holder, red

Solo L shower support with showerhead holder, vertical pole on the left

- 16806W 440 + 1200 mm 90 ° + shower support, left, inc. one showerhead holder, white
- 16806G 440 + 1200 mm 90 ° + shower support, left, inc. one showerhead holder, grey
- 16806R 440 + 1200 mm 90 ° + shower support, left, inc. one showerhead holder, red

Solo handrail, vertical pole on the right

- 16807W 800 + 600 mm 90 °, right, white
- 16807G 800 + 600 mm 90 °, right, grey
- 16807R 800 + 600 mm 90 °, right, red

Solo handrail, vertical pole on the left

- 16808W 800 + 600 mm 90 °, left, white
- 16808G 800 + 600 mm 90 °, left, grey
- 16808R 800 + 600 mm 90 °, left, red

Solo handrail, vertical pole on the right

- 16234W 440 + 590 mm 145 °, right, white
- 16234G 440 + 590 mm 145 °, right, grey
- 16234R 440 + 590 mm 145 °, right, red

Solo handrail, vertical pole on the left

- 16235W 440 + 590 mm 145 °, left, white
- 16235G 440 + 590 mm 145 °, left, grey
- 16235R 440 + 590 mm 145 °, left, red

Mounting hardware is included.

Additional equipment:

- 16501 Showerhead holder's adjustment rail, long

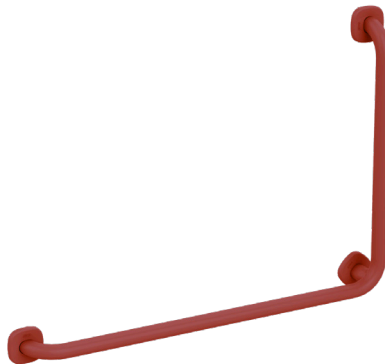

16807R

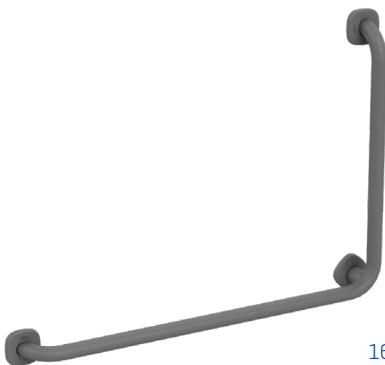

16807G

Solo E rail

The unique design of the Solo E rail provides a variety of gripping surfaces to suit the dynamic bathroom environment. The ergonomic slim oval shape of the rail, coupled with the antimicrobial aluminium frame yields a safe and hygienic handrail. The rail diameter is 30 x 33 mm.

1677W	Solo E handrail, 500 mm, antimicrobial, white
1677G	Solo E handrail 500 mm, antimicrobial, grey
1677R	Solo E handrail, 500 mm, antimicrobial, red
1679RAM	Solo E handrail, 500 mm elastomer coating, red
1679GAM	Solo E handrail, 500 mm elastomer coating, grey

Handrail

1705	400 mm, Ø 25 mm, stainless steel. shiny
1706	600 mm, Ø 25 mm, stainless steel. shiny

Solo E rail

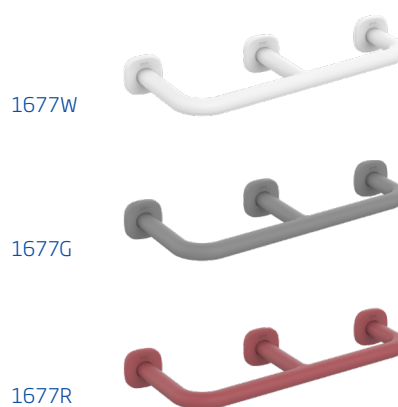
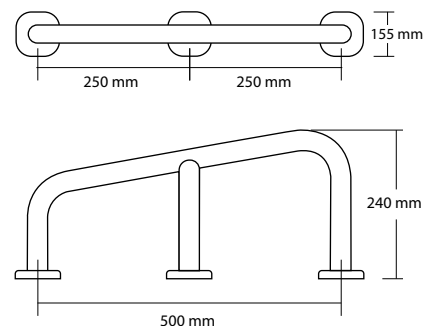

Colour choices for Solo E rail:

	grey RAL 7037		red RAL 3003
	white RAL 9016		



MIRROR CABINETS, MIRRORS AND LIGHTS

MIRROR CABINETS



Korpinen mirror cabinets

Korpinen mirror cabinets come equipped with a straight or tilted mirror, which allows for wheelchair users and children to see themselves. The door has sturdy hinges and a lock, but can also be fitted with a magnetic closure. Right-handed cabinet doors are standard, but left-handed alternatives are available as a special order. Further customisation is possible using different bases. An additional light fixture is also available.

The moisture-resistant frames of Korpinen mirror cabinets derives from the 0.7 mm electro-galvanised steel sheet with additional antimicrobial properties.

Korpinen 500 mm mirror cabinets

- 9511W Mirror cabinet, W 500 x H 700 x D 135 mm, straight mirror door, with no base, one shelf and a paper towel holder
- 9514W Mirror cabinet, W 500 x H 700 x D 135 mm, slanted mirror door, with no base, one shelf and a paper towel holder
- 9523W Mirror cabinet, W 500 x H 800 x D 135 mm, slanted mirror door, with no base, one shelf and a paper towel holder
- 9524W Mirror cabinet, W 500 x H 700 x D 135 mm, straight mirror door, with one shelf, a paper towel holder and a base with two Dispenso Pac dispensers
- 9525W Mirror cabinet, W 500 x H 700 x D 135 mm, slanted mirror door, with one shelf, a paper towel holder, and a base with two Dispenso Pac dispensers

Korpinen 600 mm mirror cabinets

- 9517W Mirror cabinet, W 600 x H 700 x D 135 mm, straight mirror door, with no base, one shelf and a paper towel holder
- 9520W Mirror cabinet, W 600 x H 700 x D 135 mm, slanted mirror door, with no base, one shelf and a paper towel holder
- 9527W Mirror cabinet, W 600 x H 700 x D 135 mm, straight mirror door, with one shelf, a paper towel holder and a base with two Dispenso Pac dispensers
- 9526W Mirror cabinet, W 600 x H 700 x D 135 mm, slanted mirror door, with one shelf, a paper towel holder and a base with two Dispenso Pac dispensers

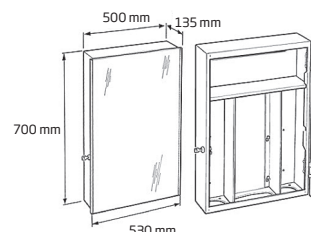

9511W

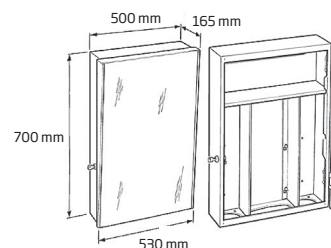

9514W

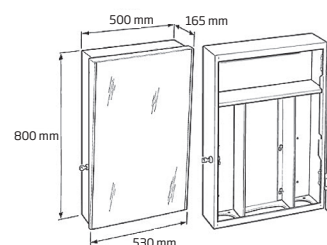

9523W

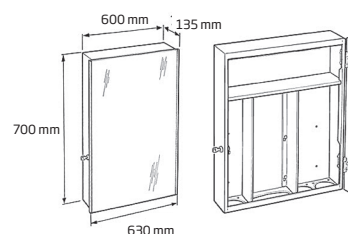

9517W

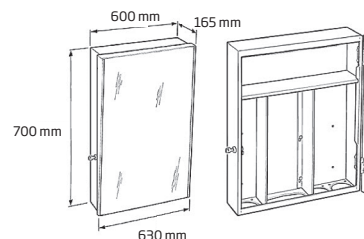

9520W



9511W



9514W

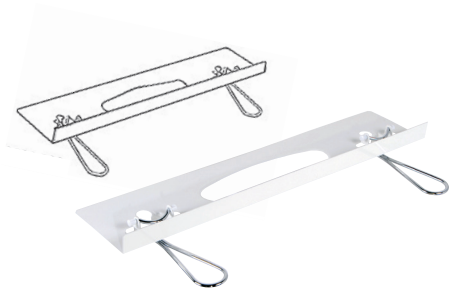

9536-103W, 500 mm

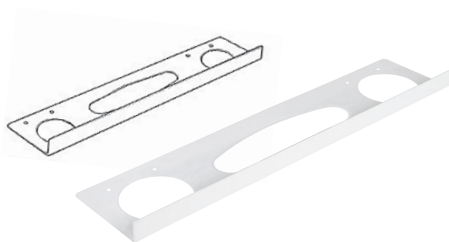

9536-101W, 500 mm

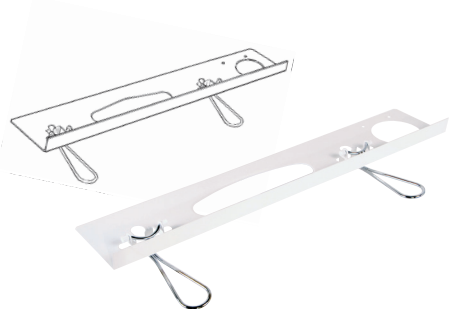

9538-104W, 600 mm

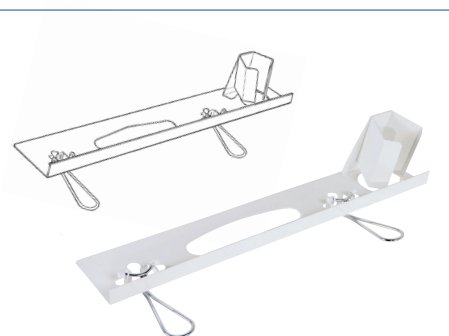

9538-010W, 600 mm

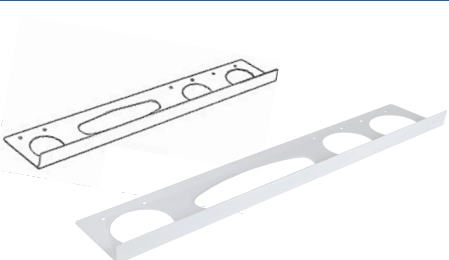

9538-101W, 600 mm

Base options for Korpinen mirror cabinets

9536-103W, 500 mm

- Two elbow-operated Dispenso Pac dispensers and one paper towel holder
- The minimal amount of screws and bolts makes it easy to keep the base clean
- Recommended especially for hospitals

9536-101W, 500 mm

- Three dispenser holes

9536-102W, 500 mm

- One paper towel dispenser hole

9537-010W, 500 mm

- Platform without dispenser holes

9538-104W, 600 mm

- Two elbow-operated Dispenso Pac dispensers, one dispenser hole and one circular dispenser hole.
- The minimal amount of screws and bolts makes it easy to keep the base clean

9538-105W, 600 mm

- One elbow-operated Dispenso Pac dispensers, one stationary beaker dispenser and one paper towel dispenser.

9538-101W, 600 mm

- Four dispenser holes

9538-010W, 600 mm

- Two elbow-operated Dispenso Pac dispensers, one stationary beaker dispenser and one dispenser hole.
- The minimal amount of screws and bolts makes it easy to keep the base clean.
- Recommended especially for hospitals

9538-106W, 600 mm

- One paper towel dispenser hole

9539-010W, 600 mm

- Platform without dispenser holes

Accessories for Korpinen mirror cabinets

9582	Dispenso pac dispenser frame, elbow-operated
9583	Dispenso pac dispenser frame, palm-operated
9585	Beaker dispenser
9545-012	Dispenso pac dispenser lever
Safety film	Safety film for mirror
9590	Corner mounting support for 500 mm mirror cabinet



9582



9583



9585

Corner mirror cabinets

The Gaius corner mirror cabinet is especially intended as a complementary piece to the Gaius Hospital basin. The interior houses two movable shelves. The cabinet door is slightly taller than the frame of the cabinet. Orientation of door determined during instillation, and a light fixture can also be attached. Cabinet is fastened directly to wall via side baseboards.

Dimensions: W400 mm x H 900 mm

- 6532 Corner mirror cabinet, with moisture-resistant melamine frame
- 6533 Corner mirror cabinet, with moisture-resistant melamine frame

Dimensions: W500 mm x H 900 mm

- 6537 Corner mirror cabinet, with moisture-resistant melamine frame
- 6534 Corner mirror cabinet, with moisture-resistant melamine frame

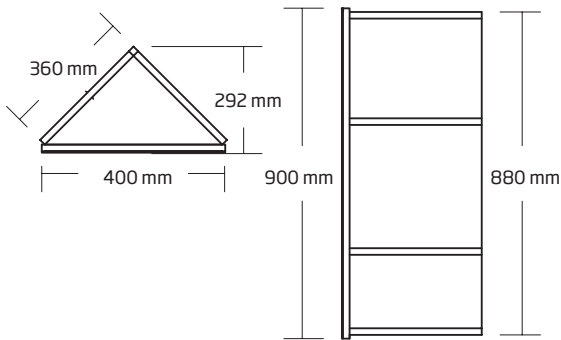

6533

Senior mirror cabinet

Senior mirror cabinets are made of a moisture-resistant melamine frame outlined by ABS accent strips. The cabinet has double-sided, mirrored doors and one socket electrical outlet inside.

Dimensions: W 600 x H 800 x D 130 mm

- 9531 Senior mirror cabinet, white, glass shelves
- 9532 Senior mirror cabinet, white, melamine shelves

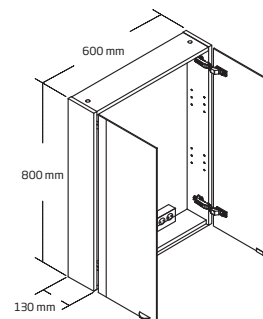

9531

Life mirror cabinet

The cabinet has double-sided, mirrored doors and one socket electrical outlet inside. Grey MDF frame with chrome hardware.

Dimensions: W 700 x H 750 x D 150 mm

- 6339 Life mirror cabinet, grey
- 6339W Life mirror cabinet, high-gloss, white
- 6339VT Life mirror cabinet, white frame and light oak ABS accent strips



9531



6107



9561W



6530

MIRRORS

GAIUS
CARE

Gaius mirrors

The Gaius mirror is mounted to the wall via aluminium bands.

- 6101 Gaius mirror, W 600 mm x H 900 mm
- 6102 Gaius mirror, W 900 mm x H 1000 mm
- 6107 Gaius mirror, W 600 mm x H 1000 mm

Gaius slanted mirrors

Slanted Gaius mirrors cater to the needs of wheelchair patients, children and adults.

- 9561W Gaius slanted mirror, W 530 mm x H 695 mm
- 9562W Gaius slanted mirror, W 630 mm x H 695 mm
- 9563W Gaius slanted mirror, W 530 mm x H 790 mm
- 9534 H Gaius slanted mirror with grey shutter,
W 600 mm x H 900 mm x D 200 mm, inc. a light
- 9534 V Gaius slanted mirror with white shutter,
W 600 mm x H 900 mm x D 200 mm, inc. a light

Gaius corner mirrors

The Gaius corner mirrors are especially intended as complementary pieces to the Gaius Hospital basins. Mounted using a special corner piece.

- 6530 Gaius corner mirror, W 500 mm x H 1000 mm

Gaius mirror accessories

- Safety film Safety film for mirror
- 9564 Corner attachment piece for slanted mirrors

LIGHTS

Mirror cabinet light

LED mirror cabinet lights suit all Korpinen mirror cabinets, corner mirrors and corner mirror cabinets. The light fixture is attached to the top of cabinets with screws. IP44 IEC protection class.

9570LED LED mirror cabinet light, W 400 mm, 8 W, 700 lm, cabinet mounted

LED light

Durable LED lights are an ideal addition to accessible bathrooms. IP44 IEC protection class.

9551 Cabinet and wall mounting options, W 415 mm, 6 W, 550 lm
9552 Cabinet and wall mounting options, W 590 mm, 12 W, 1200 lm
9553 Cabinet and wall mounting options, W 890 mm, 16 W, 1600 lm
9573 Mirror cabinet light, W 500 mm, 18 W, cabinet mounting
9574 Mirror cabinet light, W 600 mm, 18 W, cabinet mounting
9200LED Universal light, W 500 mm, 2 x 18 W, 1400 lm, 4000 K, cabinet mounting
9201LED Universal light, W 500 mm, 2 x 18 W, 1400 lm, 4000 K, wall mounting
9206LED Universal light, W 600 mm, 2 x 32 W, 1400 lm, 4000 K, cabinet mounting
9207LED Universal light, W 600 mm, 2 x 32 W, 1400 lm, 4000 K, wall mounting

Gaius light

Gaius lights illuminate without glare, providing indirect light via the ceiling and mirror. The high frequency (10,000 Hz) does not trigger migraines or epileptic seizures. Ballast included to ensure stable light output. IP44 IEC protection class.

6110LED Mirror light, W 600 mm, 14 W, 1400 lm, 4000 K, wall mounting
6111LED Mirror light, W 600 mm, 28 W, 1400 lm, 4000 K, wall mounting

Universal light

Universal lights are ideal for bathroom spaces. Include two light switches, which allow for general and mirror lights to be used separately. The lights illuminate without glare, providing indirect light via the ceiling and mirror. The high frequency does not trigger migraines or epileptic seizures. IP44 IEC protection class.

9206 Width 600 mm, 2 x 55 W, cabinet mounting



9570LED



9551



9573



6110LED



9207

SANITARY FACILITY EQUIPMENT

Our comprehensive product range includes a variety of bathroom equipment suitable for hospitals, public areas, hotels, work environments and private homes.

Väinö Korpinen Oy distributes Bobrick and Wesco products in Finland. For more information, please contact customer service.

SOAP DISPENSERS

Liquid soap dispensers

RST Line liquid soap dispenser

RST Line liquid soap dispensers suit public toilets and bathroom spaces. The RST Line liquid soap dispenser is made of stainless steel, powder coat painted, white on the inside. Volume 0.8 l. Mounting via a separate wall-mounting disc.

1300LAM RST Line liquid soap dispenser, without lock, lacquered, antimicrobial

Katrin liquid soap dispenser

Dimensions: W 100 mm x H 291 mm x D 130 mm

90229 Katrin liquid soap dispenser, white plastic, 1000 ml

92209 Katrin liquid soap dispenser, black plastic, 1000 ml

Mitat: W 100 mm x H 275 mm x D 124 mm

982517 Katrin liquid soap dispenser, white steel, 1000 ml

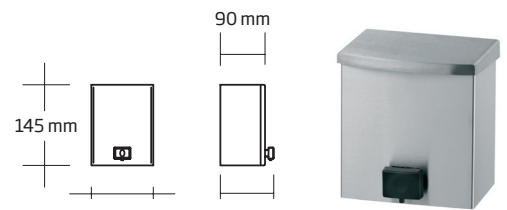

1300LAM



90229



92209



982517



Liquid soap dispensers for disposable packages

Dimensions: W 113 x H 300 mm

- 1226 Dispenso Pac wall rack, elbow-operated
- 1227 Dispenso Pac wall rack, palm-operated
- 1229 Dispenso Pac wall rack, elbow-operated, lockable
- 1228 Dispenso Pac wall rack, palm-operated, lockable
- 1241LAM vas Dispenso Pac wall rack, stainless steel, elbow-operated, lockable, antimicrobial
- 1243WAM vas Dispenso Pac wall rack, white stainless steel, elbow-operated, lockable, antimicrobial
- 1251 Drop tray for liquid soap dispensers



Liquid soap refill

Dimensions: W 115 mm x H 230 mm x D 111 mm

- 2311 Savonpak refill 0.8 l



CUP HOLDER

RST Line cup holder

The cup dispenser is made of stainless steel and is wall mounted.

Dimensions: W 92 mm x H 465 mm x D 90 mm

- 13422LAM Cup holder, lacquered, antimicrobial
- 13422WAM Cup holder, white, antimicrobial



PAPER TOWEL DISPENSERS, TOILET PAPER HOLDERS, TOILET BRUSH HOLDER

Paper towel dispensers

RST Line paper towel dispensers

The RST Line product range is made of brushed stainless steel, with an anti-microbial lacquer or colouring.

Dimensions: W 270 mm x H 350 mm x D 110 mm

- 1304LAM RST Line paper towel dispenser, lockable, lacquered stainless steel, antimicrobial
- 1304WAM RST Line paper towel dispenser, lockable, white, antimicrobial
- 1305LAM RST Line paper towel dispenser, without lock, lacquered stainless steel, antimicrobial
- 1305WAM RST Line paper towel dispenser, without lock, white, antimicrobial

Permits use of a smaller paper towel size.

- 13045LAM RST Line dispenser re-sizer piece, lacquered stainless steel, antimicrobial
- 13045WAM RST Line dispenser re-sizer piece, white, antimicrobial

Katrin paper towel dispensers

- 1543 Katrin paper towel dispenser, W 275 mm x H 330 mm x D 132 mm, white steel, lockable.
- 90168 Katrin paper towel dispenser Inclusive, W 301 mm x H 450 mm x D 146 mm, white plastic, lockable
- 92063 Katrin Inclusive, L 301 mm x K 450 mm x S 146 mm, lockable, black plastic
- 90045 Katrin paper roll dispenser, W 335 mm x H 403 mm x D 216 mm, white plastic, lockable
- 92025 Katrin paper roll dispenser, W 335 mm x H 403 mm x D 216 mm, black plastic, lockable

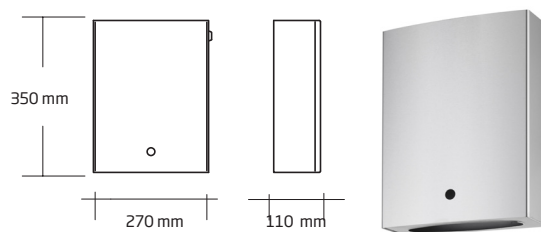

1304LAM



13045LAM



1543



92063



90168



92025



90045



1301LAM



1302LAM



104605



104582



1550



997016



1905



1920



6138.0



6110.0



6431.0

Toilet paper dispenser

RST Line toilet paper dispenser

RST Line toilet paper dispenser with capacity for two rolls. Lacquered stainless steel, with antimicrobial properties.

Dimensions: with 2 rolls W 135 mm x H 290 mm x D 110 mm
with 3 rolls, W 135 mm x H 400 mm x D 110 mm

- 1301LAM RST Line toilet paper dispenser, lockable, lacquered stainless steel, with capacity for 2 rolls, antimicrobial
- 1302LAM RST Line toilet paper dispenser, lockable, lacquered stainless steel, with capacity for 3 rolls, antimicrobial
- 1302WAM RST Line toilet paper dispenser, lockable, white, with capacity for 3 rolls, antimicrobial
- 1303LAM RST Line toilet paper dispenser, without lock, lacquered stainless steel with capacity for 3 rolls, antimicrobial
- 1303WAM RST Line toilet paper dispenser, without lock, white, with capacity for 3 rolls, antimicrobial

Katrin toilet paper dispenser

- 1550 Katrin toilet paper dispenser, lockable, with capacity for 3 rolls, white stainless steel, W 130 x H 390 mm
- 104582 Katrin toilet paper dispenser, lockable, with capacity for 2 rolls, white plastic, W 154 x H 313 mm x D 157
- 104605 Katrin toilet paper dispenser, lockable, with capacity for 2 rolls, black plastic, W 154 x H 313 mm x D 157
- 997016 Katrin Gigant toilet paper dispenser, lockable, with capacity for max ø 320 mm jumbo rolls, white roll, W 310 x H 330 x D 129 mm

Toilet paper holder, 1 roll

- 1905 Toilet paper holder made of white painted aluminium.
- 1920 Toilet paper holder made of silver painted aluminium.
- 6138.0 Toilet paper holder with cover, chrome-plated, W 160 mm x H 145 mm x D 50 mm
- 6431.0 Toilet paper holder with cover, chrome-plated, W 140 mm x H 15 mm x D 70 mm
- 6110.0 Spare toilet paper holder, chrome-plated, W 192 mm x H 65 mm x D 90 mm

Toilet brush holder

RST Line toilet brush holder

Dimensions: W 105 mm x H 250 mm x D 100 mm

1309 RST Line toilet brush holder, stainless steel

1309WAM RST Line toilet brush holder, white, antimicrobial

Brush sold separately.

Toilet brush holder

Dimensions: W 145 mm x H 454 mm x D 160 mm

13091 Suitable for 40 cm brush, with metal frame and removable cup, stainless steel

13092 Suitable for 53 cm brush, with metal frame and removable cup, stainless steel

Brush sold separately.

Toilet brush

335 Toilet brush, 40 cm, white, plastic

340 Toilet brush, 40 cm, white, plastic, cup withstands disinfection washing.



1309



1309WAM



13091

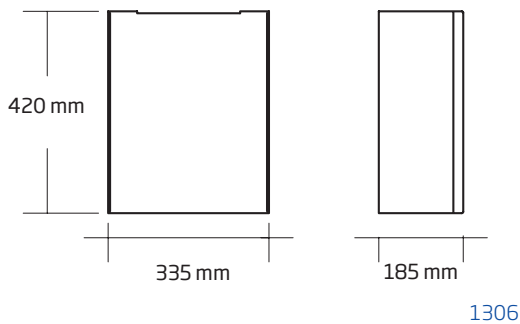

DUSTBINS

Wall mounted waste bins

Wall-mounted waste bins are available in a variety of models of different shape and capacity. Colour options include stainless steel and white, both of which have antimicrobial qualities. The RST Line waste bins include a frame for a rubbish bag, which eases switching bags and keeps the bag edges hidden.

Dimensions: W 335 mm x H 420 mm x D 185 mm

1320LAM RST Line rubbish bag holder, capacity of 25 l, without a lid, antimicrobial stainless steel.

1321LAM RST Line rubbish bag holder, capacity of 25 l, with a lid antimicrobial stainless steel.

1320WAM RST Line rubbish bag holder, capacity of 25 l, without a lid, white painted antimicrobial stainless steel

1321WAM RST Line rubbish bag holder, capacity of 25 l, with a lid white painted antimicrobial stainless steel.

Dimensions: W 280 mm x H 330 mm x D 185 mm

1319LAM RST Line rubbish bag holder, capacity of 15 l, with a lid, antimicrobial stainless steel

Dimensions: W 267 mm x H 315 mm x D 167 mm

1878LAM Semicircular dustbin, capacity of 10 l, without a lid, antimicrobial stainless steel.

1873LAM Semicircular dustbin, capacity of 10 l, with a lid, antimicrobial stainless steel

1874WAM Semicircular dustbin, capacity of 10 l, without a lid, white painted antimicrobial stainless steel

1875WAM Semicircular dustbin, capacity of 10 l, with a lid, white painted antimicrobial stainless steel.

Dimensions: W 342 mm x H 370 mm x D 200 mm

1880WAM Semicircular dustbin, capacity of 20 l, without a lid, white painted antimicrobial stainless steel

1881WAM Semicircular dustbin, capacity of 20 l, with a lid, white painted antimicrobial stainless steel

Trash bag holder

1871 is a rubbish bag holder made of white epoxy-covered steel wires. The wall-mounted bin has a capacity for a 20 l bag.

Dimensions: W 287 mm x H 360 mm x D 170 mm

1871 Steel wire basket, white

1872 Wire basket lid, white

1882N is a wired waste basket made of stainless steel wiring. Capacity for a 30 l rubbish bag. Either directly wall-mounted or via a separate installation rail.

Dimensions: W 340 mm x H 500 mm x D 255 mm

1882N Wired waste basket, stainless steel wiring, without a lid

1882-1LAM Rubbish bag lid, stainless steel, antimicrobial

Katrin waste bins

The free-standing floor model can alternatively be wall-mounted.

- 91899 Katrin wastebin, capacity of 25 l, white plastic
W 330 x H 550 x D 230 mm
- 92261 Katrin waste bin, capacity of 25 l, black plastic
W 330 x H 550 x D 230 mm
- 91912 Katrin dustbin with a lid, capacity of 50 l, white plastic
W 420 x H 575 x D 280 mm
- 92285 Katrin dustbin with a lid, capacity of 50 l, black plastic
W 420 x H 575 x D 280 mm

Wesco pedal dustbins

- 117 212-01 Wesco 117, capacity of 13 l, white steel, H 410 mm, Ø 270 mm
- 117 214-41 Wesco 117, capacity of 13 l, stainless steel, H 410 mm,
Ø 270 mm

Bobrick wall-mounted waste bin

- 5057 Bobrick wall-mounted waste bin is especially designed to hold
hygienic products, capacity of 3.8 l, W 190 x H 255 x D 95 mm

Wesco paper bin

Dimensions: H 355 mm, Ø 255 mm

- 166 404-47 Wesco 166, paper bin, stainless steel, capacity 19 l



91899



92261



91912



92285



117 214-41



117 212-01



5057



166 404-47



1310



1901



1915N



1902



1916



1903



1907



1908



1926



1932

HOOKS FOR TEXTILE GOODS

RST Line hook

The hook has hidden wall mounting.

Dimensions: Length: 55 mm, Ø 25 mm

1310 RST Line hook, stainless steel

Towel hooks and towel racks

Dimensions: W 15 mm x H 65 mm x D 55 mm

1901 1 hook, aluminium/white

1915N 1 hook, aluminium/silver

Dimensions: W 92 mm x H 40 mm x D 45 mm

1902 2 hooks, aluminium/white

1916 2 hooks, aluminium/silver

Dimensions: W 215 mm x H 45 mm x D 50 mm

1903 4 hooks, aluminium/white

1917 4 hooks, aluminium/silver

Double hook

Dimensions: W 56 mm x H 56 mm x D 76 mm

1907 Clothing hook, white steel

1907N Clothing hook, white aluminium
(suitable for swimming pool environments)

1908 Clothing hook, chrome-plated steel

Dimensions: W 125 x H 130 x D 65 mm

1926 Double hook for clothing storage, white

1927 Double hook for clothing storage, silver

1932 Double hook for clothing storage, white

1933 Double hook for clothing storage, chrome

TOOL HOLDERS AND DRYING RACKS

VT-45 and VT-90

VT-45 and VT-90 utensil holders are made of aluminium with rubber gripping surfaces.

1511 VT-45, W 450 mm

1512 VT-90, W 900 mm

TOOLFLEX holders

TOOLFLEX racks are mountable to walls and furniture. The rack holds walking sticks, crutches and mops or other cleaning supplies.

1509 Suitable for Ø 20-30 mm, white

1510 Suitable for Ø 20-30 mm, black

1555 TOOLFLEX aluminium rail, width 500 mm, Includes 3 holders

1556 TOOLFLEX aluminium rail, width 900 mm, Includes 5 holders

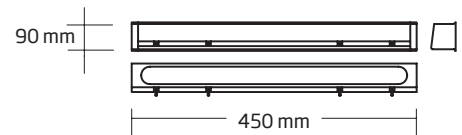

1511

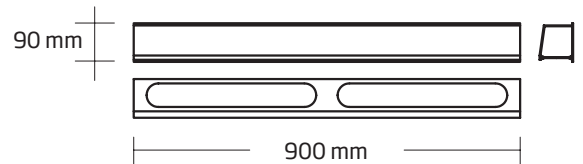

1512

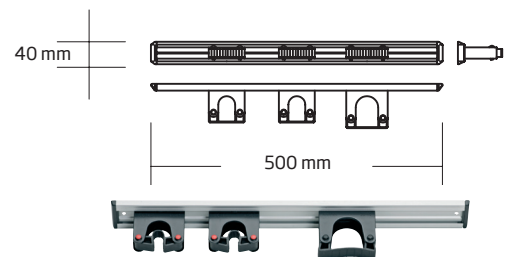

1555

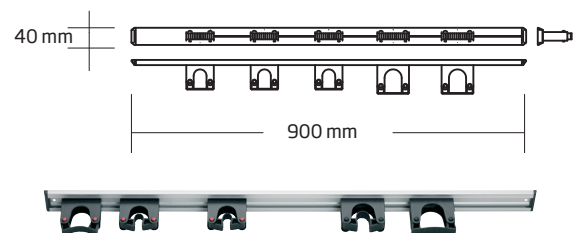

1556

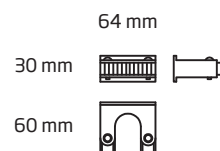

1509



1509



1510



9599

Glove box holder

Glove box holder, wire rack

- 9598 Glove box holder, capacity of two boxes
- 95981 Glove box holder, capacity of two boxes, rst
- 9594 Glove box holder, capacity of three boxes
W 185 mm x H 555 mm x D 118 mm
- 9599 Glove box holder, capacity of three boxes
W 260 mm x H 455 mm x D 87 mm
- 9593 Glove box and apron holder
- 9592 Glove box holder, capacity of 4 boxes



1931

Vacuum tube holder

- 1931 Wired rack for tubing of central vacuum or other appliances,
white metal. W 430 mm x H 180 mm x D 150 mm
- 1935 Rack houses a single hose, white plastic,
W 120 mm x H 105 mm x D 105 mm

DRYING RACKS

Accordion drying rack

The accordion model of drying rack is made of stainless steel and has a load-bearing capacity of 11 kg. Folded up, the rack has a depth of 75 mm, but folds open to 620 mm. Rack height is 182 mm.

- 1517 Accordion drying rack, W 500 mm, stainless steel
- 1516 Accordion drying rack, W 600 mm, stainless steel



1935

Drying rack

The drying rack with rods is made of white painted steel.

- 63290 Drying rack with 5 rods, W 540 mm, H 260 mm
- 63292 Drying rack with 10 rods, W 540 mm, H 260 mm

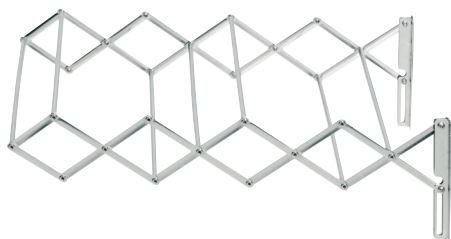

1517

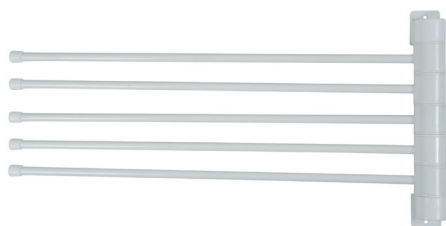

63290

SOAP BASKETS, TRAYS AND MEDICINE CABINET

Soap baskets

Soap trays are made of high-quality chromed brass. Mounting hardware is included.

- 6064.0 Small corner wire basket,
W 220 mm x H 90 mm x D 170 mm, chromed
- 6035.0 Large corner wire basket
W 320 mm x H 40 mm x D 200 mm
- 6079.0 Large corner wire basket ,
W 320 mm x H 90 mm x D 250 mm, chromed
- 6077.0 Small basket for soaps
W 200 mm x H 110 mm x D 90 mm
- 1922 Small basket for soaps,
W 200 mm x H 40 x D 110 mm
- 1921 Large basket for soaps,
W 290 mm x H 50 x D 130 mm
- 6085 Soap basket,
W 290 mm x H 92 mm x S D 30 mm, chromed
- 1928 Large detergent basket for support rails,
W 295 x H 150 x D 130 mm + mounting hook 200 m, chromed
- 1311 RST Line shelf for soap products,
W 180 mm x H 100 mm x D 20 mm, stainless steel

Medicine cabinet

Dimensions: W 330 mm x H 400 mm x D 130 mm

- 77020 Medicine cabinet, metal, white



6035.0



6064.0

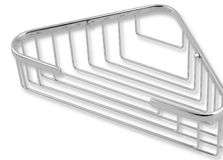

6079.0



6077.0



1922



1921



1928

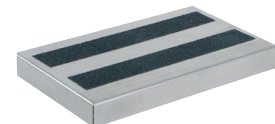

1311



77020

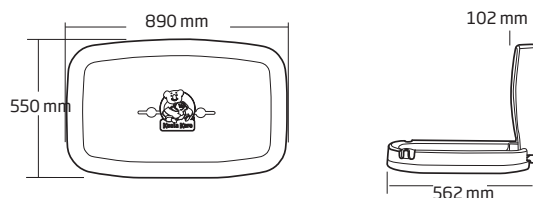

KB200-01



KB200-01SS



KB101-01-INB

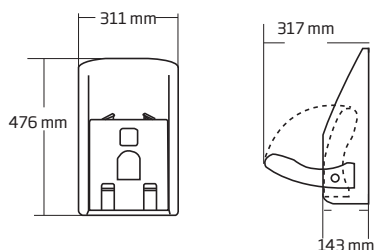

KB 102-01-INB

BABY CARE

Baby changing station

The wall-mounted baby changing station provides a safe and steady surface for baby care. The concave base and seat belt prevent falling. Load-bearing capacity of 15 kg. The spring mechanism allows for easy and smooth opening and closing of the base board.

The base also has a built-in disposable protective paper dispenser, sold separately.

Mounting hardware is included. The design of the hinges eliminates the threat of fingers getting stuck. The station is made of polyethylene plastic which repels odours and bacteria. The closed structure also facilitates cleanliness.

Dimensions:

- Closed; W 890 mm x H 550 mm x D 102 mm
- Depth when opened 520 mm

KB200-01	Baby changing station, grey
KB200-01SS	Baby changing station, grey, stainless steel, front panel
KB101-01-INB	Baby changing station, grey, vertical

Child protection seat

The foldable child protection seat is made of polyethylene plastic which rejects odours and bacteria.

The wall-mounted seat has hidden wall mountings for the entire width of the seat. The seat has nylon seat belts. Load-bearing capacity of 22 kg when installed correctly.

Dimensions::

- Closed; W 476 mm x H 311 mm x D 143 mm
- Depth when opened 317 mm

KB 102-01-INB	Child protection seat, grey
---------------	-----------------------------

Additional equipment:

KB150-99 Protective paper for baby changing stations, 500 pcs per box

TOILET SEATS AND ADDITIONAL EQUIPMENT

Duo electrically adjustable toilet seat

The Duo electrically adjustable toilet seat is made of antimicrobial stainless steel. The petite design of the Duo is coupled with power to lift up to a 200 kg load.

The variety of potential configurations of the seat makes it functional for residents and personnel. Electrical or manual height adjustment range 200 mm.

The seat is customisable with integrated support rails with antimicrobial elastomeric gripping surfaces. Additional customisation regarding the depth of the toilet seat, available in 500 and 710 mm.

Duo electrically adjustable toilet seat

Dimensions: W 550 mm x H 1113 / 1313 mm x D 206 mm

17751N	Duo electrically adjustable toilet seat
17771	Duo case for the electrically adjustable toilet seat. The case does not have height adjustability.
17778	Duo controller rack

Duo Regal support rail pair

Regal support rails specifically designed for the Duo toilet seat system. Side mounting.

330001GAM	Support rail pair 770 mm, side-mounted, grey
330001RAM	Support rail pair 770 mm, side-mounted, red
330003GAM	Support rail pair 870 mm, side-mounted, grey
330003RAM	Support rail pair 870 mm, side-mounted, red

V&B toilet seat O.novo

8008	V&B toilet seat O.novo DirectFlush, D 560 mm, wall mounting
8008-1	Toilet seat cover O.novo, white, hard
8008-2	Toilet seat cover O.novo, white, hard, soft close

V&B toilet seat O.novo Vita

8010	V&B toilet seat O.novo Vita DirectFlush, 700 mm, with wall mounting
8010-1	Toilet seat cover O.novo Vita, white
8010-2	Toilet seat cover O.novo Vita, blue, AntiBac
8014	V&B Architectura Vita, 700 mm, Anti-Bac, wall mounting
8015	V&B Architectura Vita, 700 mm, wall mounting
8014-1	V&B, Architectura Vita toilet seat cover, white, soft close
8016	V&B Architectura Vita toilet seat, 530 mm, wall mounting
8016-1	V&B Architectura Vita toilet seat cover, 530 mm, white, soft close
8012	V&B electrically toilet seat ViClean-L 560 mm (wash)
8013	V&B electrically toilet seat ViClean-L 560 mm (wash and drying)



DUO electrically adjustable toilet seat



17771

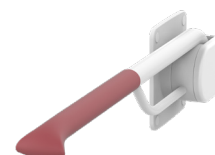

8008



8010

gais

KORPINEN